

# Gatton Shire Cultural Heritage Study

## Vol 2 Grantham Helidon

A report for  
Gatton Shire Council  
by  
Buchanan Architects

December 2000



# GRANTHAM

House, Armstrong Rd (cnr Helidon-Gatton Rd)	222
House – Former Shopfront for Saddlery, 3 Harris St Grantham	224
Business premises, 2 Harris St Grantham	226
Business premises, 7 Gatton-Helidon Rd	228
Business premises, 8 Harris St Grantham	230
Trees along William St, Grantham	232
Business premises, 6 William St Grantham	234
Grantham State School and residence, Victor Street Grantham	236
St Gabriel's Anglican Church, 12-14 Victor St Grantham	240
House, 22 Victor St Grantham	242
Former Grantham Butter Factory (The Queensland Farmers Cooperative Dairy Association Ltd), 6 Victor St Grantham	244
Former overbridge at Toowoomba Railway Station, Over Sandy Creek, off Ditchman's Road Grantham	248
"Summit", 9 Christopher St Grantham	250
Farmhouse, 608 Lawlers Rd Grantham	252
Grantham signal cabin, off Railway St Grantham	254
Grantham Town Precinct	256

NOTE: This report has been prepared on the basis of evidence examined by the study team and seeks to identify the most important heritage values of the item. The purpose of this report is to provide an initial evaluation. If any action is planned which might affect the cultural heritage significance of this place, advice should be sought through the Gatton Shire Council Planning Branch.

NAME	-
CATEGORY	House
LOCATION	Armstrong Rd (cnr Helidon-Gatton Rd)
RPD	25RP25736
LISTING BOUNDARY	House site
OTHER LISTINGS	-
SIGNIFICANCE LEVEL	Local

**History:****Description:**

- Short ridge pyramid bungalow with 3 sides incorporated verandah and a north-west side gable.
- Weatherboard clad
- Half-hip roof to rear
- Prominent roadside position
- Open front verandah with two-rail timber slat balustrade
- Enclosed left-hand side verandah
- Timber stairs front and side, each with a gabled porch
- Colonial sash windows generally feature tripartite sash on gable elevation with skillion window hood
- High set on timber stumps, arched sub-floor timber valance

**Significance:**

Important for its demonstration of early form and materials and for its demonstration of early building techniques.

The house has a prominent corner position and contributes aesthetically to the streetscape/rural landscape.

**Associated Items:****References:****Comments:.**

NOTE: This report has been prepared on the basis of evidence examined by the study team and seeks to identify the most important heritage values of the item. The purpose of this report is to provide an initial evaluation. If any action is planned which might affect the cultural heritage significance of this place, advice should be sought through the Gatton Shire Council Planning Branch.



View from main road

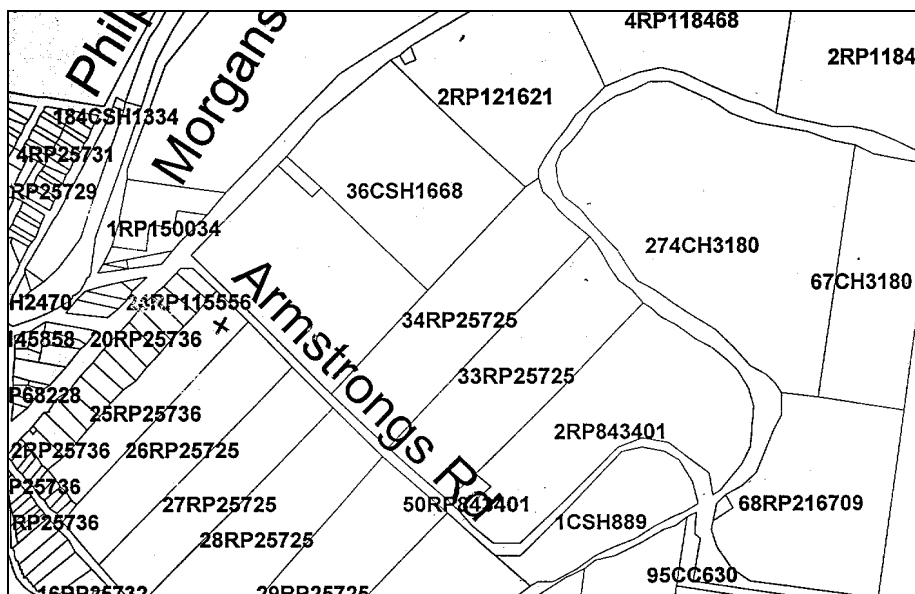

NOTE: This report has been prepared on the basis of evidence examined by the study team and seeks to identify the most important heritage values of the item. The purpose of this report is to provide an initial evaluation. If any action is planned which might affect the cultural heritage significance of this place, advice should be sought through the Gatton Shire Council Planning Branch.



NAME	-
CATEGORY	House – Former Shopfront for Saddlery
LOCATION	3 Harris St Grantham
RPD	7RP25735
LISTING BOUNDARY	Whole Site
OTHER LISTINGS	-
SIGNIFICANCE LEVEL	Recorded

**History:**

- Currently occupied as a residence.

**Description:**

- Gable ended pitched roof with side verandah and sheet metal parapet shop front to street.
- Front elevation fibro clad with aluminium framed windows and French door.
- Remainder of the building is weatherboard clad.
- Low-set on brick piers.

**Significance:**

The building is recorded for the evidence it contains of the traditional form, detailing and materials of a small shop.

It is also recorded as a demonstration of the history of commercial activity in the Grantham community.

**Associated Items:****References:****Comments:**

NOTE: This report has been prepared on the basis of evidence examined by the study team and seeks to identify the most important heritage values of the item. The purpose of this report is to provide an initial evaluation. If any action is planned which might affect the cultural heritage significance of this place, advice should be sought through the Gatton Shire Council Planning Branch.

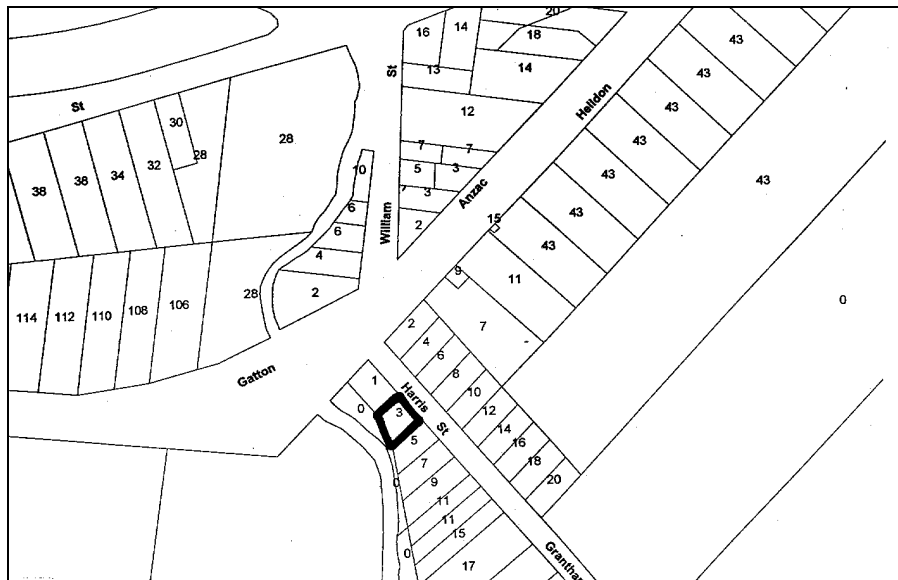

NOTE: This report has been prepared on the basis of evidence examined by the study team and seeks to identify the most important heritage values of the item. The purpose of this report is to provide an initial evaluation. If any action is planned which might affect the cultural heritage significance of this place, advice should be sought through the Gatton Shire Council Planning Branch.

NAME	
CATEGORY	Business
LOCATION	2 Harris St Grantham
RPD	10RP25736
LISTING BOUNDARY	Whole site
OTHER LISTINGS	-
SIGNIFICANCE LEVEL	Local

**History:**

- Previously operated as a general store

**Description:**

- Gable ended pitched roof building with side and front verandah, the front used as a street awning.
- Fibro parapet to Gatton Helidon Road.
- Located on prominent corner in Grantham.
- Currently operating as an antique shop.

**Significance:**

The building is important for the evidence it contains of the traditional form, detailing and materials of a small shop.

It is important as a demonstration of the history of commercial activity in the Gatton community.

**Associated Items:**

This building relates to the William St precinct

**References:**

Historic information by owner of "Foyles Restoration" located across the road.

**Comments:**

NOTE: This report has been prepared on the basis of evidence examined by the study team and seeks to identify the most important heritage values of the item. The purpose of this report is to provide an initial evaluation. If any action is planned which might affect the cultural heritage significance of this place, advice should be sought through the Gatton Shire Council Planning Branch.



NOTE: This report has been prepared on the basis of evidence examined by the study team and seeks to identify the most important heritage values of the item. The purpose of this report is to provide an initial evaluation. If any action is planned which might affect the cultural heritage significance of this place, advice should be sought through the Gatton Shire Council Planning Branch.

NAME	
CATEGORY	business
LOCATION	7 Gatton-Helidon Rd
RPD	4RP108240
LISTING BOUNDARY	Whole site
OTHER LISTINGS	-
SIGNIFICANCE LEVEL	Recorded

**History:** Faded signwriting on the building indicates it once sold oil, grease and produce

**Description:** Corrugated iron premises in two section. The left hand section contains a large doorway; the right hand side has a door and window.  
Rudimentary parapet decoration on right-hand section.

**Significance:**

The building is recorded for the evidence it contains of the traditional form, detailing and materials of a small shop/business premises.

It is also recorded as a demonstration of the history of commercial activity in the Grantham community.

**Associated Items:** This area relates to the William St precinct

**References:**

**Comments:**

NOTE: This report has been prepared on the basis of evidence examined by the study team and seeks to identify the most important heritage values of the item. The purpose of this report is to provide an initial evaluation. If any action is planned which might affect the cultural heritage significance of this place, advice should be sought through the Gatton Shire Council Planning Branch.



*Premises on left*



*Premises on No 7, adjacent to corner shop*

NOTE: This report has been prepared on the basis of evidence examined by the study team and seeks to identify the most important heritage values of the item. The purpose of this report is to provide an initial evaluation. If any action is planned which might affect the cultural heritage significance of this place, advice should be sought through the Gatton Shire Council Planning Branch.

NAME	-
CATEGORY	Business premises
LOCATION	8 Harris St Grantham
RPD	7RP25736
LISTING BOUNDARY	Whole site
OTHER LISTINGS	-
SIGNIFICANCE LEVEL	Local

**History:****Description:**

- Gable ended pitched roof with stepped weatherboard parapet facing street.
- Bullnose street awning with timber infill and posts.
- The side elevations are weatherboard clad and have 2 high venting windows with curved window hoods.
- The front elevation is mostly timber framed shop front windows with a recessed, angled central entry.
- French doors to the entry and fanlight over.
- Thought to be currently occupied as a residence.

**Significance:**

The building is important for the evidence it contains of the traditional form, detailing and materials of a small shop and for its contribution to the streetscape.

It is important as a demonstration of the history of commercial activity in the Gatton community.

**Associated Items:****References:****Comments:**

NOTE: This report has been prepared on the basis of evidence examined by the study team and seeks to identify the most important heritage values of the item. The purpose of this report is to provide an initial evaluation. If any action is planned which might affect the cultural heritage significance of this place, advice should be sought through the Gatton Shire Council Planning Branch.





NOTE: This report has been prepared on the basis of evidence examined by the study team and seeks to identify the most important heritage values of the item. The purpose of this report is to provide an initial evaluation. If any action is planned which might affect the cultural heritage significance of this place, advice should be sought through the Gatton Shire Council Planning Branch.

NAME	
CATEGORY	Trees
LOCATION	Along William St, Grantham
RPD	N/a
LISTING BOUNDARY	Immediate area
OTHER LISTINGS	-
SIGNIFICANCE LEVEL	Local

**History:****Description:**

An avenue of camphor laurel trees leading from the station to the main street of the township.

**Significance:**

Important for the contribution they make to the streetscape

**Associated Items:**

Part of precinct.

**References:****Comments:**

NOTE: This report has been prepared on the basis of evidence examined by the study team and seeks to identify the most important heritage values of the item. The purpose of this report is to provide an initial evaluation. If any action is planned which might affect the cultural heritage significance of this place, advice should be sought through the Gatton Shire Council Planning Branch.



NAME	Foyle's Restoration
CATEGORY	Business premises
LOCATION	6 William St Grantham
RPD	1RP91609
LISTING BOUNDARY	Whole site
OTHER LISTINGS	-
SIGNIFICANCE LEVEL	Local

**History:**

- Current owners have operated this business for the last 5-6 years.
- Prior to this the building was a butcher's shop and evidence of this remains internally, (a concrete floor section.)
- Before the butcher's the building was a general store and petrol supplier. The petrol pump has been removed and stored.

**Description:**

- Gable ended pitched roof building with fibro parapet and skillion street awning.
- Chamfer board cladding to dado and fibro with cover strips over to side elevations.
- Front elevation mostly timber framed glass shop-front windows with a recessed, angled central entry.
- Internally the ceiling lining (tongue and groove boards) follows the pitch of the roof up to the collar tie.
- Stop chamfered timber posts and corner brackets to street awning.
- Prominent corner position on William Street.

**Significance:**

The building is important for the evidence it contains of the traditional form, detailing and materials of a small shop.

It is important as a demonstration of the history of commercial activity in the Gatton community and for its contribution to the streetscape.

**Associated Items:**

Part of precinct

**References:****Comments:**

NOTE: This report has been prepared on the basis of evidence examined by the study team and seeks to identify the most important heritage values of the item. The purpose of this report is to provide an initial evaluation. If any action is planned which might affect the cultural heritage significance of this place, advice should be sought through the Gatton Shire Council Planning Branch.



NAME	Grantham State School
CATEGORY	School and residence
LOCATION	Victor Street Grantham
RPD	40CSH1334
LISTING BOUNDARY	Whole site
OTHER LISTINGS	-
SIGNIFICANCE LEVEL	Local

**History:**

- Opened in 1905 (date noted on a plaque in the entry foyer)
- 1914 –1918 Honour Board in the entry foyer.
- The site was extended and a new school building was erected in 1916-17.

**Description:**School

- Typical school building, gable ended with a pitched roof and slatted gable infill.
- Bank of timber framed windows under a large skillion awning on each gable end.
- Verandahs on each side have been enclosed with weatherboards.
- Ornate roof ventilator is no longer evident.
- Internally the ceilings are ornate pressed metal and in excellent condition.
- This main core is currently being used as the school office.
- Rear half hipped extension houses classrooms, c1950s.

Residence

- C1905, Short ridge pyramid roof bungalow with incorporated front verandah and rear half hip.
- Weatherboard clad with sash windows (no Hoods evident)
- Two-rail slatted balustrade with paired posts beside central entry stair.
- High-set on timber stumps and ant caps with batten infill.

**Significance:**

Significant as an example of an early country town school.

Important for its association with the educational and social life of the local community over a long period.

The World War I Honour Board is a significant memorial,

**Associated Items:****References:****Comments:**

NOTE: This report has been prepared on the basis of evidence examined by the study team and seeks to identify the most important heritage values of the item. The purpose of this report is to provide an initial evaluation. If any action is planned which might affect the cultural heritage significance of this place, advice should be sought through the Gatton Shire Council Planning Branch.





*Photo taken shortly after opening*

NOTE: This report has been prepared on the basis of evidence examined by the study team and seeks to identify the most important heritage values of the item. The purpose of this report is to provide an initial evaluation. If any action is planned which might affect the cultural heritage significance of this place, advice should be sought through the Gatton Shire Council Planning Branch.



NOTE: This report has been prepared on the basis of evidence examined by the study team and seeks to identify the most important heritage values of the item. The purpose of this report is to provide an initial evaluation. If any action is planned which might affect the cultural heritage significance of this place, advice should be sought through the Gatton Shire Council Planning Branch.



Residence



NOTE: This report has been prepared on the basis of evidence examined by the study team and seeks to identify the most important heritage values of the item. The purpose of this report is to provide an initial evaluation. If any action is planned which might affect the cultural heritage significance of this place, advice should be sought through the Gatton Shire Council Planning Branch.

NAME	St Gabriel's Anglican Church, Grantham
CATEGORY	Church
LOCATION	12-14 Victor St Grantham
RPD	1RP25729 and 2RP25729
LISTING BOUNDARY	Whole of site
OTHER LISTINGS	-
SIGNIFICANCE LEVEL	local

**History:****Description:**

- Gable ended pitched roof with rectangular plan.
- Octagonal Sanctuary at street frontage.
- Rear side gabled porch entry
- Plain 4 light casement windows of patterned glass.
- Label moulds over windows along side elevations.
- Weatherboard clad.

**Significance:**

Significant as a good example of a simple church in a country town.

It is important in exhibiting a range of aesthetic characteristics valued by the local community, in particular the building's traditional form, scale and materials.

Important for its contribution to the streetscape.

It has a strong association with the spiritual and social life of the surrounding community.

**Associated Items:****References:****Comments:**

NOTE: This report has been prepared on the basis of evidence examined by the study team and seeks to identify the most important heritage values of the item. The purpose of this report is to provide an initial evaluation. If any action is planned which might affect the cultural heritage significance of this place, advice should be sought through the Gatton Shire Council Planning Branch.

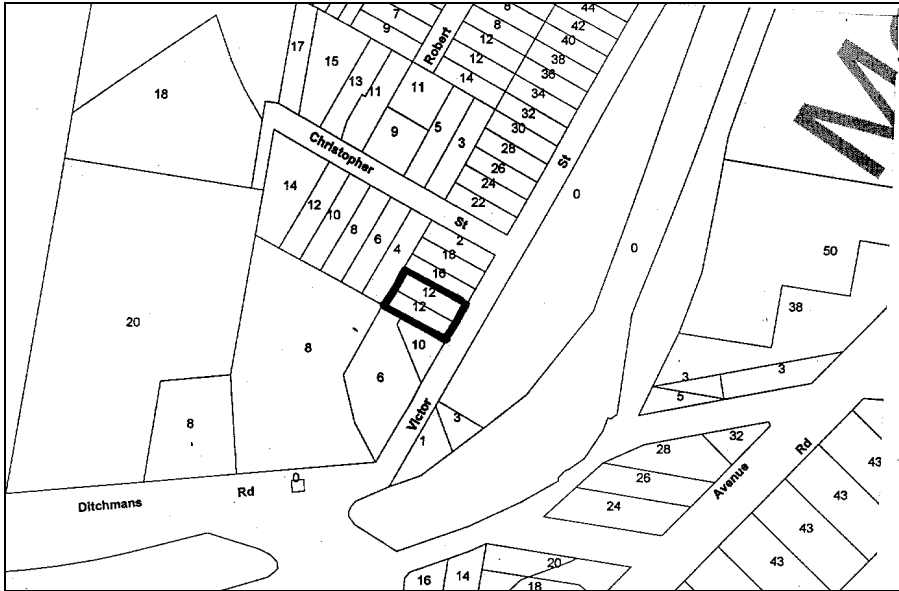

NOTE: This report has been prepared on the basis of evidence examined by the study team and seeks to identify the most important heritage values of the item. The purpose of this report is to provide an initial evaluation. If any action is planned which might affect the cultural heritage significance of this place, advice should be sought through the Gatton Shire Council Planning Branch.

NAME	-
CATEGORY	House
LOCATION	22 Victor St Grantham
RPD	6RP25729
LISTING BOUNDARY	Whole site
OTHER LISTINGS	-
SIGNIFICANCE LEVEL	Local

**History:****Description:**

- short ridge pyramid roof with stepped front curved verandah and rear skillion verandah.
- Two-rail dowel balustrade with iron lace feature panel.
- Paired posts beside central entry stair.
- Single skin construction, exposed studs and horizontal lapped boards lining.
- Ornate tin window hoods
- Original sash windows and front door.
- Tank and timber stand at side rear.
- Corner position overlooking school.

**Significance:**

Important for its demonstration of aesthetic characteristics and building techniques typical of the late 19<sup>th</sup>/early 20<sup>th</sup> century.

It contributes aesthetically to the streetscape.

**Associated Items:****References:****Comments:**

NOTE: This report has been prepared on the basis of evidence examined by the study team and seeks to identify the most important heritage values of the item. The purpose of this report is to provide an initial evaluation. If any action is planned which might affect the cultural heritage significance of this place, advice should be sought through the Gatton Shire Council Planning Branch.



NOTE: This report has been prepared on the basis of evidence examined by the study team and seeks to identify the most important heritage values of the item. The purpose of this report is to provide an initial evaluation. If any action is planned which might affect the cultural heritage significance of this place, advice should be sought through the Gatton Shire Council Planning Branch.

NAME	Former Grantham Butter Factory The Queensland Farmers Cooperative Dairy Association Ltd
CATEGORY	Former Industrial site
LOCATION	6 Victor St Grantham
RPD	1RP189736
LISTING BOUNDARY	Whole of site
OTHER LISTINGS	-
SIGNIFICANCE LEVEL	Local

**History:**

The Queensland Farmers Co-operative Association opened a butter factory at Grantham in June 1907.

A foundation plaque on the current brick building shows a date of 1926 and lists the Directors of the Co-op at the time.

**Description:**

- Large double height saw-tooth roofed building.
- Constructed with expressed brick piers and brick infill.
- Right hand side skillion addition, currently used as a residence.
- Row of timber framed windows in the clerestory of each bay.
- Front elevation shows boarded over window openings with expressed lintels and large industrial roller door openings.
- Boiler and tall concrete chimney at rear.
- Some relationship to the William Street Avenue of trees as the building terminates the view along the street from the township.

**Significance:**

Important for its association with the dairy industry, one of the Shire's most important early industries.

It is a substantial building which demonstrates the typical form and materials of a dairy factory.

**Associated Items:****References:****Comments:**

NOTE: This report has been prepared on the basis of evidence examined by the study team and seeks to identify the most important heritage values of the item. The purpose of this report is to provide an initial evaluation. If any action is planned which might affect the cultural heritage significance of this place, advice should be sought through the Gatton Shire Council Planning Branch.





NOTE: This report has been prepared on the basis of evidence examined by the study team and seeks to identify the most important heritage values of the item. The purpose of this report is to provide an initial evaluation. If any action is planned which might affect the cultural heritage significance of this place, advice should be sought through the Gatton Shire Council Planning Branch.

NOTE: This report has been prepared on the basis of evidence examined by the study team and seeks to identify the most important heritage values of the item. The purpose of this report is to provide an initial evaluation. If any action is planned which might affect the cultural heritage significance of this place, advice should be sought through the Gatton Shire Council Planning Branch.



NAME	(Former overbridge at Toowoomba Railway Station)
CATEGORY	Pedestrian Overbridge
LOCATION	Over Sandy Creek, off Ditchman's Road Grantham
RPD	2RP189736
LISTING BOUNDARY	Footbridge site
OTHER LISTINGS	-
SIGNIFICANCE LEVEL	Local

**History:**

This footbridge was constructed at Toowoomba Railway Station in 1905.

It was dismantled by July 1985 and later relocated to this position.

**Description:**

- Wrought iron construction.
- Latticed balustrade
- Main balusters supported by decoratively curved brackets.
- Iron handrail

**Significance:**

Toowoomba Station is a building of State level of Significance. This footbridge would be of state significance at that site.

However it is of lesser significance in this site as it no longer has its original railway context.

**Associated Items:**

Located in the field adjacent to the former Grantham Butter Factory and spanning Lockyer creek (The Queensland Farmers Cooperative Dairy Association Ltd)

**References:**

QSA A/12364 file 6a plan no S2116  
Clive Gunton *Toowoomba Railway Station Conservation Plan* QR Architectural and Building Services Section

**Comments:** If this footbridge is not required at this location at some future time, it should be offered back to QR for Toowoomba Station before being disposed of in any other way.

NOTE: This report has been prepared on the basis of evidence examined by the study team and seeks to identify the most important heritage values of the item. The purpose of this report is to provide an initial evaluation. If any action is planned which might affect the cultural heritage significance of this place, advice should be sought through the Gatton Shire Council Planning Branch.

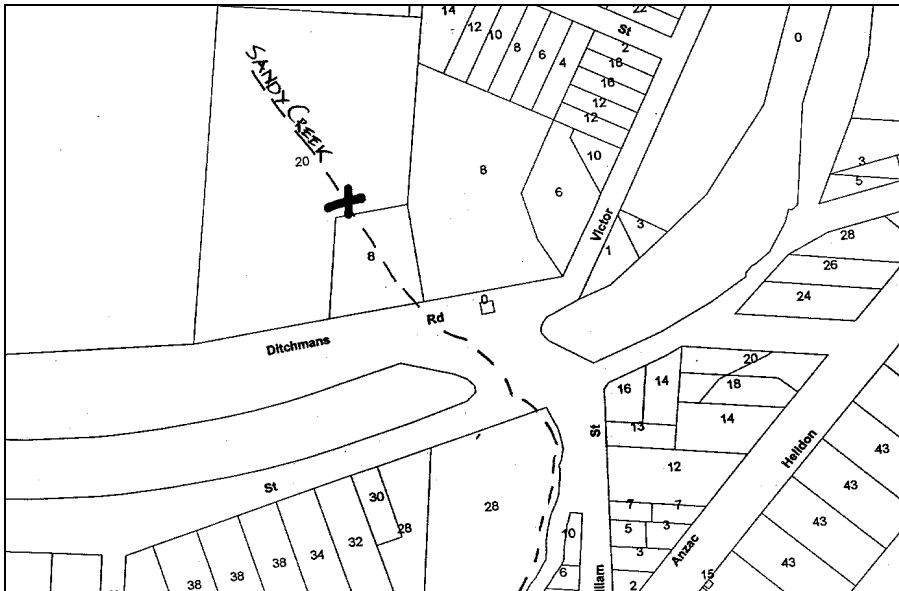

NOTE: This report has been prepared on the basis of evidence examined by the study team and seeks to identify the most important heritage values of the item. The purpose of this report is to provide an initial evaluation. If any action is planned which might affect the cultural heritage significance of this place, advice should be sought through the Gatton Shire Council Planning Branch.

NAME	"Summit"
CATEGORY	House
LOCATION	9 Christopher St Grantham
RPD	1RP172377
LISTING BOUNDARY	Whole site
OTHER LISTINGS	-
SIGNIFICANCE LEVEL	Local

**History:**

Has been relocated from a position at the base of the hill on which it now stands.

**Description:**

- C1910 style short ridge pyramid bungalow with incorporated verandahs on three sides.
- Single skin with belted vertical tongue and groove boards.
- French doors with fan lights opening to the verandah.
- Original sash windows with curved metal hoods to outer windows.
- Ladies waist handrail and dowel balustrade, stop chamfered posts ornate corner brackets and capitals to verandah.
- High-set and built-in under recently with new steel posts supporting the upper level.
- Located on the highest point (hill top) in the Grantham area.

**Significance:**

Important for its demonstration of aesthetic characteristics and building techniques typical of the early 20<sup>th</sup> century. It contributes aesthetically to the streetscape.

**Associated Items:****References:**

Historical information via current owners.

**Comments:**

NOTE: This report has been prepared on the basis of evidence examined by the study team and seeks to identify the most important heritage values of the item. The purpose of this report is to provide an initial evaluation. If any action is planned which might affect the cultural heritage significance of this place, advice should be sought through the Gatton Shire Council Planning Branch.



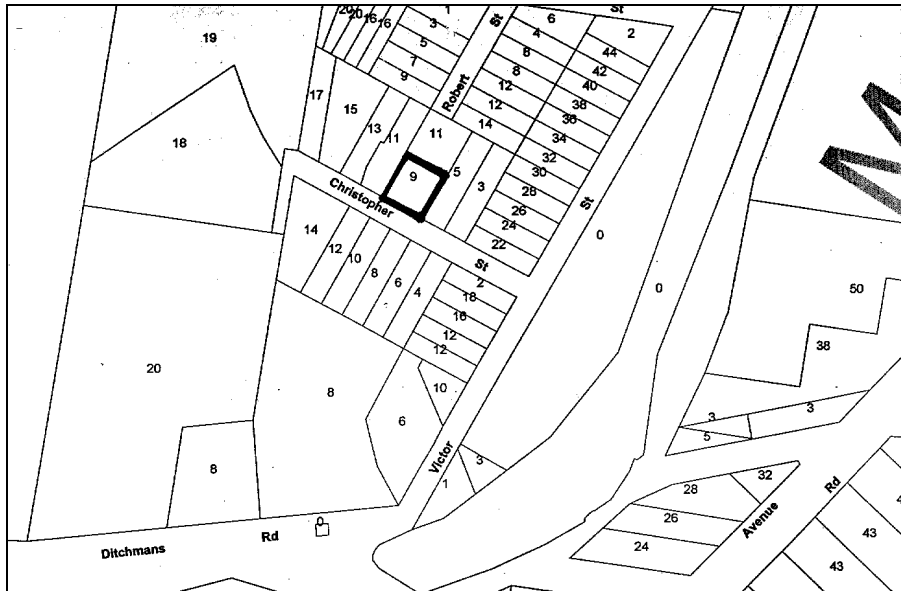

NOTE: This report has been prepared on the basis of evidence examined by the study team and seeks to identify the most important heritage values of the item. The purpose of this report is to provide an initial evaluation. If any action is planned which might affect the cultural heritage significance of this place, advice should be sought through the Gatton Shire Council Planning Branch.



NAME	-
CATEGORY	Farmhouse
LOCATION	608 Lawlers Rd Grantham
RPD	L138 CSH482
LISTING BOUNDARY	House and out building area
OTHER LISTINGS	-
SIGNIFICANCE LEVEL	House local; outbuildings recorded

**History:**

- Originally front and side verandahs and two-rail broomstick balustrade.
- Originally a dairy farm, currently not operating.

**Description:**

- C1890s style pyramid roof with stepped skillion verandahs.
- Single skin with exposed stud and cross bracing, vertical tongue and groove boards.
- Central entry stair
- Stop chamfered posts with capitals and corner brackets.
- Few original doors and windows.
- Post and three rail fence around yard containing mature trees.
- Several outbuildings including a creamery, sheds and a barn.

**Significance:**

Important for its demonstration of aesthetic characteristics and building techniques typical of the late 19<sup>th</sup>/early 20<sup>th</sup> century, now becoming rare.

The house, with its surrounding trees/garden/farm buildings, contributes aesthetically to the rural landscape.

**Associated Places:****References:**

Historical information via current owner.

**Comments:**

NOTE: This report has been prepared on the basis of evidence examined by the study team and seeks to identify the most important heritage values of the item. The purpose of this report is to provide an initial evaluation. If any action is planned which might affect the cultural heritage significance of this place, advice should be sought through the Gatton Shire Council Planning Branch.

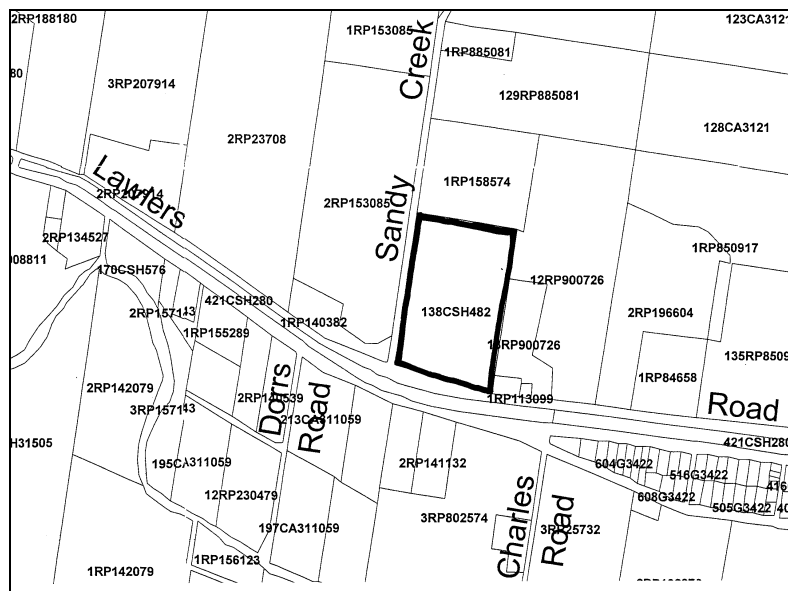

NOTE: This report has been prepared on the basis of evidence examined by the study team and seeks to identify the most important heritage values of the item. The purpose of this report is to provide an initial evaluation. If any action is planned which might affect the cultural heritage significance of this place, advice should be sought through the Gatton Shire Council Planning Branch.

NAME	Grantham signal cabin
CATEGORY	Railway building
LOCATION	Off Railway St Grantham
RPD	391M333225
LISTING BOUNDARY	Site of building
OTHER LISTINGS	-
SIGNIFICANCE LEVEL	Recorded

**History:** A halt was provided on the railway at Grantham in 1875. Over the next few years, a station master's house, shelter shed, goods shed and sheep yards were built. A station building was erected by R. Wilson & Co in 1899 and when the line was duplicated, an island platform and a new station were provided in 1912.

At its height, the station contained the station buildings, signal cabin, toilets, footbridge, goods shed, cream shed, 1 ton crane, 20 ton weighbridge, station master's house, gangers' residence, trucking yards.

From the late 1960s, the buildings have been gradually removed and the residences sold until little now remains except the signal cabin.

The Station building has been relocated to the Gatton & District Historical Society village.

**Description:**

Small gable-roofed lowset building, six-pane windows.  
It originally held a 12-lever T-bar Mackenzie and Holland frame

**Significance:**

Recorded for its association with the evolution of the railway system.

**Associated Items:**

**References:**

Andrew Ward *Queensland Railway Heritage Places Study: Stage 2* A report for Qld Dept of Environment and QR 1997

**Comments:**

NOTE: This report has been prepared on the basis of evidence examined by the study team and seeks to identify the most important heritage values of the item. The purpose of this report is to provide an initial evaluation. If any action is planned which might affect the cultural heritage significance of this place, advice should be sought through the Gatton Shire Council Planning Branch.

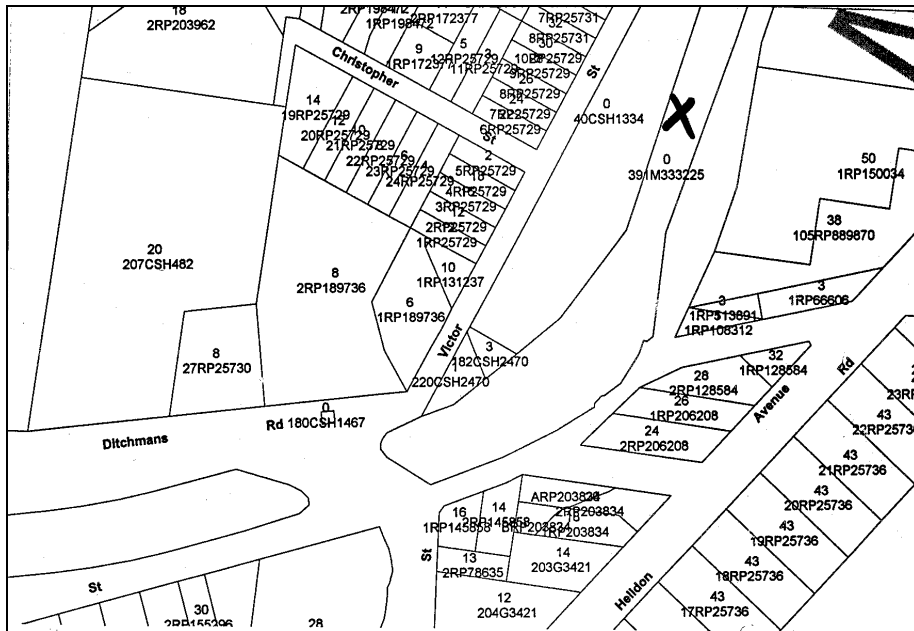

NOTE: This report has been prepared on the basis of evidence examined by the study team and seeks to identify the most important heritage values of the item. The purpose of this report is to provide an initial evaluation. If any action is planned which might affect the cultural heritage significance of this place, advice should be sought through the Gatton Shire Council Planning Branch.

NAME	Grantham Town Precinct
CATEGORY	Precinct
LOCATION	Central area of Grantham
RPD	Various
LISTING BOUNDARY	As shown
OTHER LISTINGS	-
SIGNIFICANCE LEVEL	Local

**History:**

**Description:** This area contains the central part of Grantham township, containing commercial buildings, the old butter factory, an avenue of trees and important vistas.

A number of places within this precinct are individually listed.

**Significance:**

This area is important for the evidence it contains of the early development of the town centre and there are elements surviving in this precinct which are evocative of its commercial enterprise and growth.

**Associated Items:****References:**

**Comments:** This area is a footprint of the historic centre of the township.

It will be important to try to retain the character of this area and prevent unsympathetic alterations and further erosion of its integrity. This does not mean that new buildings within this precinct should be replicas. New development and infill should respect the scale and materials of the historic buildings within the curtilage of the precinct.

NOTE: This report has been prepared on the basis of evidence examined by the study team and seeks to identify the most important heritage values of the item. The purpose of this report is to provide an initial evaluation. If any action is planned which might affect the cultural heritage significance of this place, advice should be sought through the Gatton Shire Council Planning Branch.

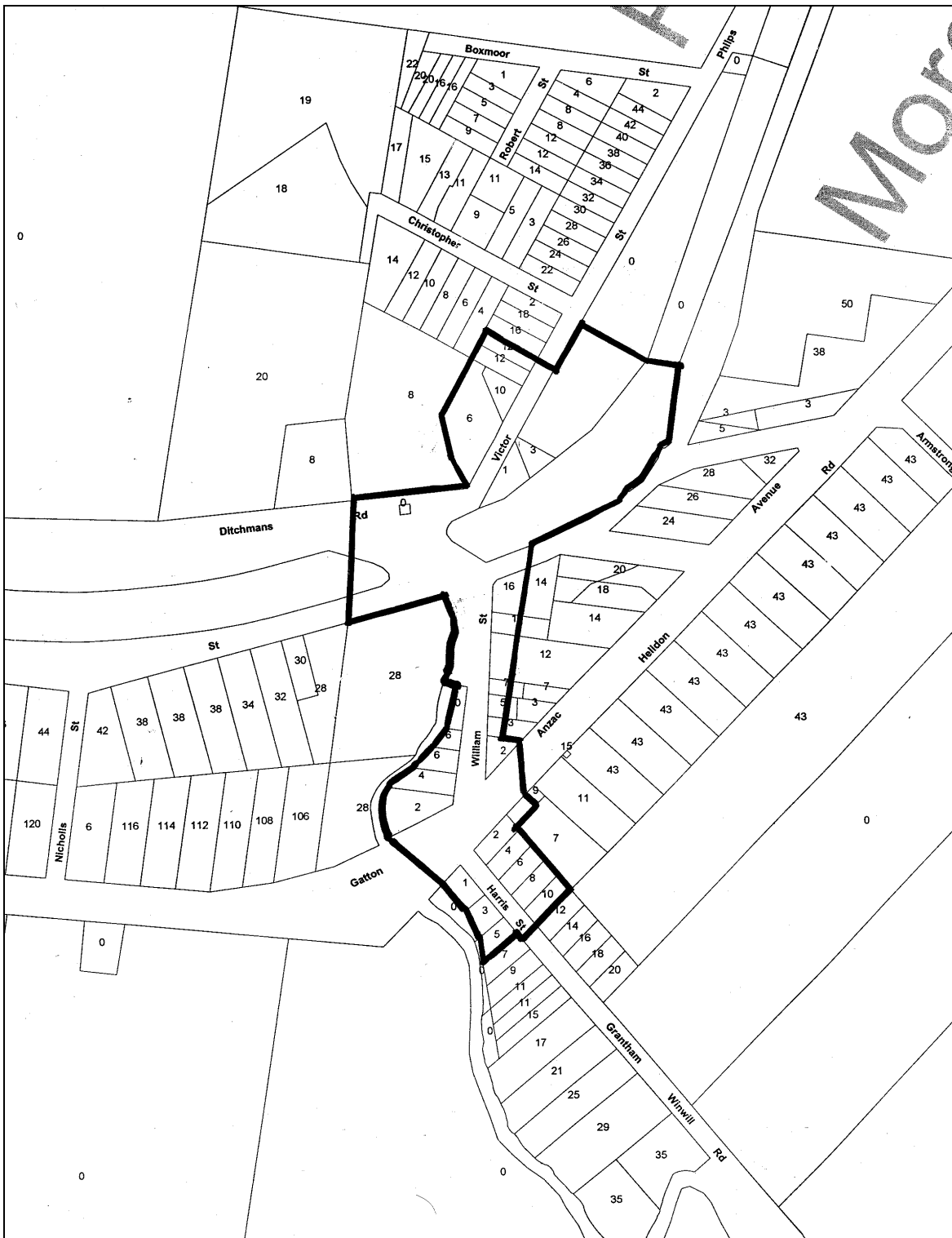

NOTE: This report has been prepared on the basis of evidence examined by the study team and seeks to identify the most important heritage values of the item. The purpose of this report is to provide an initial evaluation. If any action is planned which might affect the cultural heritage significance of this place, advice should be sought through the Gatton Shire Council Planning Branch.



# HELIDON (PART 1)

Hyde Farm, End of Symes Rd, Helidon	272
House, 19 Station Rd Helidon	274
House, 20 Arthur St Helidon	276
House, 2 Arthur St Helidon	278
House, 2 Arthur St Helidon	280
House, 5 William St Helidon	282
House, 14 William St Helidon	284
House, 22 Wrights Rd, Helidon	286
House, 10 Wrights Rd Helidon	288
House, 10 Bowen St Helidon	290
“Emohruo”, 8 Bowen St Helidon`	292
“Wingrove”, Connors Rd Helidon	294
House, 14 Russell St Helidon	298
House, 18 Wrights Rd Helidon	300
Helidon Town Centre Precinct	302
Railway footbridge, Across main railway line, Helidon	304
Station Master’s Residence, 5 Arthur St Helidon	306
Helidon Police Station, 21 Turner St Helidon	308
Helidon Post Office, 13 Turner St Helidon	310
Post Master’s Residence, 13 Turner St Helidon	312
War Memorial, In median strip, Railway Street, Helidon	314
QCWA 27 Railway St Helidon	316
Criterion Hotel, Cnr Turner St and Railway St, Helidon	318
Former Bank of NSW, 7 Railway St Helidon	320
House (converted business premises) 11 Railway St Helidon	322
House, 28 Railway St Helidon	324
Shop, 26 Railway St Helidon	326
Shop, 24 Railway St Helidon	328
Garage, 17 Railway St Helidon	330
Business premises, 16-18 Railway St Helidon	332
Helidon Shopping Centre, 14 Railway St Helidon	334
House, 9 School St Helidon	336
House, 32 School St Helidon	338
House, 28 School Rd Helidon	340
House, 32 Railway St Helidon	342

NOTE: This report has been prepared on the basis of evidence examined by the study team and seeks to identify the most important heritage values of the item. The purpose of this report is to provide an initial evaluation. If any action is planned which might affect the cultural heritage significance of this place, advice should be sought through the Gatton Shire Council Planning Branch.

NAME	Hyde Farm
CATEGORY	Farm House
LOCATION	End of Symes Rd, Helidon
RPD	11RP843414
LISTING BOUNDARY	House and yard
OTHER LISTINGS	-
SIGNIFICANCE LEVEL	Recorded

**History:****Description:**

- C1890s style pyramid roof and stepped curved verandah 3 sides.
- Single skin exposed stud core.
- Timber stumps
- Verandahs enclosed with weatherboard, with some louvre window infill.
- Large tank and enclosed stand; the undercroft of the stand appears to be used as a shed.

**Significance:**

Recorded for its demonstration of early form, materials and building techniques typical of the late 19<sup>th</sup>/early 20<sup>th</sup> century and for the unusual tankstand structure.

**Associated Items:****References:****Comments:**

.

NOTE: This report has been prepared on the basis of evidence examined by the study team and seeks to identify the most important heritage values of the item. The purpose of this report is to provide an initial evaluation. If any action is planned which might affect the cultural heritage significance of this place, advice should be sought through the Gatton Shire Council Planning Branch.



NAME	-
CATEGORY	House
LOCATION	19 Station Rd Helidon
RPD	1RP72654
LISTING BOUNDARY	Whole site
OTHER LISTINGS	-
SIGNIFICANCE LEVEL	Local

**History:****Description:**

- Probably built c1925
- Lowset bungalow, with a cross shaped plan, pyramid roof and gables on three sides.
- Gables are boxed and jettied.
- Left side verandah contains an entrance lobby and feature lobby window.
- Right side verandah sleep-out opening to main and second bedroom.
- Main bedroom features a cantilevered bay window.
- Skillion window hoods over aluminium framed replacement windows.

**Significance:**

The house is significant as a good example of the use of materials, form and detailing typical of the interwar period.

The house, with its surrounding garden, makes an aesthetic contribution to the streetscape.

**Associated Items:****References:**

**Comments:** - This form is sometimes known as a Coptic bungalow

NOTE: This report has been prepared on the basis of evidence examined by the study team and seeks to identify the most important heritage values of the item. The purpose of this report is to provide an initial evaluation. If any action is planned which might affect the cultural heritage significance of this place, advice should be sought through the Gatton Shire Council Planning Branch.



NOTE: This report has been prepared on the basis of evidence examined by the study team and seeks to identify the most important heritage values of the item. The purpose of this report is to provide an initial evaluation. If any action is planned which might affect the cultural heritage significance of this place, advice should be sought through the Gatton Shire Council Planning Branch.

NAME	-
CATEGORY	House
LOCATION	20 Arthur St Helidon
RPD	2RP2591 and 3RP2591
LISTING BOUNDARY	Whole site
OTHER LISTINGS	-
SIGNIFICANCE LEVEL	Local

**History:****Description:**

- c1890s style pyramid roof and stepped curved verandah dwelling.
- Separate kitchen wing and enclosed breezeway.
- Timber stumps
- Later weatherboard cladding possibly covering fan-lights over French doors.
- Later handrail.

**Significance:**

Important for its demonstration of aesthetic characteristics and building techniques typical of the late 19<sup>th</sup>/early 20<sup>th</sup> century.

The house, with its surrounding garden, contributes aesthetically to the streetscape.

**Associated Items:****References:****Comments: -**

NOTE: This report has been prepared on the basis of evidence examined by the study team and seeks to identify the most important heritage values of the item. The purpose of this report is to provide an initial evaluation. If any action is planned which might affect the cultural heritage significance of this place, advice should be sought through the Gatton Shire Council Planning Branch.



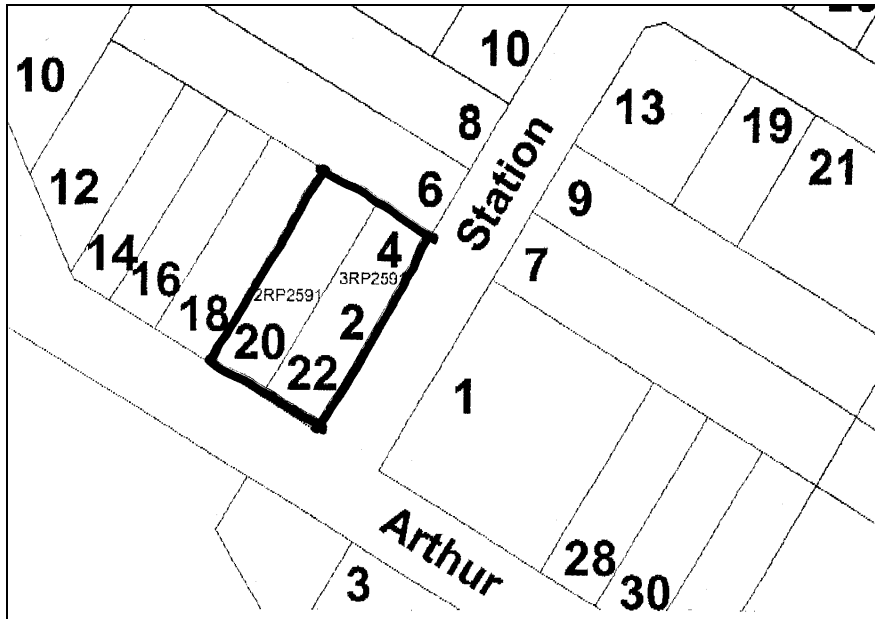

NOTE: This report has been prepared on the basis of evidence examined by the study team and seeks to identify the most important heritage values of the item. The purpose of this report is to provide an initial evaluation. If any action is planned which might affect the cultural heritage significance of this place, advice should be sought through the Gatton Shire Council Planning Branch.

NAME	-
CATEGORY	House
LOCATION	2 Arthur St Helidon
RPD	101H1261
LISTING BOUNDARY	Whole site
OTHER LISTINGS	-
SIGNIFICANCE LEVEL	Local

**History:****Description:**

- C1890s style pyramid roof and stepped verandah 3 sides.
- Front and rear gable.
- Weatherboard clad.
- Original windows and doors with coloured glass sidelights.
- Verandah balustrade replaced with weatherboard

**Significance:**

Important for its demonstration of early form and materials and for its demonstration of early building techniques.

**Associated Items:****References:****Comments: -**

NOTE: This report has been prepared on the basis of evidence examined by the study team and seeks to identify the most important heritage values of the item. The purpose of this report is to provide an initial evaluation. If any action is planned which might affect the cultural heritage significance of this place, advice should be sought through the Gatton Shire Council Planning Branch.



NOTE: This report has been prepared on the basis of evidence examined by the study team and seeks to identify the most important heritage values of the item. The purpose of this report is to provide an initial evaluation. If any action is planned which might affect the cultural heritage significance of this place, advice should be sought through the Gatton Shire Council Planning Branch.

NAME	-
CATEGORY	House
LOCATION	12 Arthur St Helidon
RPD	1RP52940
LISTING BOUNDARY	Whole site
OTHER LISTINGS	-
SIGNIFICANCE LEVEL	Local

**History:****Description:**

- C1890s style pyramid roof and stepped verandah 3 sides.
- Weatherboard clad.
- Original windows and doors with coloured glass sidelights.
- Two rail broomstick balustrade.
- Stop chamfered posts and ornate corner brackets.
- 1930s style entry stair and balustrade.
- Large Date Palm and mature trees in garden.

**Significance:**

Important for its demonstration of early form and materials and for its demonstration of early building techniques.

The house, with its surrounding garden and striking date palm, contributes aesthetically to the streetscape.

**Associated Items:****References:****Comments: -**

NOTE: This report has been prepared on the basis of evidence examined by the study team and seeks to identify the most important heritage values of the item. The purpose of this report is to provide an initial evaluation. If any action is planned which might affect the cultural heritage significance of this place, advice should be sought through the Gatton Shire Council Planning Branch.

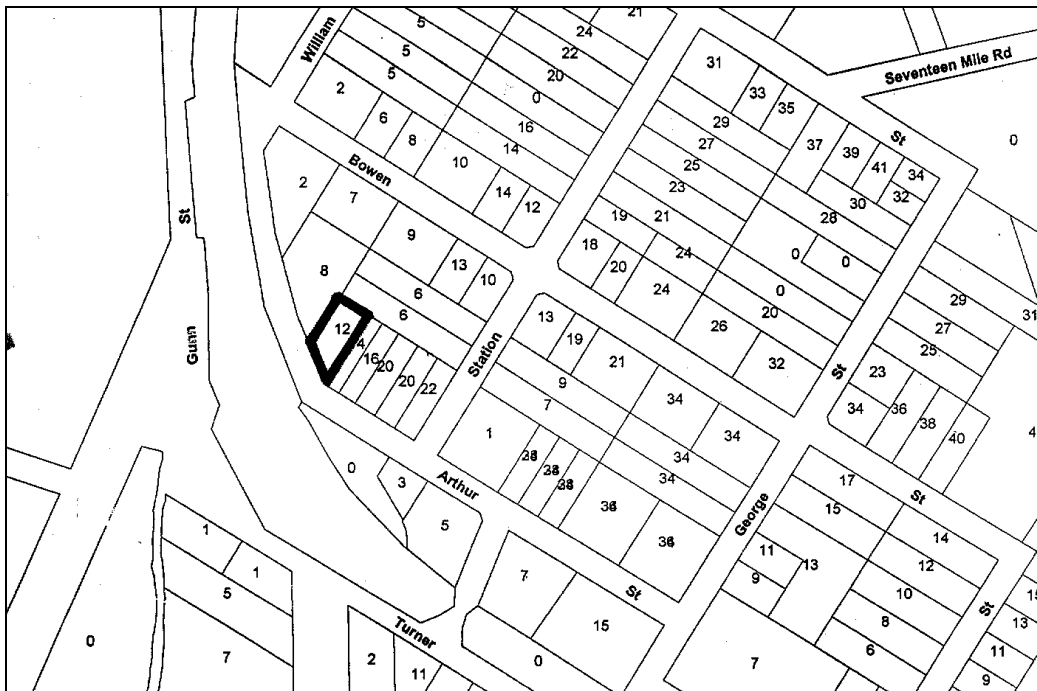

NOTE: This report has been prepared on the basis of evidence examined by the study team and seeks to identify the most important heritage values of the item. The purpose of this report is to provide an initial evaluation. If any action is planned which might affect the cultural heritage significance of this place, advice should be sought through the Gatton Shire Council Planning Branch.

NAME	-
CATEGORY	House
LOCATION	5 William St Helidon
RPD	218H1261, 219H1261 and 220H1261
LISTING BOUNDARY	Whole site
OTHER LISTINGS	-
SIGNIFICANCE LEVEL	Local

**History:****Description:**

- Front gable and rear hip roof
- Front gable fibro infill over the sandstone base
- windows and doors with coloured glass sidelights.
- Walls partly sandstone
- Brick Chimney.
- Rear skillion enclosed verandah on original sandstone plinth.

**Significance:**

An interesting and rare example of a house built using local sandstone.

**Associated Items:****References:****Comments: -**

NOTE: This report has been prepared on the basis of evidence examined by the study team and seeks to identify the most important heritage values of the item. The purpose of this report is to provide an initial evaluation. If any action is planned which might affect the cultural heritage significance of this place, advice should be sought through the Gatton Shire Council Planning Branch.



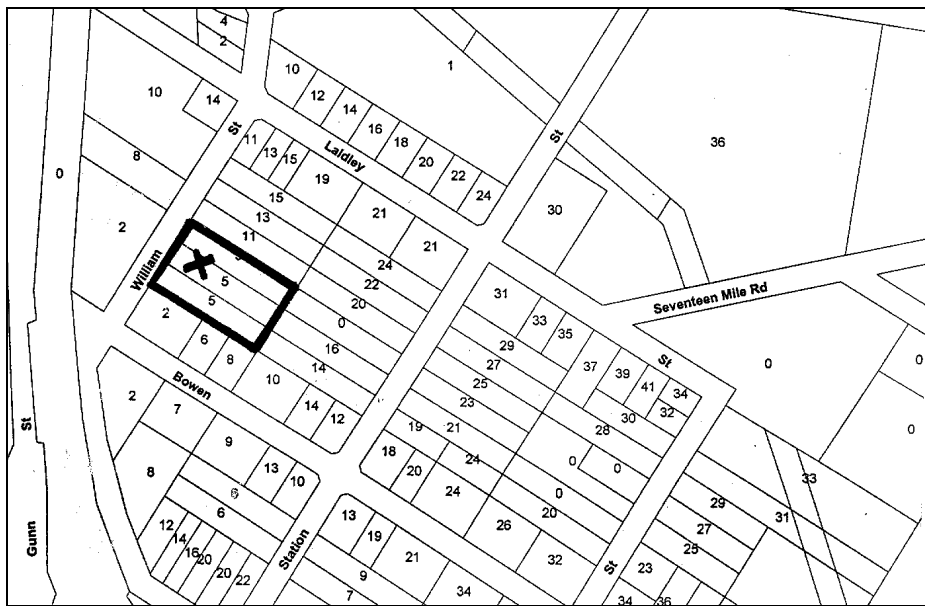

NOTE: This report has been prepared on the basis of evidence examined by the study team and seeks to identify the most important heritage values of the item. The purpose of this report is to provide an initial evaluation. If any action is planned which might affect the cultural heritage significance of this place, advice should be sought through the Gatton Shire Council Planning Branch.

NAME	-
CATEGORY	House
LOCATION	14 William St Helidon
RPD	1RP148530
LISTING BOUNDARY	Whole site
OTHER LISTINGS	-
SIGNIFICANCE LEVEL	Local

**History:****Description:**

- Colonial gable with front and rear skillion enclosed verandahs. A transverse gable extension added at a later date.
- Weatherboard clad.
- Aluminium framed windows.
- Recent entry stair and balustrade.

**Significance:**

Important for its demonstration of early form and materials and for its demonstration of early building techniques.

**Associated Items:****References:****Comments: -**

NOTE: This report has been prepared on the basis of evidence examined by the study team and seeks to identify the most important heritage values of the item. The purpose of this report is to provide an initial evaluation. If any action is planned which might affect the cultural heritage significance of this place, advice should be sought through the Gatton Shire Council Planning Branch.

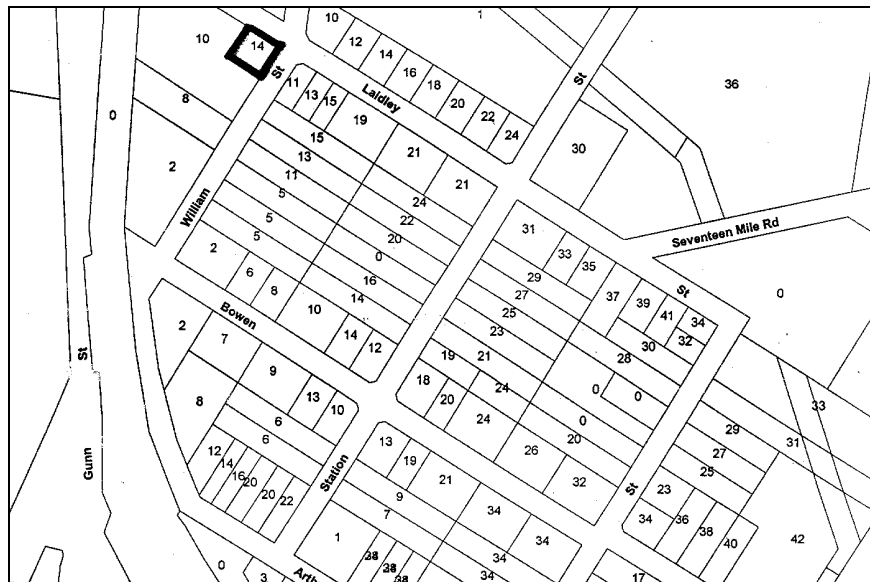

NOTE: This report has been prepared on the basis of evidence examined by the study team and seeks to identify the most important heritage values of the item. The purpose of this report is to provide an initial evaluation. If any action is planned which might affect the cultural heritage significance of this place, advice should be sought through the Gatton Shire Council Planning Branch.

NAME	-
CATEGORY	House
LOCATION	22 Wrights Rd
RPD	2RP59783
LISTING BOUNDARY	Whole site
OTHER LISTINGS	-
SIGNIFICANCE LEVEL	Local

**History:****Description:**

- C1890s style pyramid roof and stepped front verandah.
- Front verandah enclosed with weather board balustrade with aluminium windows above
- Weatherboard clad.
- Some windows and doors appear to be original.
- Post and chain wire fence.

**Significance:**

Important for its demonstration of early form and materials and for its demonstration of early building techniques.

**Associated Items:****References:****Comments:**

NOTE: This report has been prepared on the basis of evidence examined by the study team and seeks to identify the most important heritage values of the item. The purpose of this report is to provide an initial evaluation. If any action is planned which might affect the cultural heritage significance of this place, advice should be sought through the Gatton Shire Council Planning Branch.





NOTE: This report has been prepared on the basis of evidence examined by the study team and seeks to identify the most important heritage values of the item. The purpose of this report is to provide an initial evaluation. If any action is planned which might affect the cultural heritage significance of this place, advice should be sought through the Gatton Shire Council Planning Branch.

NAME	-
CATEGORY	House
LOCATION	10 Wrights Rd Helidon
RPD	1RP149759
LISTING BOUNDARY	Whole site
OTHER LISTINGS	-
SIGNIFICANCE LEVEL	Local

**History:****Description:**

- C1890s style pyramid roof with acroterian gutter feature and stepped curved front and rear verandahs.
- Verandahs enclosed with fibro balustrade and glazed louvres, with various additions to the front verandah.
- Weatherboard clad.
- Original windows and metal sunhoods to main core.

**Significance:**

Important for its demonstration of early form and materials and for its demonstration of early building techniques.

**Associated Items:****References:****Comments:**

NOTE: This report has been prepared on the basis of evidence examined by the study team and seeks to identify the most important heritage values of the item. The purpose of this report is to provide an initial evaluation. If any action is planned which might affect the cultural heritage significance of this place, advice should be sought through the Gatton Shire Council Planning Branch.



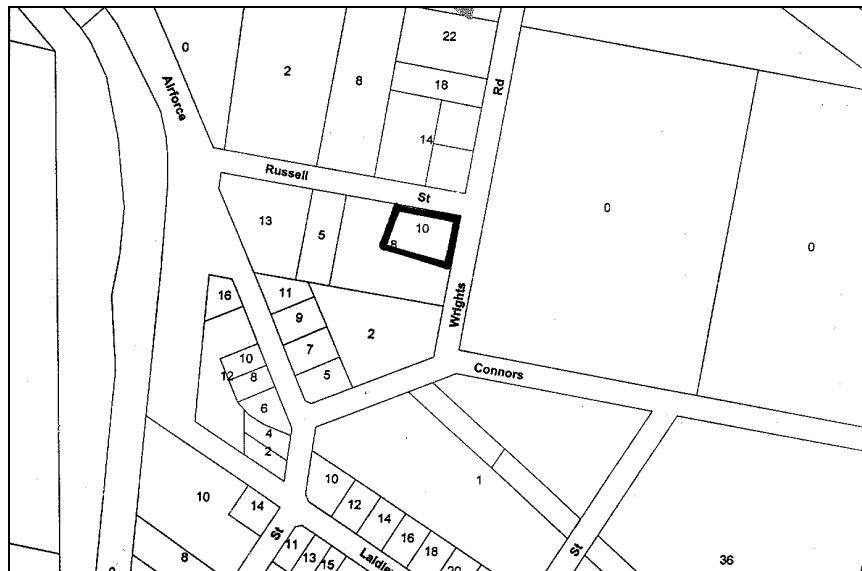

NOTE: This report has been prepared on the basis of evidence examined by the study team and seeks to identify the most important heritage values of the item. The purpose of this report is to provide an initial evaluation. If any action is planned which might affect the cultural heritage significance of this place, advice should be sought through the Gatton Shire Council Planning Branch.

NAME	-
CATEGORY	House
LOCATION	10 Bowen St Helidon
RPD	203H1261
LISTING BOUNDARY	Whole site
OTHER LISTINGS	-
SIGNIFICANCE LEVEL	Local

**History:****Description:**

- C1890s style pyramid roof with corner acroterian feature and stepped curved verandah 2 sides.
- Separate kitchen at rear.
- Single skin exposed stud and bracing and horizontal board lining.
- Original windows and doors.
- Two-rail broomstick balustrade with timber chain venetian blinds.
- Timber stumps
- Post, rail and chain wire fence.

**Significance:**

Important for its demonstration of aesthetic characteristics and building techniques typical of the late 19<sup>th</sup>/early 20<sup>th</sup> century.

It contributes aesthetically to the streetscape.

**Associated Items:****References:****Comments:**

NOTE: This report has been prepared on the basis of evidence examined by the study team and seeks to identify the most important heritage values of the item. The purpose of this report is to provide an initial evaluation. If any action is planned which might affect the cultural heritage significance of this place, advice should be sought through the Gatton Shire Council Planning Branch.

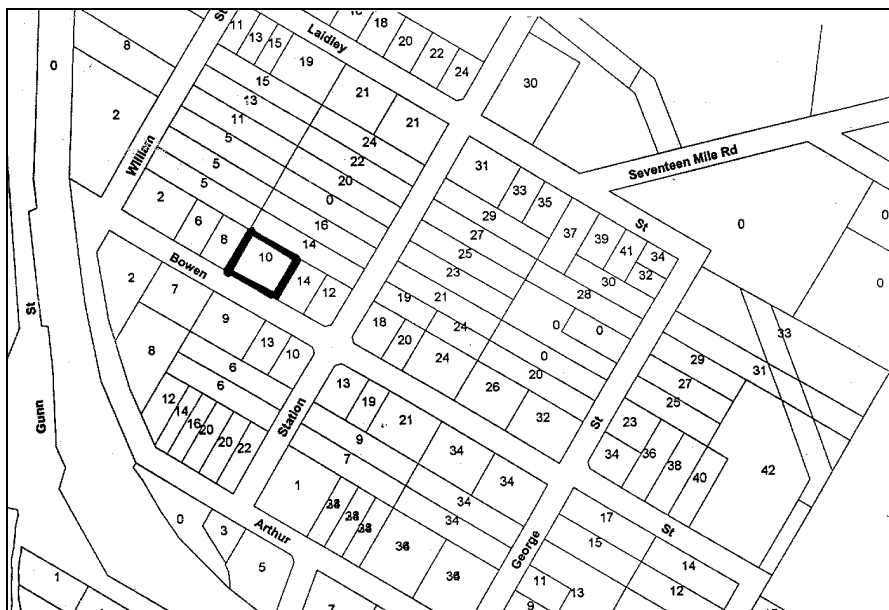

NOTE: This report has been prepared on the basis of evidence examined by the study team and seeks to identify the most important heritage values of the item. The purpose of this report is to provide an initial evaluation. If any action is planned which might affect the cultural heritage significance of this place, advice should be sought through the Gatton Shire Council Planning Branch.

NAME	Emohruo
CATEGORY	House
LOCATION	8 Bowen St Helidon
RPD	1RP158389
LISTING BOUNDARY	Whole site
OTHER LISTINGS	-
SIGNIFICANCE LEVEL	Local

**History:****Description:**

- C1890s style pyramid roof and stepped curved front and skillion rear verandah.
- Separate kitchen enclosed rear verandah breezeway
- Weatherboard clad.
- Original windows and doors.
- Weatherboard balustrade
- Original windows and metal sunhoods to main core.

**Significance:**

Important for its demonstration of early form and materials and for its demonstration of early building techniques.

**Associated Items:****References:****Comments:**

NOTE: This report has been prepared on the basis of evidence examined by the study team and seeks to identify the most important heritage values of the item. The purpose of this report is to provide an initial evaluation. If any action is planned which might affect the cultural heritage significance of this place, advice should be sought through the Gatton Shire Council Planning Branch.



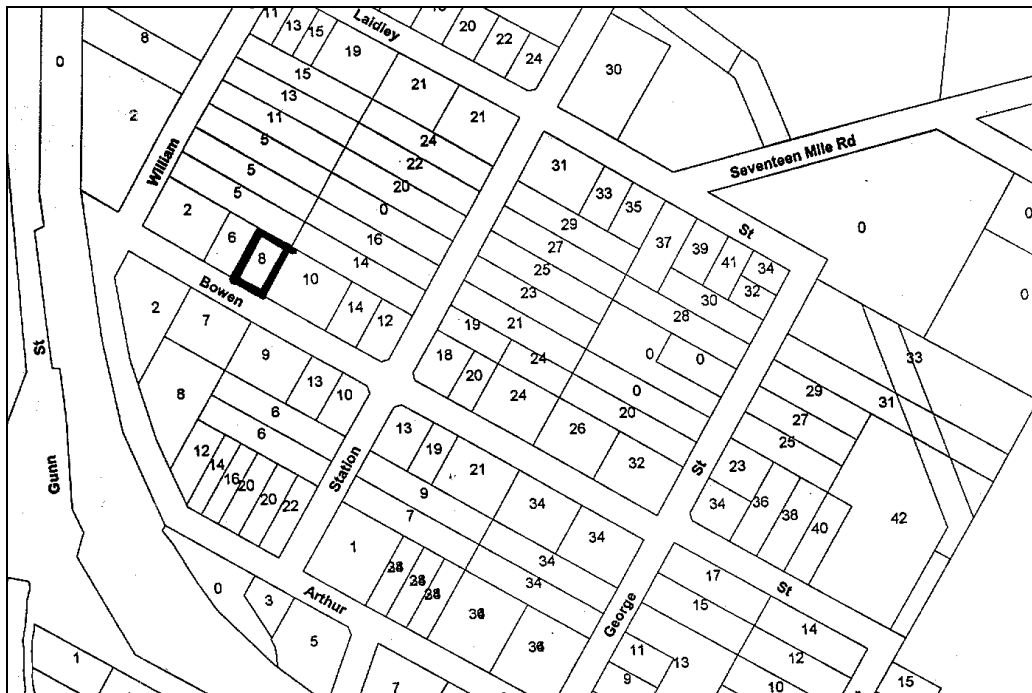

NOTE: This report has been prepared on the basis of evidence examined by the study team and seeks to identify the most important heritage values of the item. The purpose of this report is to provide an initial evaluation. If any action is planned which might affect the cultural heritage significance of this place, advice should be sought through the Gatton Shire Council Planning Branch.

NAME	"Wingrove"
CATEGORY	House
LOCATION	Connors Rd Helidon
RPD	131CSH51
LISTING BOUNDARY	House and garden
OTHER LISTINGS	-
SIGNIFICANCE LEVEL	Local

**History:****Description:**

- C1890s style pyramid roof and stepped verandah 3 sides.
- Single skin exposed stud and bracing and horizontal board lining.
- Original windows and doors.
- Two-rail broomstick balustrade.
- Stop chamfered posts and corner brackets
- Stone plinth to verandah.
- Sandstone rubble fence with urns on each pillar.

**Significance:**

Important for its demonstration of aesthetic characteristics and building techniques typical of the late 19<sup>th</sup>/early 20<sup>th</sup> century

The fence is an interesting and rare example of the use of local sandstone.

**Associated Items:****References:****Comments:**

NOTE: This report has been prepared on the basis of evidence examined by the study team and seeks to identify the most important heritage values of the item. The purpose of this report is to provide an initial evaluation. If any action is planned which might affect the cultural heritage significance of this place, advice should be sought through the Gatton Shire Council Planning Branch.



NOTE: This report has been prepared on the basis of evidence examined by the study team and seeks to identify the most important heritage values of the item. The purpose of this report is to provide an initial evaluation. If any action is planned which might affect the cultural heritage significance of this place, advice should be sought through the Gatton Shire Council Planning Branch.



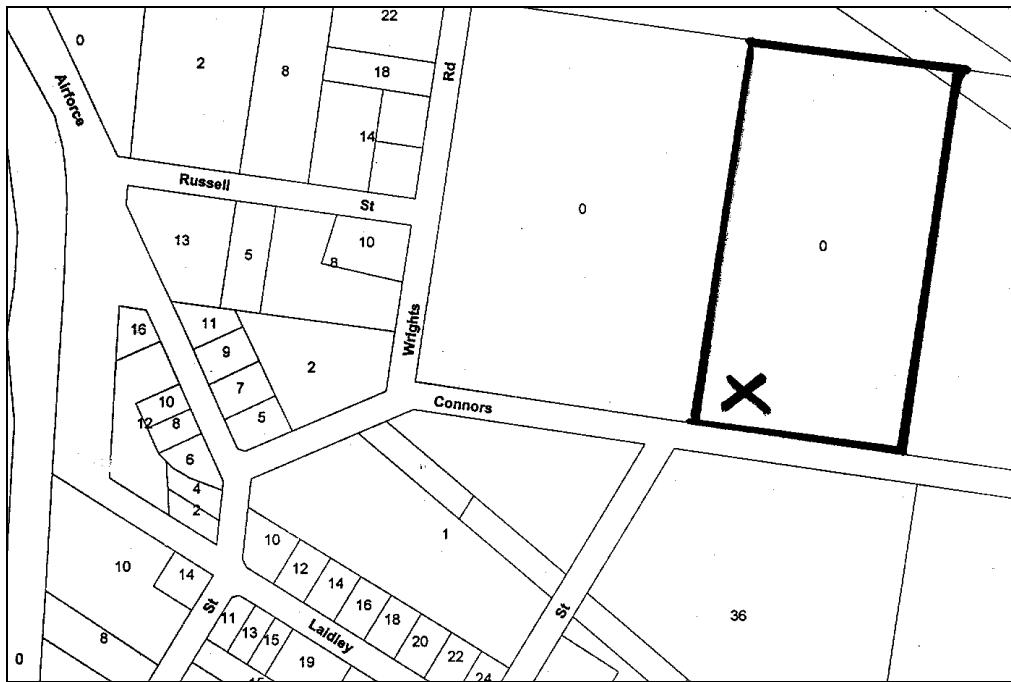

NOTE: This report has been prepared on the basis of evidence examined by the study team and seeks to identify the most important heritage values of the item. The purpose of this report is to provide an initial evaluation. If any action is planned which might affect the cultural heritage significance of this place, advice should be sought through the Gatton Shire Council Planning Branch.

NOTE: This report has been prepared on the basis of evidence examined by the study team and seeks to identify the most important heritage values of the item. The purpose of this report is to provide an initial evaluation. If any action is planned which might affect the cultural heritage significance of this place, advice should be sought through the Gatton Shire Council Planning Branch.

NAME	-
CATEGORY	House
LOCATION	14 Russell St Helidon
RPD	10SP112158 and 11SP112158 and 12SP112158
LISTING BOUNDARY	Whole site
OTHER LISTINGS	-
SIGNIFICANCE LEVEL	Local

**History:****Description:**

- C1890s style pyramid roof and stepped curved verandah 3 sides.
- Chamferboard and weatherboard cladding.
- Original windows and doors.
- Two-rail broomstick balustrade.
- Stop chamfered posts and corner brackets
- Picket fence and double entry gate.

**Significance:**

Important for its demonstration of aesthetic characteristics and building techniques typical of the late 19<sup>th</sup>/early 20<sup>th</sup> century.

The house, with its surrounding trees, contributes aesthetically to the streetscape.

**Associated Items:****References:****Comments:**

NOTE: This report has been prepared on the basis of evidence examined by the study team and seeks to identify the most important heritage values of the item. The purpose of this report is to provide an initial evaluation. If any action is planned which might affect the cultural heritage significance of this place, advice should be sought through the Gatton Shire Council Planning Branch.

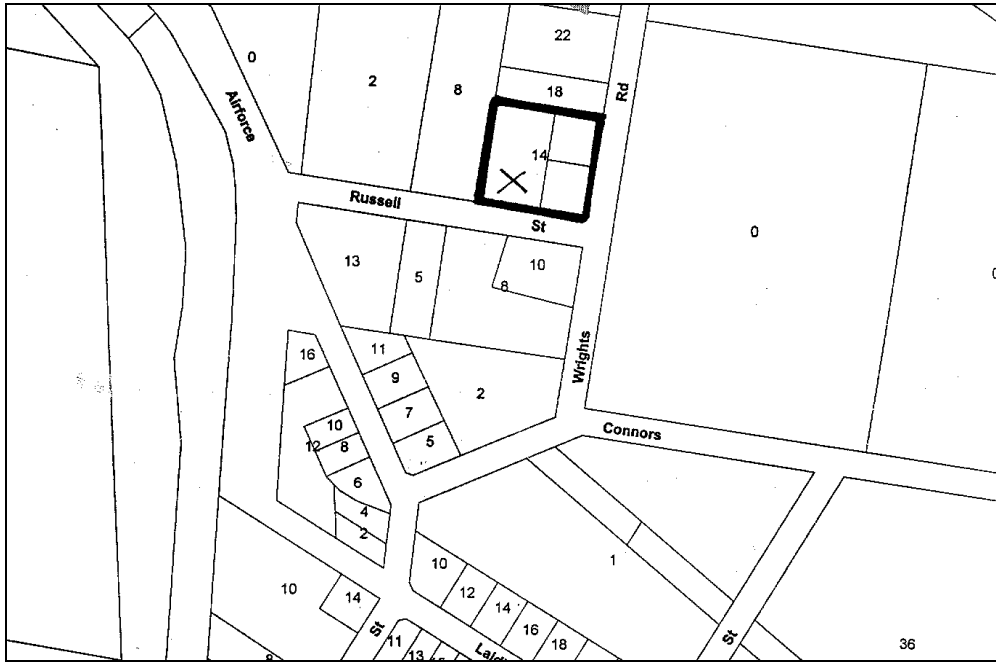

NOTE: This report has been prepared on the basis of evidence examined by the study team and seeks to identify the most important heritage values of the item. The purpose of this report is to provide an initial evaluation. If any action is planned which might affect the cultural heritage significance of this place, advice should be sought through the Gatton Shire Council Planning Branch.

NAME	-
CATEGORY	House
LOCATION	18 Wrights Rd Helidon
RPD	1RP59783
LISTING BOUNDARY	RPD
OTHER LISTINGS	-
SIGNIFICANCE LEVEL	Local

**History:** Manager of one of the quarries is said to have designed and lived in this residence. Sandstone construction is original.

**Description:**

- Circa late 1920s to early 30s transverse gable with street facing gable and hipped front porch.
- Gable infill of fibro with thick cover moulds
- Sandstone construction.
- Original windows and doors.
- Stone plinth to verandah with sandstone balustrade and handrail.
- Sandstone plinth and pillars to front fence with pipe and chain wire infill.

**Significance:**

An interesting and rare example of a house built using local sandstone.

**Associated Items:**

**References:**

**Comments:**

NOTE: This report has been prepared on the basis of evidence examined by the study team and seeks to identify the most important heritage values of the item. The purpose of this report is to provide an initial evaluation. If any action is planned which might affect the cultural heritage significance of this place, advice should be sought through the Gatton Shire Council Planning Branch.



NOTE: This report has been prepared on the basis of evidence examined by the study team and seeks to identify the most important heritage values of the item. The purpose of this report is to provide an initial evaluation. If any action is planned which might affect the cultural heritage significance of this place, advice should be sought through the Gatton Shire Council Planning Branch.

NAME	Helidon Town Centre
CATEGORY	Precinct
LOCATION	See Map
RPD	Various
LISTING BOUNDARY	See map
OTHER LISTINGS	-
SIGNIFICANCE LEVEL	Local

**History:****Description:**

This area is based around the railway and includes shops, an hotel, a footbridge, war memorial and landscaping, sandstone kerbing on the western side of Railway Street, police station and post office, and a former bank.

Some buildings within this precinct are individually listed.

**Significance:**

This area is important for the evidence it contains of the early development of the town centre and there are elements surviving in this precinct which are evocative of its commercial enterprise and growth.

This precinct is valued by the community and is important for imparting a sense of place.

**Associated Items:**

The Catholic complex nearby.

**References:**

**Comments:** This area is a footprint of the historic centre of the township.

It will be important to try to retain the character of this area and prevent unsympathetic alterations and further erosion of its integrity. This does not mean that new buildings within this precinct should be replicas. New development and infill should respect the scale and materials of the historic buildings within the curtilage of the precinct.

Telstra should be encouraged to screen its unsympathetic structure in Railway St with appropriate landscaping.

NOTE: This report has been prepared on the basis of evidence examined by the study team and seeks to identify the most important heritage values of the item. The purpose of this report is to provide an initial evaluation. If any action is planned which might affect the cultural heritage significance of this place, advice should be sought through the Gatton Shire Council Planning Branch.



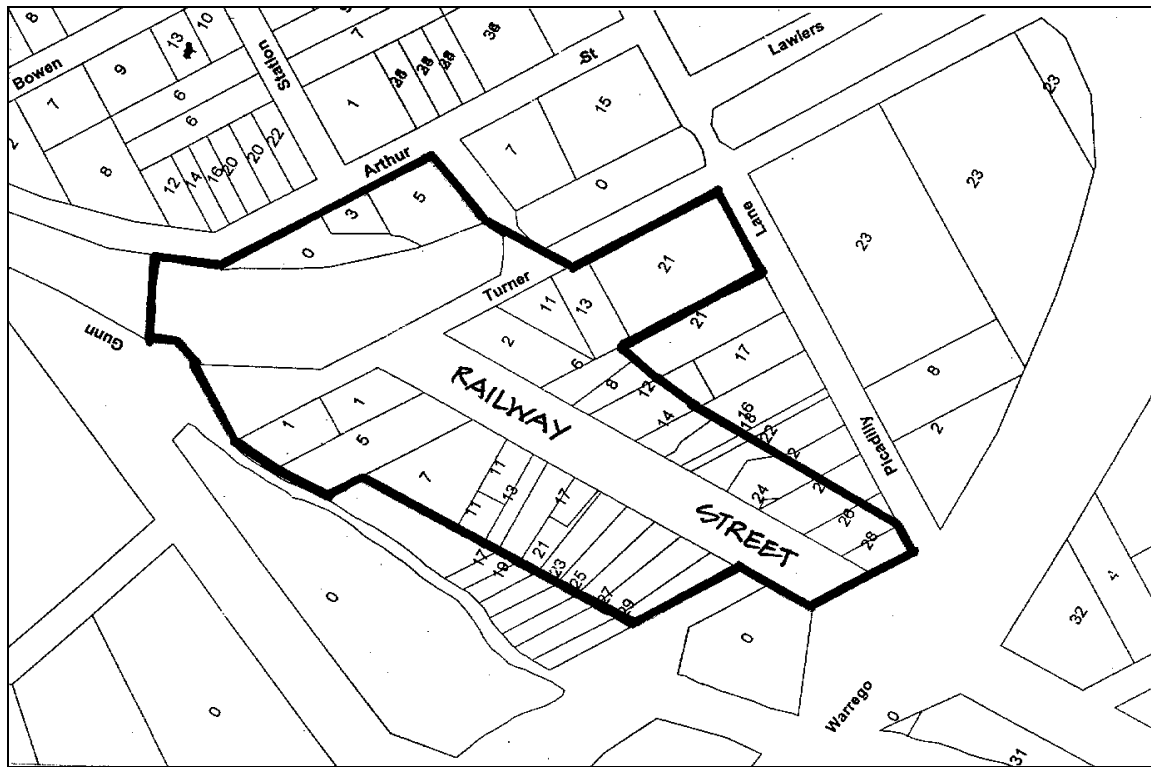

NOTE: This report has been prepared on the basis of evidence examined by the study team and seeks to identify the most important heritage values of the item. The purpose of this report is to provide an initial evaluation. If any action is planned which might affect the cultural heritage significance of this place, advice should be sought through the Gatton Shire Council Planning Branch.

NAME	Timber Footbridge
CATEGORY	Railway structure
LOCATION	Across main railway line, Helidon
RPD	On 452CH5280
LISTING BOUNDARY	Site of footbridge
OTHER LISTINGS	-
SIGNIFICANCE LEVEL	Local

**History:****Description:**

Timber framed and cross braced footbridge with half landings on both sides.

**Significance:**

A good example of a timber railway overbridge, now becoming uncommon.

**Associated Items:** Station Master's house.

**References:****Comments:**

NOTE: This report has been prepared on the basis of evidence examined by the study team and seeks to identify the most important heritage values of the item. The purpose of this report is to provide an initial evaluation. If any action is planned which might affect the cultural heritage significance of this place, advice should be sought through the Gatton Shire Council Planning Branch.



NOTE: This report has been prepared on the basis of evidence examined by the study team and seeks to identify the most important heritage values of the item. The purpose of this report is to provide an initial evaluation. If any action is planned which might affect the cultural heritage significance of this place, advice should be sought through the Gatton Shire Council Planning Branch.

NAME	Station Master's Residence
CATEGORY	House - railway
LOCATION	5 Arthur St Helidon
RPD	5RP886802
LISTING BOUNDARY	Whole of site
OTHER LISTINGS	-
SIGNIFICANCE LEVEL	Local

**History:****Description:**

- Gable-end core with stepped verandahs to 3 sides.
- Weatherboard clad and gable infill.
- Separate kitchen building accessed via breezeway.
- Original windows with bull-nose sunhoods.
- Weatherboard balustrade with louvred window infill above handrail.
- Post and rail fence.

**Significance:**

Important for its demonstration of early form and materials and for its demonstration of early building techniques.

Important for its association with the railway.

**Associated Items:** Footbridge

**References:****Comments:**

NOTE: This report has been prepared on the basis of evidence examined by the study team and seeks to identify the most important heritage values of the item. The purpose of this report is to provide an initial evaluation. If any action is planned which might affect the cultural heritage significance of this place, advice should be sought through the Gatton Shire Council Planning Branch.

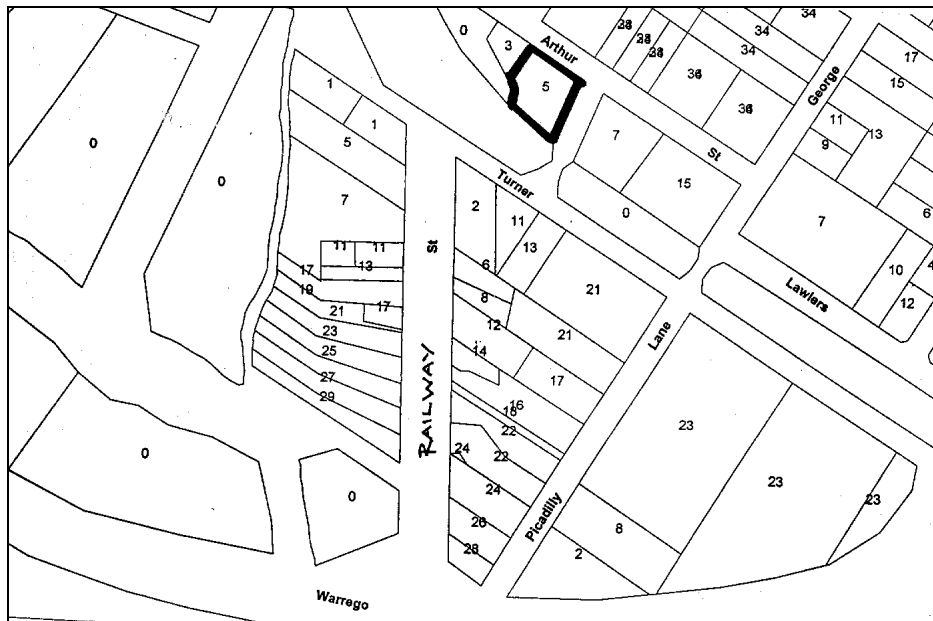

NOTE: This report has been prepared on the basis of evidence examined by the study team and seeks to identify the most important heritage values of the item. The purpose of this report is to provide an initial evaluation. If any action is planned which might affect the cultural heritage significance of this place, advice should be sought through the Gatton Shire Council Planning Branch.

NAME	Helidon Police Station
CATEGORY	Government building
LOCATION	21 Turner St Helidon
RPD	142H1263
LISTING BOUNDARY	Whole site
OTHER LISTINGS	-
SIGNIFICANCE LEVEL	Police station local; older (adjacent) residence local

**History:****Description:**

- Original wing C1910 Dutch gable with incorporated verandahs on all sides.
- Single skin exposed studs and horizontal boards lining original rectangular plan building.
- Later wing weatherboard clad.
- Two-rail slatted balustrade
- Low-set and restumped on concrete stumps
- Two residences on same block

**Significance:**

A substantial and important example of a local police station

Important for its demonstration of early form and materials and for its demonstration of early building techniques.

The building contributes aesthetically to the streetscape.

Important for its association with the development of Helidon township.

**Associated Items:****References:****Comments:**

NOTE: This report has been prepared on the basis of evidence examined by the study team and seeks to identify the most important heritage values of the item. The purpose of this report is to provide an initial evaluation. If any action is planned which might affect the cultural heritage significance of this place, advice should be sought through the Gatton Shire Council Planning Branch.



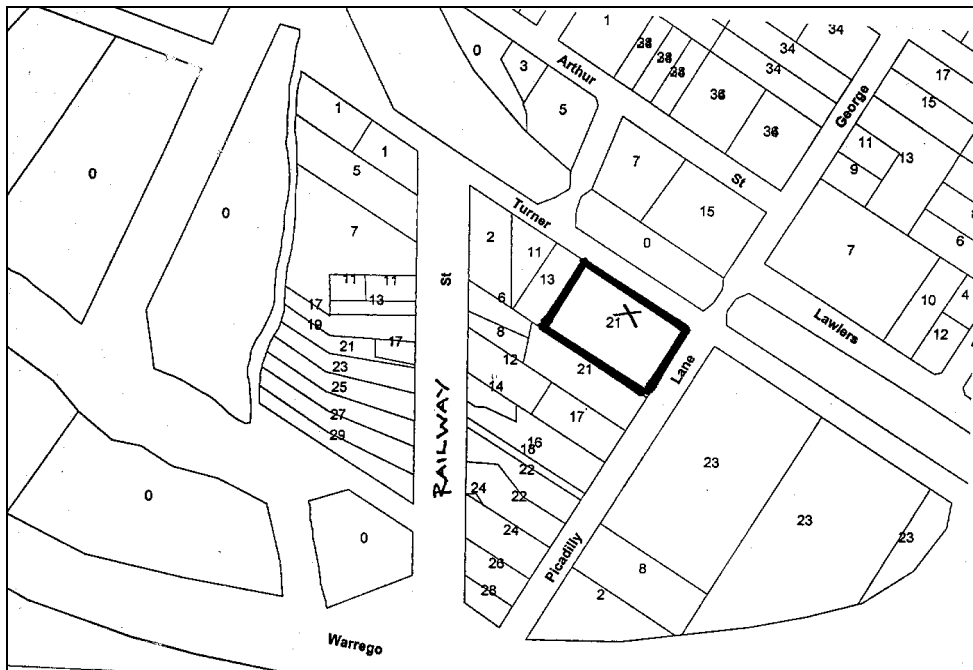

NOTE: This report has been prepared on the basis of evidence examined by the study team and seeks to identify the most important heritage values of the item. The purpose of this report is to provide an initial evaluation. If any action is planned which might affect the cultural heritage significance of this place, advice should be sought through the Gatton Shire Council Planning Branch.

NAME	Helidon Post Office
CATEGORY	Government Building
LOCATION	13 Turner St Helidon
RPD	97H12610
LISTING BOUNDARY	Whole site
OTHER LISTINGS	-
SIGNIFICANCE LEVEL	Local.

**History:**

**Said to have been** relocated from the right side of the Criterion Hotel to present site, probably before 1920.

**Description:**

- C1915 long ridge pyramid with asymmetrical street facing gable and front porch, rear skillion verandah.
- Gable infill of sheeting with wide cover moulds
- Weatherboard cladding.
- Original windows and doors.
- Hipped window hoods with the side hoods constructed with timber shingles, front replaced with mini orb iron.
- Low set with brick stumps and slatted infill between.
- Two-rail slat balustrade to small front porch.

**Significance:**

Important for its demonstration of early form and materials and for its demonstration of early building techniques.

It contributes aesthetically to the streetscape.

Important for its association with the provision of postal services and the development of Helidon township.

**Associated Items:** Post Master's Residence at rear

**References:** Local information

**Comments:**

NOTE: This report has been prepared on the basis of evidence examined by the study team and seeks to identify the most important heritage values of the item. The purpose of this report is to provide an initial evaluation. If any action is planned which might affect the cultural heritage significance of this place, advice should be sought through the Gatton Shire Council Planning Branch.

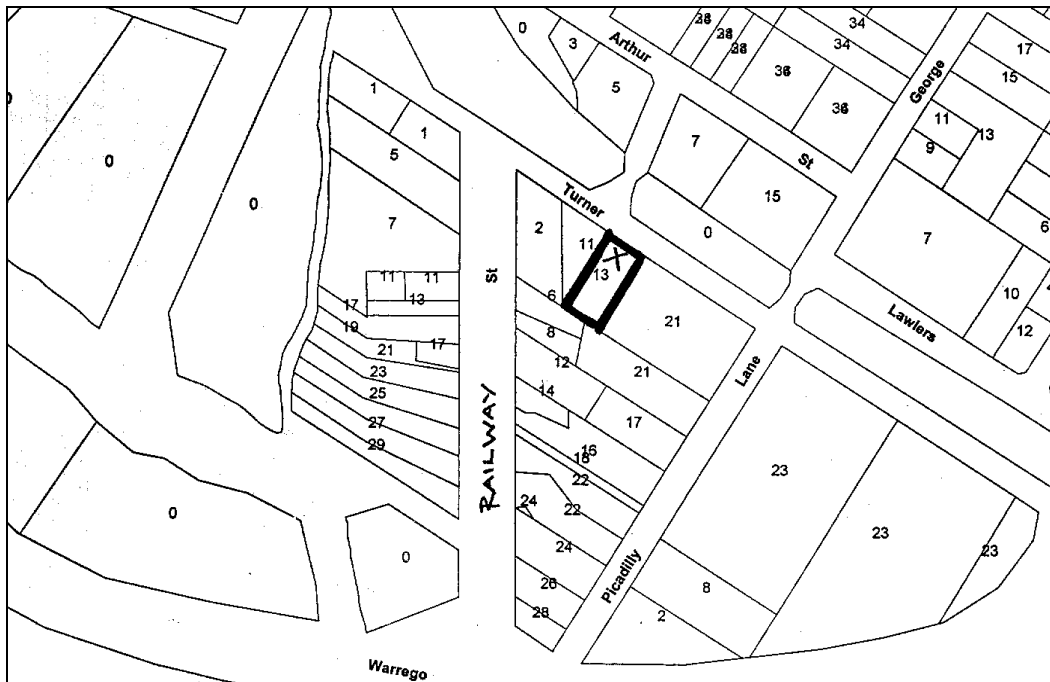

NOTE: This report has been prepared on the basis of evidence examined by the study team and seeks to identify the most important heritage values of the item. The purpose of this report is to provide an initial evaluation. If any action is planned which might affect the cultural heritage significance of this place, advice should be sought through the Gatton Shire Council Planning Branch.

NAME	Post Master's Residence
CATEGORY	House
LOCATION	13 Turner St Helidon
RPD	97H12610
LISTING BOUNDARY	Whole site
OTHER LISTINGS	-
SIGNIFICANCE LEVEL	Local

**History:****Description:**

- Probably c1910 long ridge hipped dwelling modified when Post Office was relocated. Modification comprised of the pyramid roofed front wing and hipped porch to the left side.
- Matching the Post Office, the front window hoods are constructed with timber shingles.
- Weatherboard cladding.
- Original windows and doors.
- Low set with timber stumps.
- Two-rail slat balustrade to small front porch.

**Significance:**

Important for its demonstration of early form and materials and for its demonstration of early building techniques.

The house, with its surrounding garden, contributes aesthetically to the streetscape.

Important for its association with the postal service and the development of Helidon.

**Associated Items:** Post Office at front of block

**References:****Comments:**

NOTE: This report has been prepared on the basis of evidence examined by the study team and seeks to identify the most important heritage values of the item. The purpose of this report is to provide an initial evaluation. If any action is planned which might affect the cultural heritage significance of this place, advice should be sought through the Gatton Shire Council Planning Branch.

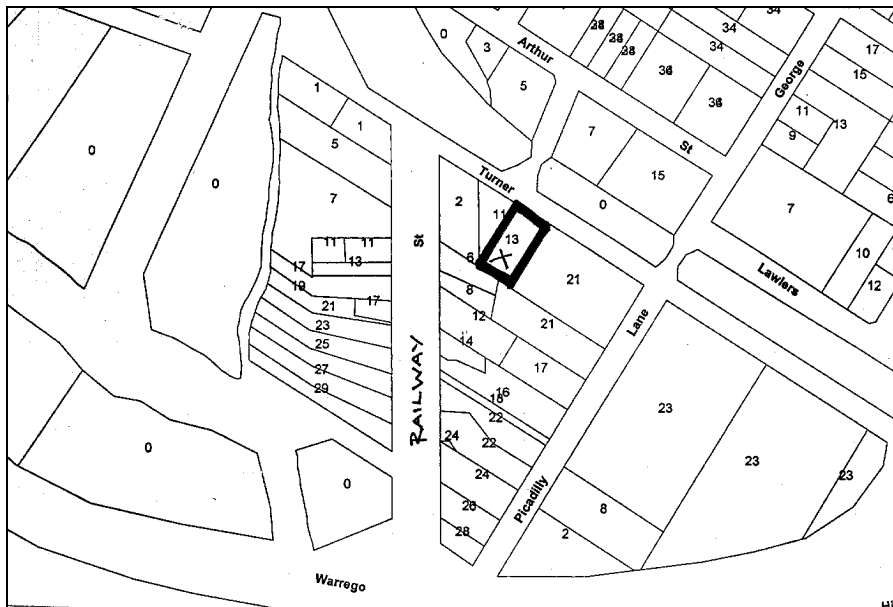

NOTE: This report has been prepared on the basis of evidence examined by the study team and seeks to identify the most important heritage values of the item. The purpose of this report is to provide an initial evaluation. If any action is planned which might affect the cultural heritage significance of this place, advice should be sought through the Gatton Shire Council Planning Branch.

NAME	War memorial
CATEGORY	Monument and trees
LOCATION	In median strip, Railway Street
RPD	N/a
LISTING BOUNDARY	All of median strip
OTHER LISTINGS	-
SIGNIFICANCE LEVEL	State

**History:****Description:**

- Titled "Names of the fallen" and unveiled 14<sup>th</sup> September, 1978.
- Sandstone blocks on granite plinth.
- Spherical etched sandstone world map balanced on top.
- Engraved brass plaques on each side.
- Six low sandstone blocks mark the edge of the base.

**Significance:**

The monument is significant as a demonstration of the participation of local people in major world conflicts, and has a strong association with the local community as a demonstration of the wish of local people to commemorate those who died.

The median strip and monument make an important aesthetic contribution to the streetscape.

**Associated Items:****References:****Comments:**

NOTE: This report has been prepared on the basis of evidence examined by the study team and seeks to identify the most important heritage values of the item. The purpose of this report is to provide an initial evaluation. If any action is planned which might affect the cultural heritage significance of this place, advice should be sought through the Gatton Shire Council Planning Branch.



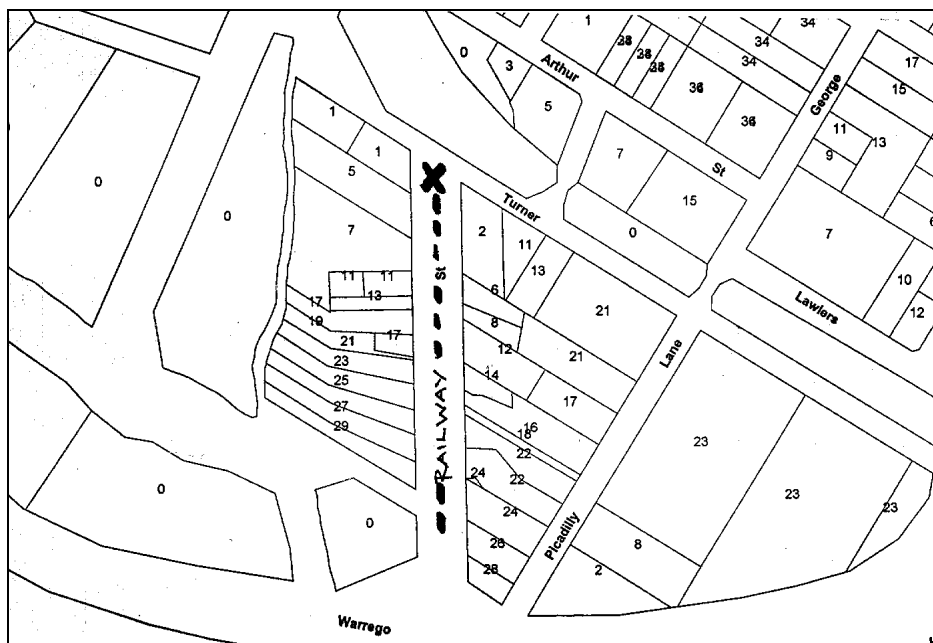

NAME	QCWA
CATEGORY	Public building
LOCATION	27 Railway St Helidon
RPD	L6RP23160
LISTING BOUNDARY	Whole site
OTHER LISTINGS	-
SIGNIFICANCE LEVEL	Recorded

**History:**

Description: Domestic scale lowset building sheeted with fibro cement, simple parapeted front entry

**Significance:**

Recorded for its association with the QCWA and its demonstration of the development of organisations and services in the town of Helidon.

**Associated Items:**

Included in precinct

**References:****Comments:**

NOTE: This report has been prepared on the basis of evidence examined by the study team and seeks to identify the most important heritage values of the item. The purpose of this report is to provide an initial evaluation. If any action is planned which might affect the cultural heritage significance of this place, advice should be sought through the Gatton Shire Council Planning Branch.

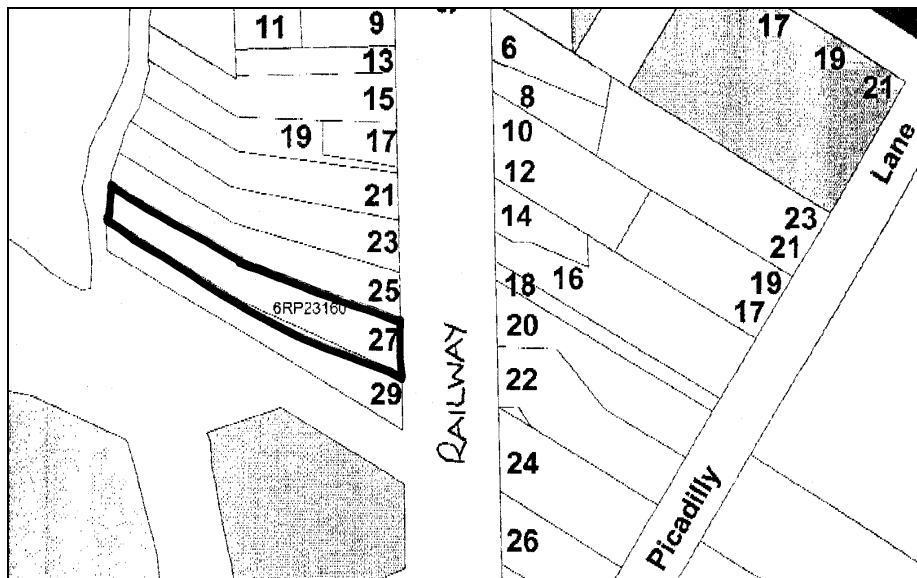

NOTE: This report has been prepared on the basis of evidence examined by the study team and seeks to identify the most important heritage values of the item. The purpose of this report is to provide an initial evaluation. If any action is planned which might affect the cultural heritage significance of this place, advice should be sought through the Gatton Shire Council Planning Branch.

NAME	Criterion Hotel
CATEGORY	Hotel
LOCATION	Cnr Turner St and Railway St, Helidon
RPD	1RP53098 and 2RP53098
LISTING BOUNDARY	Whole site
OTHER LISTINGS	-
SIGNIFICANCE LEVEL	Local

**History:****Description:**

- Two storey Federation, hipped roof with stepped bull-nose verandahs. The plan follows the alignment and wraps around the corner into Railway Street.
- The main core is painted brick construction.
- Verandahs are timber with the original posts and corner brackets remaining on the upper level only.
- Fibro valance and balustrade has replace the original, probably timber.
- Original triple course arched windows and doors to feature window and doors with segmental arches to less prominent windows.
- A chimney and roof vents.

**Significance:**

Important for its demonstration of early form and materials and for its demonstration of early building techniques.

The hotel has a prominent corner position opposite the railway and contributes aesthetically to the streetscape of Helidon.

The scale and location of the hotel indicate the early importance of the town and the pattern of development of Helidon.

**Associated Items:****References:****Comments:**

NOTE: This report has been prepared on the basis of evidence examined by the study team and seeks to identify the most important heritage values of the item. The purpose of this report is to provide an initial evaluation. If any action is planned which might affect the cultural heritage significance of this place, advice should be sought through the Gatton Shire Council Planning Branch.



NOTE: This report has been prepared on the basis of evidence examined by the study team and seeks to identify the most important heritage values of the item. The purpose of this report is to provide an initial evaluation. If any action is planned which might affect the cultural heritage significance of this place, advice should be sought through the Gatton Shire Council Planning Branch.



NAME	Former Bank of NSW
CATEGORY	Commercial building
LOCATION	7 Railway St Helidon
RPD	2RP23163
LISTING BOUNDARY	Whole site
OTHER LISTINGS	Queensland Heritage Register File 600512 Register of the National Estate
SIGNIFICANCE LEVEL	National

**History:**

A receiving office of the Gatton Branch of the Royal Bank of Queensland opened at Helidon in 1906. This was raised to a full branch, operating from rented premises, in 1910 as a response to the opening of a branch of the rival Aust Bank of Commerce.

These purpose designed premises were built c1916.

In 1917, the bank merged with the Bank of North Queensland to become the Bank of Queensland.

The Helidon branch closed in 1920. The premises were then acquired by the Bank of Commerce which moved there in 1921. The Bank of Commerce was absorbed by the Bank of New South Wales in 1931. The Helidon branch closed finally in 1971 and the building was sold to private owners.

**Description:**

A small timber structure on low stumps comprising a banking chamber with manager's residence at the rear. The façade of the banking chamber has a central arch above the entry with pediment above supported on double timber corbels and fluted timber pilasters. Above the pediment is a pressed metal sheeted gable. Intersection of the former banking chamber and pyramid roofed residence is most unusual.

**Significance:**

The former Royal Bank of Queensland is illustrative of the pattern of development of the Helidon district which prospered with the dairy boom of the early 1900s. The building is a good example of its type, illustrating the characteristics of combined banking chamber and managers residence of modest design and materials, adapted for a small township.

The building is important for its architectural appeal and for its contribution to the streetscape of Helidon.

The place has a strong association with the work of the Royal Bank of Qld which in the late 19<sup>th</sup> and early 20<sup>th</sup> century, rivalled the Qld National Bank in extending its services throughout rural Queensland.

**Associated Items:**

**References:** Information from entry in Qld Heritage Register

**Comments:** There is another house at the rear of the property

NOTE: This report has been prepared on the basis of evidence examined by the study team and seeks to identify the most important heritage values of the item. The purpose of this report is to provide an initial evaluation. If any action is planned which might affect the cultural heritage significance of this place, advice should be sought through the Gatton Shire Council Planning Branch.



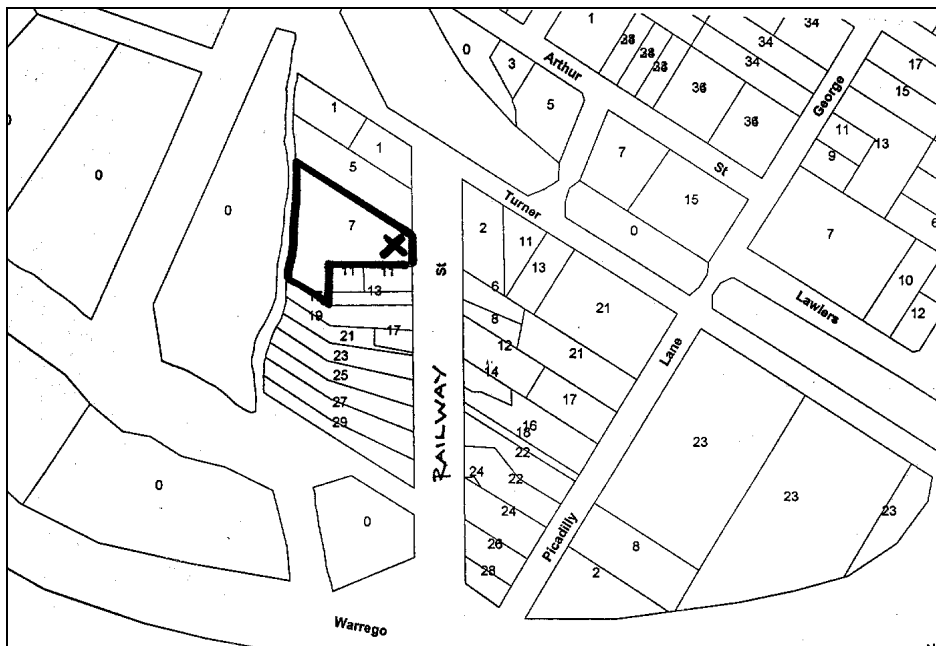

NOTE: This report has been prepared on the basis of evidence examined by the study team and seeks to identify the most important heritage values of the item. The purpose of this report is to provide an initial evaluation. If any action is planned which might affect the cultural heritage significance of this place, advice should be sought through the Gatton Shire Council Planning Branch.

NAME	
CATEGORY	Commercial Building now house
LOCATION	11 Railway St Helidon
RPD	2RP84577
LISTING BOUNDARY	Whole of site
OTHER LISTINGS	-
SIGNIFICANCE LEVEL	Recorded

**History:** Sign writing on rear of building advertises a “Shell” petrol pumping station.

**Description:**

- Corrugated iron clad gable end shed.
- Timber 4 paned sash windows.
- Converted into a dwelling.

**Significance:**

Recorded as a demonstration of earlier commercial/industrial activity in this area

**Associated Items:**

**References:**

**Comments:**

NOTE: This report has been prepared on the basis of evidence examined by the study team and seeks to identify the most important heritage values of the item. The purpose of this report is to provide an initial evaluation. If any action is planned which might affect the cultural heritage significance of this place, advice should be sought through the Gatton Shire Council Planning Branch.

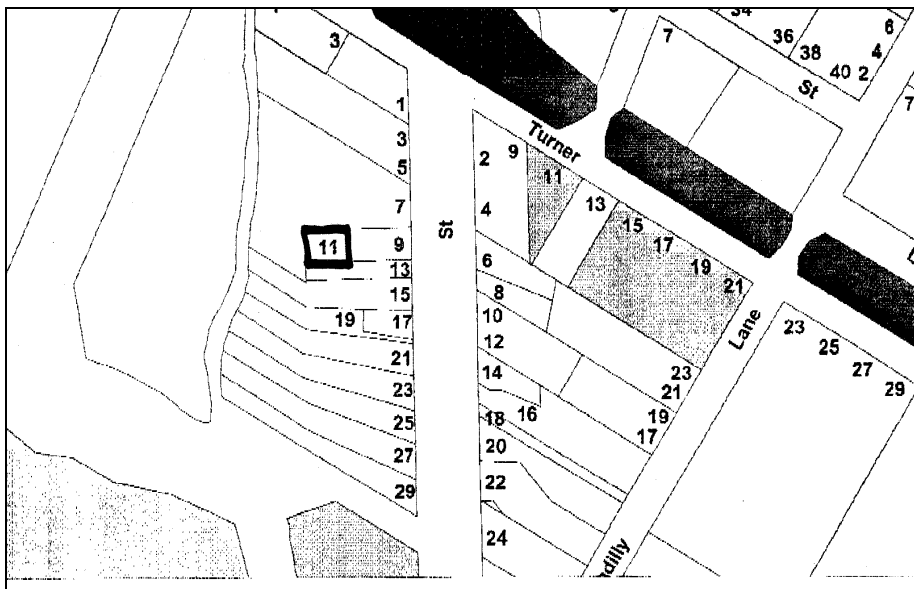

NOTE: This report has been prepared on the basis of evidence examined by the study team and seeks to identify the most important heritage values of the item. The purpose of this report is to provide an initial evaluation. If any action is planned which might affect the cultural heritage significance of this place, advice should be sought through the Gatton Shire Council Planning Branch.

NAME	-
CATEGORY	House
LOCATION	28 Railway St Helidon
RPD	9CSH1370
LISTING BOUNDARY	Whole of site
OTHER LISTINGS	-
SIGNIFICANCE LEVEL	Local

**History:****Description:**

- C1880s style long ridge hip roofed cottage with a stepped front verandah.
- Two rail slat balustrade.
- Picket fence.

**Significance:**

Important for its demonstration of aesthetic characteristics and building techniques typical of the late 19<sup>th</sup>/early 20<sup>th</sup> century.

**Associated Items:** Located on Railway Street and adjacent to the avenue of trees.

**References:****Comments:**

NOTE: This report has been prepared on the basis of evidence examined by the study team and seeks to identify the most important heritage values of the item. The purpose of this report is to provide an initial evaluation. If any action is planned which might affect the cultural heritage significance of this place, advice should be sought through the Gatton Shire Council Planning Branch.



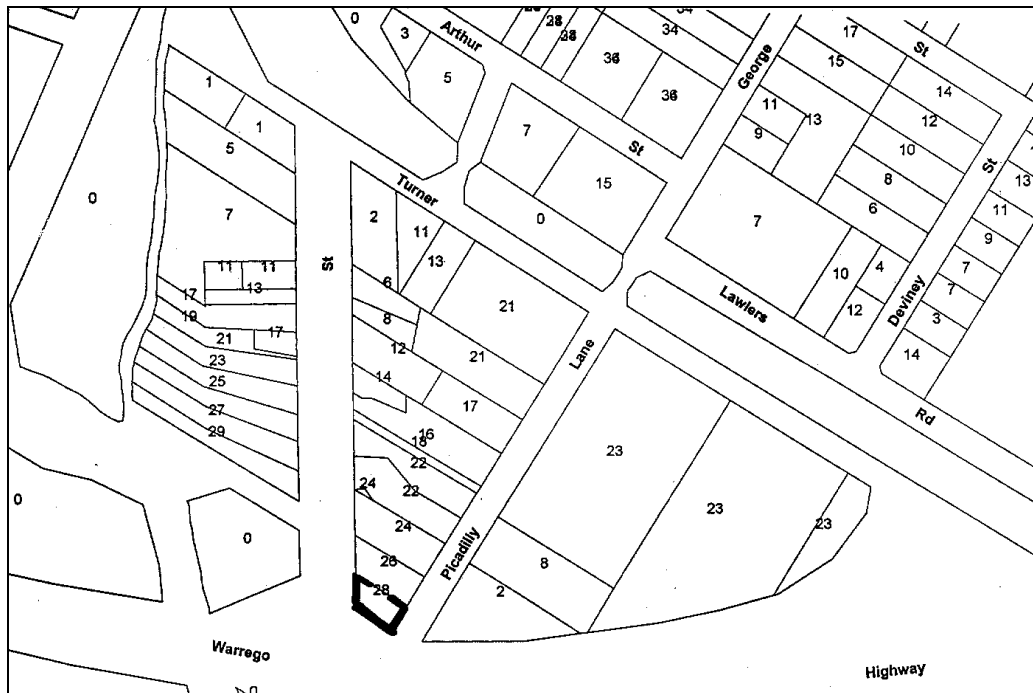

NOTE: This report has been prepared on the basis of evidence examined by the study team and seeks to identify the most important heritage values of the item. The purpose of this report is to provide an initial evaluation. If any action is planned which might affect the cultural heritage significance of this place, advice should be sought through the Gatton Shire Council Planning Branch.

NAME	(Currently Hand Crafts)
CATEGORY	Commercial building (shop)
LOCATION	26 Railway St Helidon
RPD	8RP23157
LISTING BOUNDARY	Whole of site
OTHER LISTINGS	-
SIGNIFICANCE LEVEL	Local

**History:** Believed to be an old saddlery

**Description:**

- Weatherboard clad gable ended shop with street facing gable.
- Bull-nose front street awning supported on timber posts with corner brackets.
- Much altered.

**Significance:**

The building is important for the evidence it contains of the traditional form, detailing and materials of a small shop.

It is important as a demonstration of the history of commercial activity in the Helidon community.

It contributes aesthetically to the streetscape.

**Associated Items:**

**References: Local residents**

**Comments: -**

NOTE: This report has been prepared on the basis of evidence examined by the study team and seeks to identify the most important heritage values of the item. The purpose of this report is to provide an initial evaluation. If any action is planned which might affect the cultural heritage significance of this place, advice should be sought through the Gatton Shire Council Planning Branch.



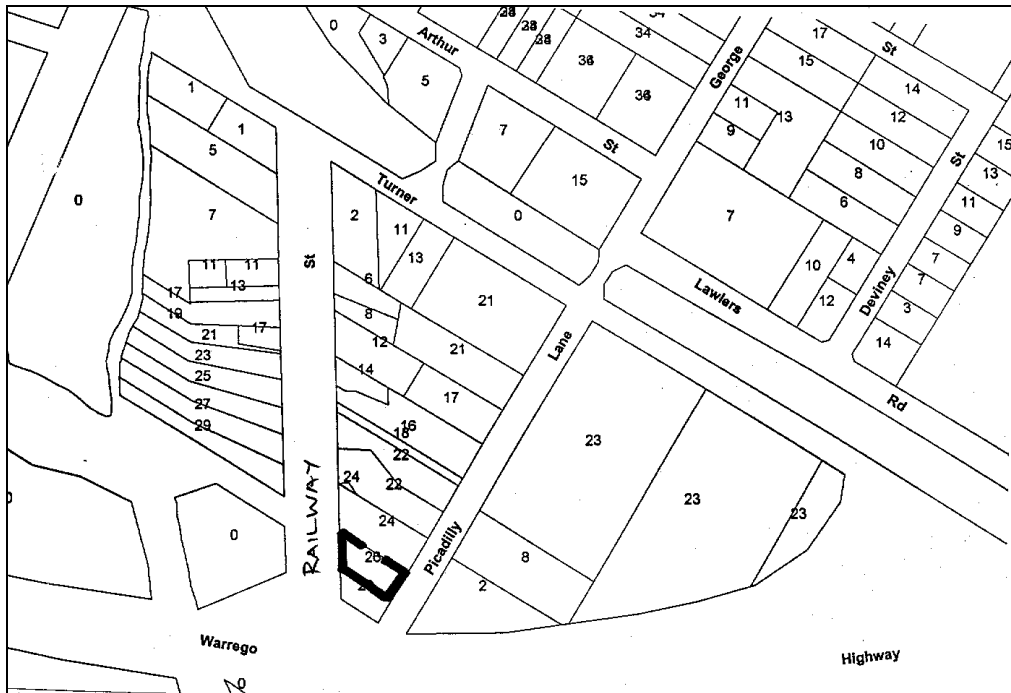

NOTE: This report has been prepared on the basis of evidence examined by the study team and seeks to identify the most important heritage values of the item. The purpose of this report is to provide an initial evaluation. If any action is planned which might affect the cultural heritage significance of this place, advice should be sought through the Gatton Shire Council Planning Branch.

NAME	-
CATEGORY	Commercial building (shop)
LOCATION	24 Railway St Helidon
RPD	7RP23156
LISTING BOUNDARY	Whole of site
OTHER LISTINGS	-
SIGNIFICANCE LEVEL	Local

**History:****Description:**

- Weatherboard clad gable ended shop with street facing gable.
- Street awning supported on timber posts infill detail intact.
- Dilapidated condition.

**Significance:**

The building is important for the evidence it contains of the traditional form, detailing and materials of a small shop.

It is important as a demonstration of the history of commercial activity in the Helidon community. It is a rare surviving example of its type in this area.

**Associated Items:****References:****Comments:**

NOTE: This report has been prepared on the basis of evidence examined by the study team and seeks to identify the most important heritage values of the item. The purpose of this report is to provide an initial evaluation. If any action is planned which might affect the cultural heritage significance of this place, advice should be sought through the Gatton Shire Council Planning Branch.



NOTE: This report has been prepared on the basis of evidence examined by the study team and seeks to identify the most important heritage values of the item. The purpose of this report is to provide an initial evaluation. If any action is planned which might affect the cultural heritage significance of this place, advice should be sought through the Gatton Shire Council Planning Branch.

NAME	Helidon Mechanical Services
CATEGORY	Commercial building (garage)
LOCATION	17 Railway St Helidon
RPD	1RP152150
LISTING BOUNDARY	Whole of site
OTHER LISTINGS	-
SIGNIFICANCE LEVEL	Recorded

**History:****Description:**

- C 1930s Corrugated iron clad mechanics shop and petrol pump with street facing gable, battened fibro infill.
- Newer left side wing addition.
- Large sliding tongue and groove doors to front elevation.
- Original condition.

**Significance:**

Recorded for the evidence it contains of the traditional form, detailing and materials of a small early garage.

Recorded as a demonstration of the history of commercial activity in the Helidon community.

**Associated Items:****References:****Comments:**

NOTE: This report has been prepared on the basis of evidence examined by the study team and seeks to identify the most important heritage values of the item. The purpose of this report is to provide an initial evaluation. If any action is planned which might affect the cultural heritage significance of this place, advice should be sought through the Gatton Shire Council Planning Branch.



NOTE: This report has been prepared on the basis of evidence examined by the study team and seeks to identify the most important heritage values of the item. The purpose of this report is to provide an initial evaluation. If any action is planned which might affect the cultural heritage significance of this place, advice should be sought through the Gatton Shire Council Planning Branch.

NAME	Laundromat
CATEGORY	Commercial building (shop) and attached house
LOCATION	16-18 Railway St Helidon
RPD	2RP189749 (16) and 2RP84646 (18)
LISTING BOUNDARY	Whole site
OTHER LISTINGS	-
SIGNIFICANCE LEVEL	local

**History:** Previously a butcher Shop

**Description:**

- Weatherboard clad gable ended shop with street parapet.
- Steeply pitched bull-nose front street awning supported on timber posts.
- Fixed timber vents along both sides for ventilation.

**Significance:**

The building is important for the evidence it contains of the traditional form, detailing and materials of a small shop.

It is important as a demonstration of the history of commercial activity in the Helidon community.

It contributes aesthetically to the streetscape.

**Associated Items:** House behind was for the proprietor.

**References:** Information from Mr McGovern

**Comments:**

NOTE: This report has been prepared on the basis of evidence examined by the study team and seeks to identify the most important heritage values of the item. The purpose of this report is to provide an initial evaluation. If any action is planned which might affect the cultural heritage significance of this place, advice should be sought through the Gatton Shire Council Planning Branch.





NOTE: This report has been prepared on the basis of evidence examined by the study team and seeks to identify the most important heritage values of the item. The purpose of this report is to provide an initial evaluation. If any action is planned which might affect the cultural heritage significance of this place, advice should be sought through the Gatton Shire Council Planning Branch.

NAME	Helidon Shopping Centre
CATEGORY	Commercial building (café)
LOCATION	14 Railway St Helidon
RPD	1RP199749
LISTING BOUNDARY	Whole site
OTHER LISTINGS	-
SIGNIFICANCE LEVEL	local

**History:****Description:**

- Pitched roof with large multi-paned window lantern light on top and weatherboard parapet to street elevation.
- Steeply pitched bull-nose front street awning supported on stop chamfered posts and iron valance. Similar to Laundromat
- Interior restored and clear finished ceiling highlights the good condition of the lantern light.
- Chamfer boards and aluminium windows and sliding doors to street entry.

**Significance:**

The building is important for the evidence it contains of the traditional form, detailing and materials of a substantial country town shop.

It is important as a demonstration of the history of commercial activity in the Helidon community.

**Associated Items:****References:****Comments:**

NOTE: This report has been prepared on the basis of evidence examined by the study team and seeks to identify the most important heritage values of the item. The purpose of this report is to provide an initial evaluation. If any action is planned which might affect the cultural heritage significance of this place, advice should be sought through the Gatton Shire Council Planning Branch.

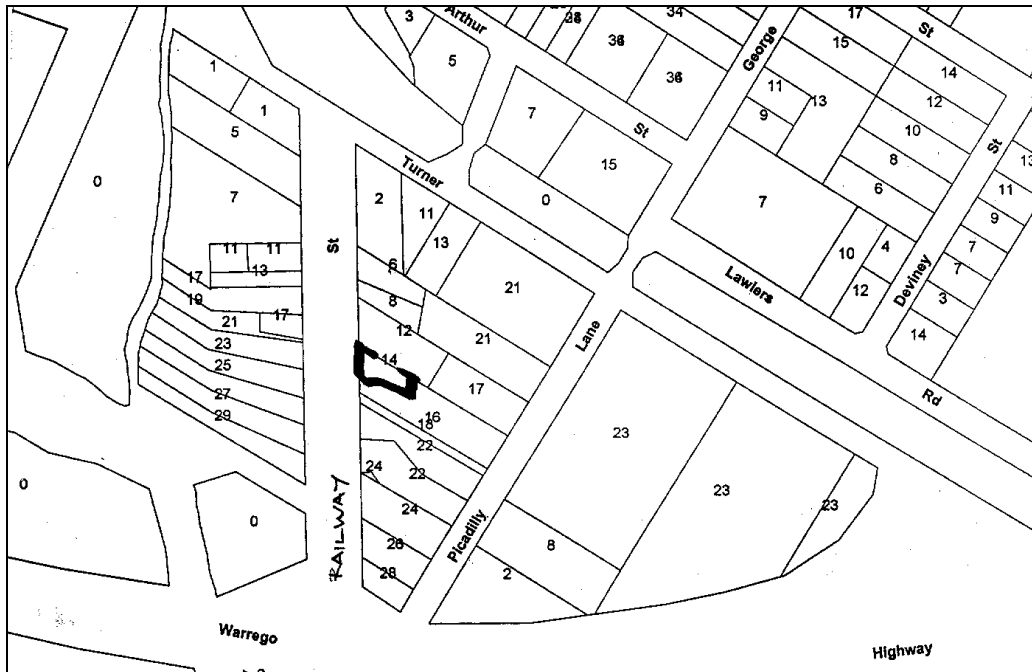

NOTE: This report has been prepared on the basis of evidence examined by the study team and seeks to identify the most important heritage values of the item. The purpose of this report is to provide an initial evaluation. If any action is planned which might affect the cultural heritage significance of this place, advice should be sought through the Gatton Shire Council Planning Branch.

NAME	
CATEGORY	House
LOCATION	9 School St Helidon
RPD	40RP214041
LISTING BOUNDARY	Whole of site
OTHER LISTINGS	-
SIGNIFICANCE LEVEL	Local

**History:****Description:**

- C1890s pyramid roof with right rear hip and stepped curved front verandah.
- Weatherboard clad.
- Few original windows and doors.
- Weatherboard enclosed front verandah with 1950s casement windows.

**Significance:**

Important for its demonstration of early form and materials and for its demonstration of early building techniques.

**Associated Items:****References:****Comments:**

NOTE: This report has been prepared on the basis of evidence examined by the study team and seeks to identify the most important heritage values of the item. The purpose of this report is to provide an initial evaluation. If any action is planned which might affect the cultural heritage significance of this place, advice should be sought through the Gatton Shire Council Planning Branch.

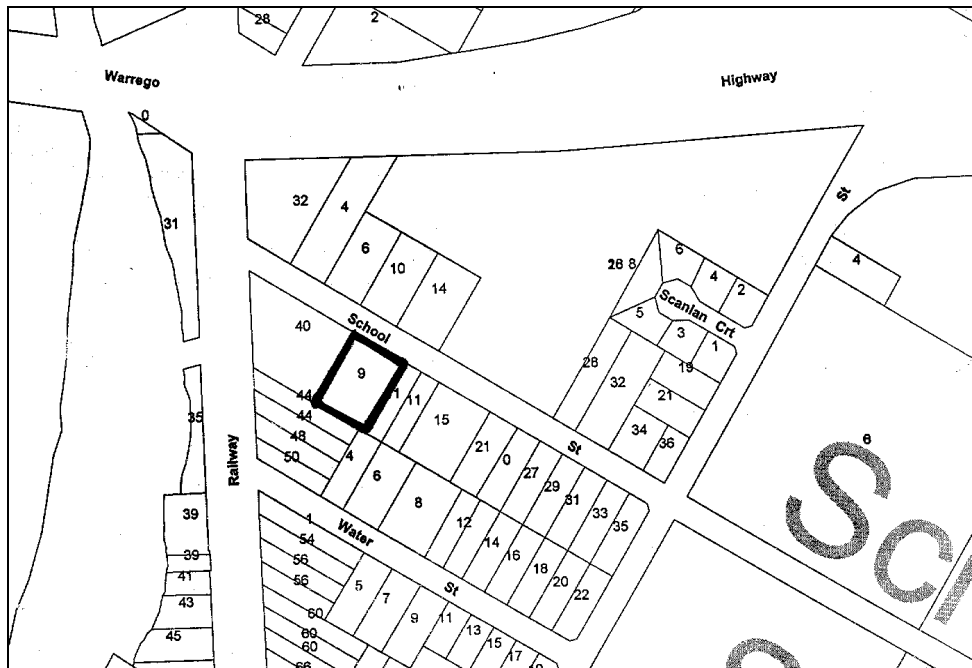

NOTE: This report has been prepared on the basis of evidence examined by the study team and seeks to identify the most important heritage values of the item. The purpose of this report is to provide an initial evaluation. If any action is planned which might affect the cultural heritage significance of this place, advice should be sought through the Gatton Shire Council Planning Branch.

NAME	-
CATEGORY	House
LOCATION	32 School St Helidon
RPD	18RP203794
LISTING BOUNDARY	Whole site
OTHER LISTINGS	-
SIGNIFICANCE LEVEL	Local

**History:****Description:**

- Asymmetrical bungalow with slightly off centre boxed and jettied gable and pyramid main roof.
- Slat balustrade on entrance verandah.
- Lobby window to vestibule entry off verandah.
- Weatherboard balustrade and refurbished aluminium sliding windows over to enclose sleep-out area on right of gable.
- Mini orb iron and timber slatted hood over bank of four casement windows on front and side elevations
- Refurbished and enclosed under.

**Significance:**

The house is significant as a good example of the use of materials, form and detailing typical of the interwar period.

The house, with its surrounding garden, makes an aesthetic contribution to the streetscape.

**Associated Items:****References:****Comments:**

NOTE: This report has been prepared on the basis of evidence examined by the study team and seeks to identify the most important heritage values of the item. The purpose of this report is to provide an initial evaluation. If any action is planned which might affect the cultural heritage significance of this place, advice should be sought through the Gatton Shire Council Planning Branch.



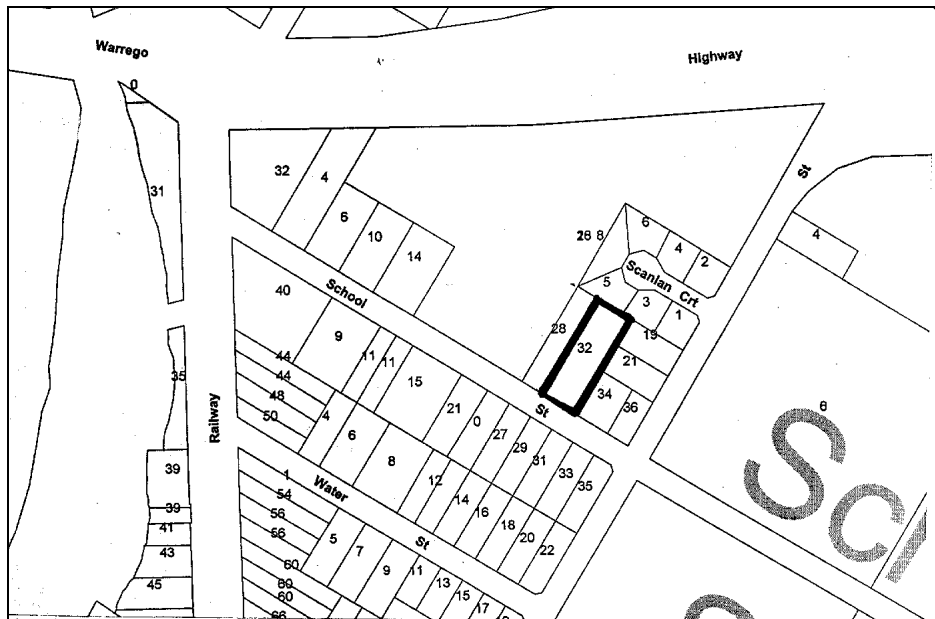

NOTE: This report has been prepared on the basis of evidence examined by the study team and seeks to identify the most important heritage values of the item. The purpose of this report is to provide an initial evaluation. If any action is planned which might affect the cultural heritage significance of this place, advice should be sought through the Gatton Shire Council Planning Branch.

NAME	-
CATEGORY	House
LOCATION	28 School Rd Helidon
RPD	17RP203794
LISTING BOUNDARY	Whole site
OTHER LISTINGS	-
SIGNIFICANCE LEVEL	Local

**History:****Description:**

- C1890s style pyramid roof and asymmetrical gable.
- Stepped bullnose front verandah with pediment over entry stair and skillion rear verandah.
- Weatherboard clad.
- Original windows and doors with coloured glass sidelights.
- Two-rail slat balustrade.
- Original windows and curved metal sunhoods to main core.
- Low-set on timber stumps, batten infill.

**Significance:**

Important for its demonstration of aesthetic characteristics and building techniques typical of the late 19<sup>th</sup>/early 20<sup>th</sup> century.

The house, with its surrounding trees and garden, contributes aesthetically to the streetscape.

**Associated Items:****References:****Comments:**

NOTE: This report has been prepared on the basis of evidence examined by the study team and seeks to identify the most important heritage values of the item. The purpose of this report is to provide an initial evaluation. If any action is planned which might affect the cultural heritage significance of this place, advice should be sought through the Gatton Shire Council Planning Branch.

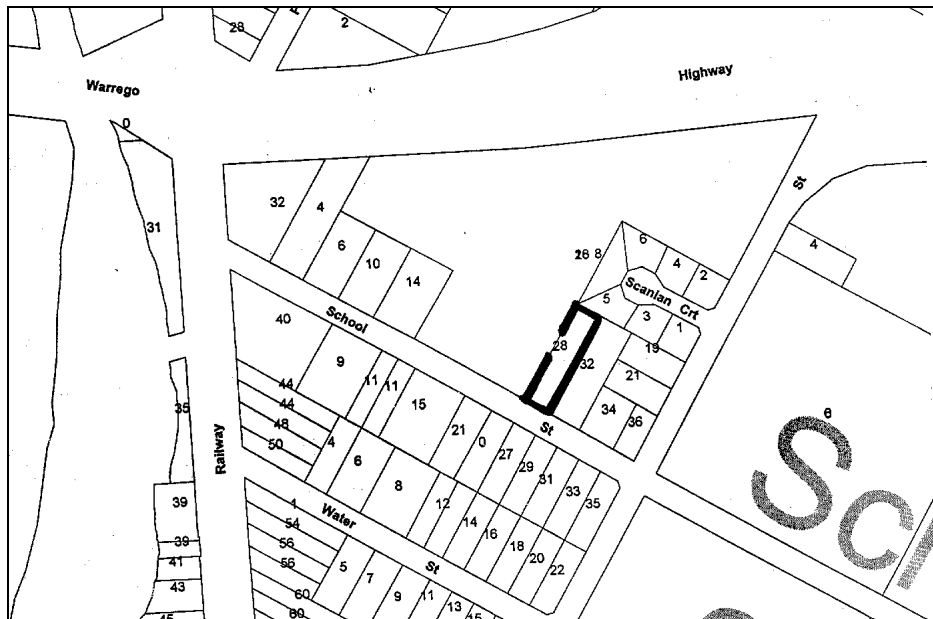

NOTE: This report has been prepared on the basis of evidence examined by the study team and seeks to identify the most important heritage values of the item. The purpose of this report is to provide an initial evaluation. If any action is planned which might affect the cultural heritage significance of this place, advice should be sought through the Gatton Shire Council Planning Branch.

NAME	-
CATEGORY	House
LOCATION	32 Railway St Helidon
RPD	12RP840606
LISTING BOUNDARY	Whole site
OTHER LISTINGS	-
SIGNIFICANCE LEVEL	Local

**History:** Believed to be one of the oldest houses in this area.

**Description:**

- C1890s style pyramid roof and stepped curved front and side verandahs as well as skillion rear verandah.
- Separate kitchen enclosed rear verandah breezeway
- Weatherboard clad generally, clear finished chamfer boards to verandah area.
- Original windows and doors.
- Two-rail slatted balustrade.

**Significance:**

Important for its demonstration of aesthetic characteristics and building techniques typical of the late 19<sup>th</sup>/early 20<sup>th</sup> century.

The house, with its surrounding trees and garden, contributes aesthetically to the streetscape/rural landscape.

**Associated Items:**

**References: Local information**

**Comments:**

NOTE: This report has been prepared on the basis of evidence examined by the study team and seeks to identify the most important heritage values of the item. The purpose of this report is to provide an initial evaluation. If any action is planned which might affect the cultural heritage significance of this place, advice should be sought through the Gatton Shire Council Planning Branch.



NOTE: This report has been prepared on the basis of evidence examined by the study team and seeks to identify the most important heritage values of the item. The purpose of this report is to provide an initial evaluation. If any action is planned which might affect the cultural heritage significance of this place, advice should be sought through the Gatton Shire Council Planning Branch.

## HELIDON (PART 2)

St Paul's Lutheran Church, 60 Railway St Helidon	362
House, 54 Railway St Helidon	364
House, 56 Railway St Helidon	366
House, 72 Lockyer Ck Rd Helidon	368
"Glencoe", Sandy Creek Rd Helidon	370
Helidon Cemetery, Cemetery Rd Helidon	374
House, 37/39 Railway St Helidon	376
House, 41 Railway St Helidon	378
House, 43 Railway St Helidon	380
House, 45 Railway St Helidon	382
House, 53 Railway St Helidon	384
House, 14 Lawlers Rd Helidon	386
"Trenton Farm", Lawlers Rd Helidon	388
Farmhouse, Lawlers Rd Helidon	390
House, 31 Station Rd Helidon	392
House, 23 Station Rd Helidon	394
House, 30 Laidley St Helidon	396
House, 22 Station Rd Helidon	398
House, 18 Station Rd Helidon	400
House, 24 Station Rd Helidon	402
"Lazy Acres", 36 Laidley Rd Helidon	404
House, 35 Laidley Rd Helidon	406
House, 24 Bowen St Helidon	408
House, 28 George St Helidon	410
House, 26 Bowen St Helidon	412
House, 8 Deviney St Helidon	414
House, 15 Deviney St Helidon	416
House, 15 George St Helidon	418
St Joseph's Catholic Church complex, Gunn St Helidon	420
Former St Joseph's Convent, Gunn St Helidon	426
Catholic Cemetery, Helidon Dip Road	428
Helidon Tennis Club (former Clarendon School), Arthur St Helidon	430
House, 13 Bowen St	432
House, 16 Station Rd Helidon	434
Shop, Railway St Helidon	436
Alice Creek Gold Mine, Off Gold Mine Rd (which is off Seventeen Mile Rd)	438

NOTE: This report has been prepared on the basis of evidence examined by the study team and seeks to identify the most important heritage values of the item. The purpose of this report is to provide an initial evaluation. If any action is planned which might affect the cultural heritage significance of this place, advice should be sought through the Gatton Shire Council Planning Branch.



NAME	St Paul's Lutheran Church
CATEGORY	Church
LOCATION	60 Railway St Helidon
RPD	27, 28, 29 and 30 of RP23148
LISTING BOUNDARY	Whole site
OTHER LISTINGS	
SIGNIFICANCE LEVEL	Local

**History:****Description:**

- Rectangular plan with pitched roof and gable ends.
- Centred front entry gable.
- Weatherboard clad
- Casement windows with coloured glass in the form of a Latin cross
- Lancet shaped windows to side elevations
- Timber stumps

**Significance:**

Significant as a good example of a simple church.

It is important in exhibiting a range of aesthetic characteristics valued by the local community, in particular the building's traditional form, scale and materials.

Important for its contribution to the streetscape.

It has a strong association with the spiritual and social life of the surrounding community.

**Associated Items:****References:****Comments:**

NOTE: This report has been prepared on the basis of evidence examined by the study team and seeks to identify the most important heritage values of the item. The purpose of this report is to provide an initial evaluation. If any action is planned which might affect the cultural heritage significance of this place, advice should be sought through the Gatton Shire Council Planning Branch.



NOTE: This report has been prepared on the basis of evidence examined by the study team and seeks to identify the most important heritage values of the item. The purpose of this report is to provide an initial evaluation. If any action is planned which might affect the cultural heritage significance of this place, advice should be sought through the Gatton Shire Council Planning Branch.

NAME	-
CATEGORY	House
LOCATION	54 Railway St Helidon
RPD	25RP23418
LISTING BOUNDARY	Whole of site
OTHER LISTINGS	
SIGNIFICANCE LEVEL	Local

**History:****Description:**

- Victorian pyramid roof and stepped front verandah.
- Few original doors and windows
- Replacement balustrade.
- Chamfer board clad.
- Bullnose iron window hoods.

**Significance:**

Important for its demonstration of early form and materials and for its demonstration of early building techniques.

**Associated Items:****References:****Comments:**

NOTE: This report has been prepared on the basis of evidence examined by the study team and seeks to identify the most important heritage values of the item. The purpose of this report is to provide an initial evaluation. If any action is planned which might affect the cultural heritage significance of this place, advice should be sought through the Gatton Shire Council Planning Branch.



NOTE: This report has been prepared on the basis of evidence examined by the study team and seeks to identify the most important heritage values of the item. The purpose of this report is to provide an initial evaluation. If any action is planned which might affect the cultural heritage significance of this place, advice should be sought through the Gatton Shire Council Planning Branch.

NAME	-
CATEGORY	House
LOCATION	56 Railway St Helidon
RPD	25RP23148
LISTING BOUNDARY	whole site
OTHER LISTINGS	
SIGNIFICANCE LEVEL	Local

**History:****Description:**

- 1890s style pyramid roof and stepped curved verandahs to three sides.
- Single skin exposed stud horizontal lapped boards.
- Original doors and windows
- Verandah enclosed, evidence of the earlier verandah detailing remains at the front entry.
- Weatherboard clad.
- High set with timber stumps

**Significance:**

Important for its demonstration of aesthetic characteristics and building techniques typical of the late 19<sup>th</sup>/early 20<sup>th</sup> century.

The house, with its surrounding trees, contributes aesthetically to the streetscape.

**Associated Items:****References:****Comments:**

NOTE: This report has been prepared on the basis of evidence examined by the study team and seeks to identify the most important heritage values of the item. The purpose of this report is to provide an initial evaluation. If any action is planned which might affect the cultural heritage significance of this place, advice should be sought through the Gatton Shire Council Planning Branch.





NOTE: This report has been prepared on the basis of evidence examined by the study team and seeks to identify the most important heritage values of the item. The purpose of this report is to provide an initial evaluation. If any action is planned which might affect the cultural heritage significance of this place, advice should be sought through the Gatton Shire Council Planning Branch.



NAME	-
CATEGORY	House
LOCATION	72 Lockyer Ck Rd Helidon
RPD	16RP208715
LISTING BOUNDARY	Whole site
OTHER LISTINGS	-
SIGNIFICANCE LEVEL	Local

**History:****Description:**

- 1880s style pyramid roof and stepped curved verandahs to three sides.
- Original broomstick balustrade with rectangular section handrail.
- Stop chamfered posts with capitals and ornate corner brackets.
- Original doors and windows.
- Lower level (sub-floor) enclosed
- Weatherboard clad, high set with timber stumps
- Several large mature trees in garden including tall bunya pine

**Significance:**

Important for its demonstration of aesthetic characteristics and building techniques typical of the late 19<sup>th</sup>/early 20<sup>th</sup> century.

The house, with its surrounding trees, contributes aesthetically to the streetscape.

**Associated Items:****References:****Comments:**

NOTE: This report has been prepared on the basis of evidence examined by the study team and seeks to identify the most important heritage values of the item. The purpose of this report is to provide an initial evaluation. If any action is planned which might affect the cultural heritage significance of this place, advice should be sought through the Gatton Shire Council Planning Branch.

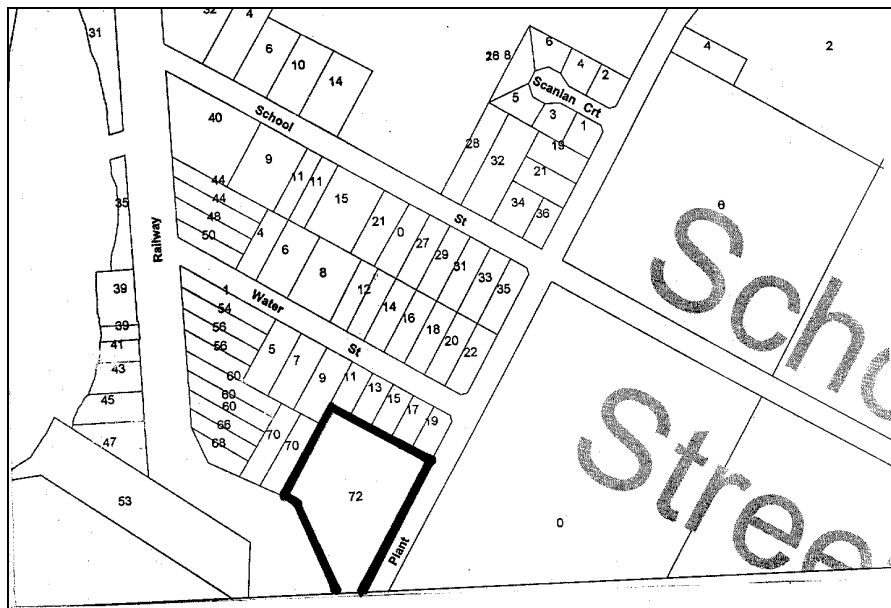

NOTE: This report has been prepared on the basis of evidence examined by the study team and seeks to identify the most important heritage values of the item. The purpose of this report is to provide an initial evaluation. If any action is planned which might affect the cultural heritage significance of this place, advice should be sought through the Gatton Shire Council Planning Branch.

NOTE: This report has been prepared on the basis of evidence examined by the study team and seeks to identify the most important heritage values of the item. The purpose of this report is to provide an initial evaluation. If any action is planned which might affect the cultural heritage significance of this place, advice should be sought through the Gatton Shire Council Planning Branch.

NAME	Glencoe
CATEGORY	Farm house - Orchard
LOCATION	Sandy Creek Rd Helidon
RPD	2RP78123
LISTING BOUNDARY	House site
OTHER LISTINGS	-
SIGNIFICANCE LEVEL	House local; outbuildings recorded

**History:**

- Sam Philp settled here after the first world war
- Operated as an orchard growing oranges and other citrus fruit.
- The old and large orange trees were removed during the 1980s when it became unprofitable to produce due to competition from overseas imports. The larger trees made the fruit more difficult to pick and there were difficulties obtaining labourers.

**Description:**House

- C1910 main core long ridge and skillion stepped verandah.
- C1930s gable addition.
- The main core is constructed with single skin vertical tongue and groove boards.
- Two rail broomstick balustrade on two sides.
- Stop chamfered posts with ornate corner brackets
- Many original doors and windows.

Outbuildings and grounds

- Original gable ended weatherboard cottage in disrepair located adjacent to house and shed.
- Original slab shed probably used as a processing shed for the harvested fruit.
- Two large Plane trees planted in 1913 located at the rear of the main house.

**Significance:**

Important for its demonstration of aesthetic characteristics and building techniques typical of the late 19<sup>th</sup>/early 20<sup>th</sup> century.

Important for its historical association with the fruit industry.

**Associated Items:****References:**

Historical information from current owner.

**Comments:**

NOTE: This report has been prepared on the basis of evidence examined by the study team and seeks to identify the most important heritage values of the item. The purpose of this report is to provide an initial evaluation. If any action is planned which might affect the cultural heritage significance of this place, advice should be sought through the Gatton Shire Council Planning Branch.





NOTE: This report has been prepared on the basis of evidence examined by the study team and seeks to identify the most important heritage values of the item. The purpose of this report is to provide an initial evaluation. If any action is planned which might affect the cultural heritage significance of this place, advice should be sought through the Gatton Shire Council Planning Branch.



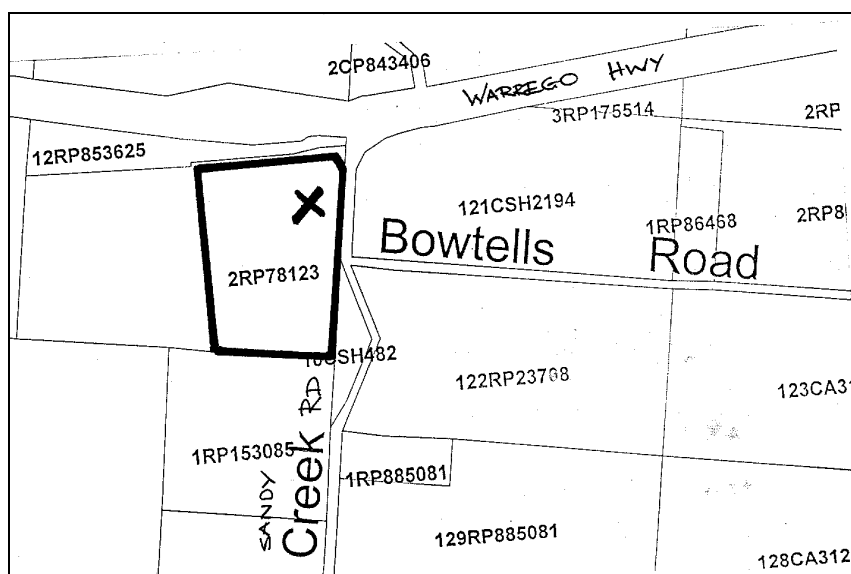

NOTE: This report has been prepared on the basis of evidence examined by the study team and seeks to identify the most important heritage values of the item. The purpose of this report is to provide an initial evaluation. If any action is planned which might affect the cultural heritage significance of this place, advice should be sought through the Gatton Shire Council Planning Branch.



NAME	Helidon Cemetery
CATEGORY	Cemetery
LOCATION	Cemetery Rd Helidon
RPD	3RP186019
LISTING BOUNDARY	Whole site
OTHER LISTINGS	-
SIGNIFICANCE LEVEL	Local

**History:**

- Brass Plaque dedicated in 1976 – “This plaque has been erected to honour the Devine Family for their generosity to the Helidon Cemetery 1976.”

**Description:**

- Headstones dating from late 1800s
- 1930s shelter shed on site
- Within sight of the Warrego Highway.

**Significance:**

Important for its demonstration of the characteristics of a small country cemetery;

for its association with the social and spiritual evolution of the surrounding district;

and for its ability to yield information on local social history and the individual family histories of local residents.

**Associated Items:****References:****Comments:**

NOTE: This report has been prepared on the basis of evidence examined by the study team and seeks to identify the most important heritage values of the item. The purpose of this report is to provide an initial evaluation. If any action is planned which might affect the cultural heritage significance of this place, advice should be sought through the Gatton Shire Council Planning Branch.

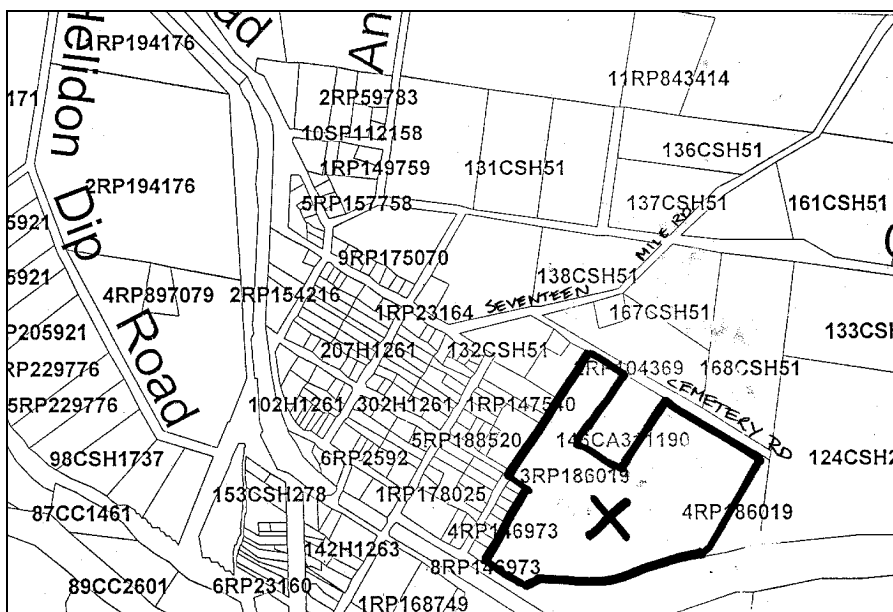

NOTE: This report has been prepared on the basis of evidence examined by the study team and seeks to identify the most important heritage values of the item. The purpose of this report is to provide an initial evaluation. If any action is planned which might affect the cultural heritage significance of this place, advice should be sought through the Gatton Shire Council Planning Branch.

NAME	
CATEGORY	House
LOCATION	37/39 Railway St Helidon
RPD	L1-2CSH2483
LISTING BOUNDARY	Whole site
OTHER LISTINGS	-
SIGNIFICANCE LEVEL	Local

**History:****Description:**

- Core appears to be c1880.
- Pitched roof with gable ends.
- Incorporated front and rear verandahs, enclosed
- Weatherboard clad
- Much altered with aluminium windows and awnings

**Significance:**

Important for its demonstration of aesthetic characteristics and building techniques typical of the late 19<sup>th</sup>/early 20<sup>th</sup> century.

The house, with its surrounding trees and gardens, contributes aesthetically to the streetscape of Helidon.

**Associated Items:****References:**

**Comments:** There are a number of houses of similar style and age in this street

NOTE: This report has been prepared on the basis of evidence examined by the study team and seeks to identify the most important heritage values of the item. The purpose of this report is to provide an initial evaluation. If any action is planned which might affect the cultural heritage significance of this place, advice should be sought through the Gatton Shire Council Planning Branch.



No 39

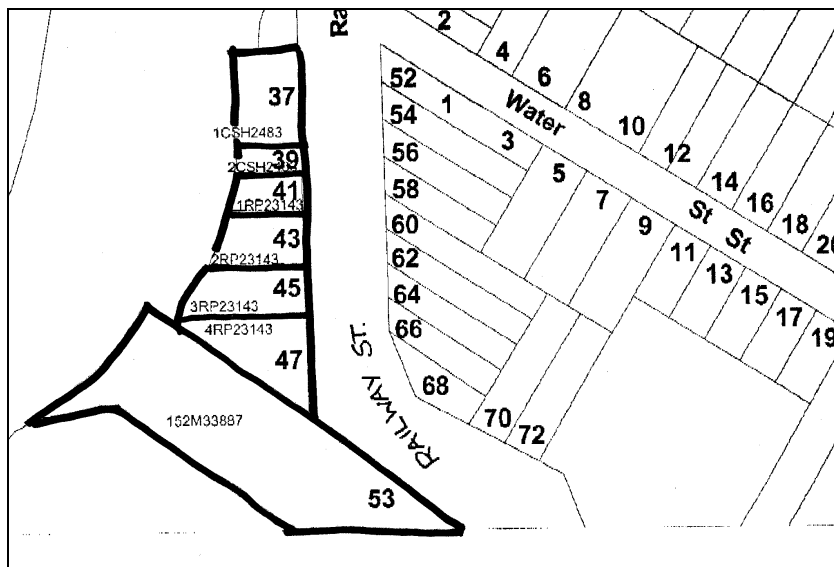

NOTE: This report has been prepared on the basis of evidence examined by the study team and seeks to identify the most important heritage values of the item. The purpose of this report is to provide an initial evaluation. If any action is planned which might affect the cultural heritage significance of this place, advice should be sought through the Gatton Shire Council Planning Branch.

NAME	
CATEGORY	House
LOCATION	41 Railway St Helidon
RPD	L1RP23143
LISTING BOUNDARY	Whole site
OTHER LISTINGS	-
SIGNIFICANCE LEVEL	Local

**History:****Description:**

- Core thought to be C1880.
- Steeply pitched roof with gable ends.
- Incorporated front and rear verandahs, enclosed
- Weatherboard clad
- Much altered with aluminium windows
- Recent right side pergola structure

**Significance:**

Important for its demonstration of aesthetic characteristics and building techniques typical of the late 19<sup>th</sup>/early 20<sup>th</sup> century.

The house, with its surrounding trees and gardens, contributes aesthetically to the streetscape of Helidon.

**Associated Items:****References:**

**Comments:** There are a number of houses of similar style and age in this street

NOTE: This report has been prepared on the basis of evidence examined by the study team and seeks to identify the most important heritage values of the item. The purpose of this report is to provide an initial evaluation. If any action is planned which might affect the cultural heritage significance of this place, advice should be sought through the Gatton Shire Council Planning Branch.



No 41

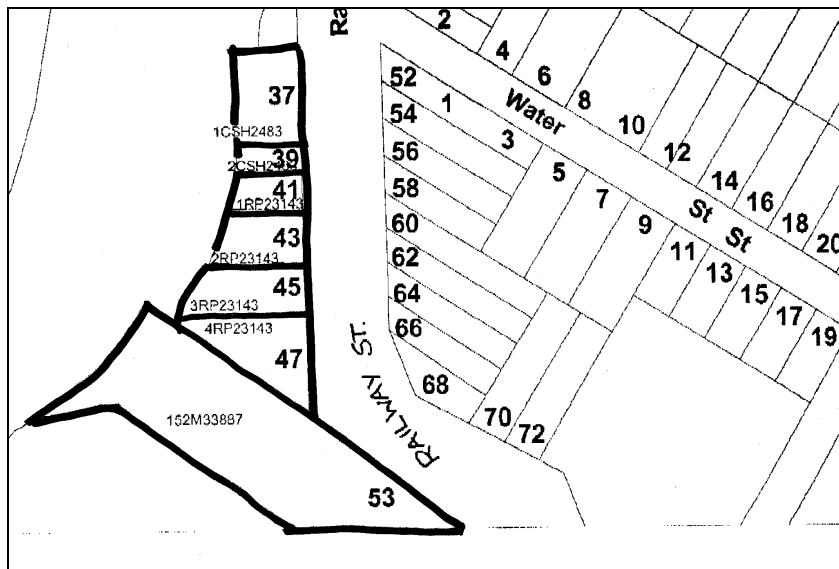

NOTE: This report has been prepared on the basis of evidence examined by the study team and seeks to identify the most important heritage values of the item. The purpose of this report is to provide an initial evaluation. If any action is planned which might affect the cultural heritage significance of this place, advice should be sought through the Gatton Shire Council Planning Branch.



NAME	
CATEGORY	House
LOCATION	43 Railway St Helidon
RPD	2RP23143
LISTING BOUNDARY	Whole site
OTHER LISTINGS	-
SIGNIFICANCE LEVEL	Local

**History:****Description:**

- Core thought to be C1880.
- Pitched roof with gable ends.
- Incorporated front and rear verandahs, enclosed possibly 1930s with casement windows
- Weatherboard clad
- Original sash windows and an iron window hood on each side remains.

**Significance:**

Important for its demonstration of aesthetic characteristics and building techniques typical of the late 19<sup>th</sup>/early 20<sup>th</sup> century.

The house, with its surrounding trees and gardens, contributes aesthetically to the streetscape of Helidon.

**Associated Items:****References:**

**Comments:** There are a number of houses of similar style and age in this street

NOTE: This report has been prepared on the basis of evidence examined by the study team and seeks to identify the most important heritage values of the item. The purpose of this report is to provide an initial evaluation. If any action is planned which might affect the cultural heritage significance of this place, advice should be sought through the Gatton Shire Council Planning Branch.



No 43

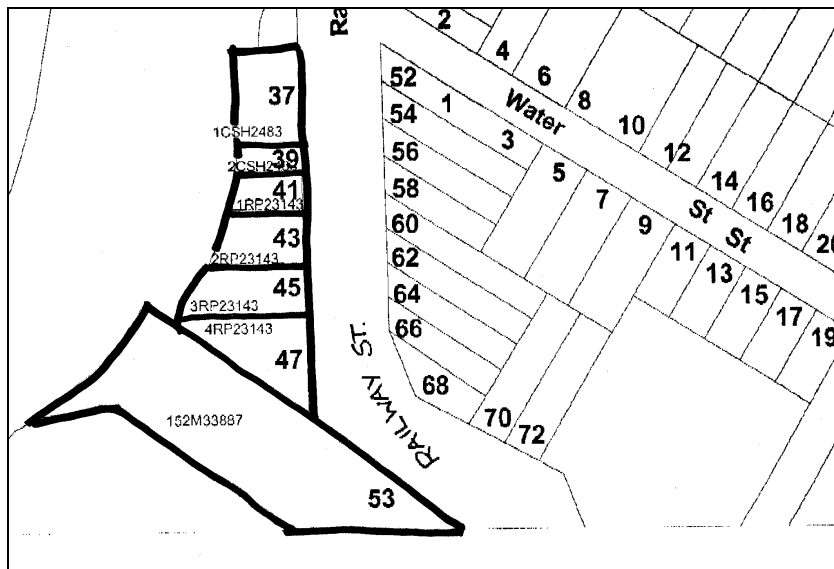

NOTE: This report has been prepared on the basis of evidence examined by the study team and seeks to identify the most important heritage values of the item. The purpose of this report is to provide an initial evaluation. If any action is planned which might affect the cultural heritage significance of this place, advice should be sought through the Gatton Shire Council Planning Branch.

NAME	
CATEGORY	House
LOCATION	45 Railway St Helidon
RPD	L3RP23143
LISTING BOUNDARY	Whole site
OTHER LISTINGS	-
SIGNIFICANCE LEVEL	Local

**History:****Description:**

- Core appears to be c1880.
- Short ridge hip roof.
- Stepped front and rear verandahs, enclosed possibly 1930s with casement windows
- Weatherboard clad

**Significance:**

Important for its demonstration of aesthetic characteristics and building techniques typical of the late 19<sup>th</sup>/early 20<sup>th</sup> century.

The house, with its surrounding trees and gardens, contributes aesthetically to the streetscape of Helidon.

**Associated Items:****References:**

**Comments:** There are a number of houses of similar style and age in this street

NOTE: This report has been prepared on the basis of evidence examined by the study team and seeks to identify the most important heritage values of the item. The purpose of this report is to provide an initial evaluation. If any action is planned which might affect the cultural heritage significance of this place, advice should be sought through the Gatton Shire Council Planning Branch.



No 45

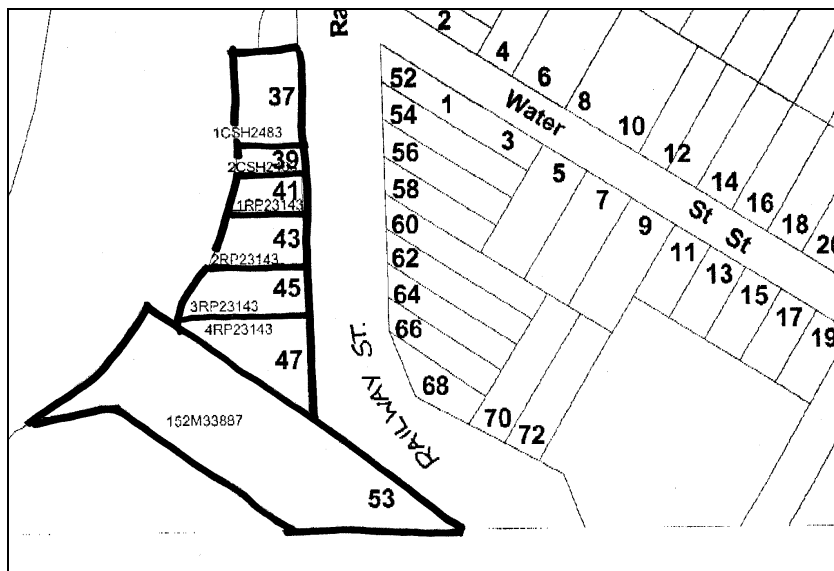

NOTE: This report has been prepared on the basis of evidence examined by the study team and seeks to identify the most important heritage values of the item. The purpose of this report is to provide an initial evaluation. If any action is planned which might affect the cultural heritage significance of this place, advice should be sought through the Gatton Shire Council Planning Branch.

NAME	
CATEGORY	House
LOCATION	53 Railway St Helidon
RPD	L4RP2314 and L152M33887
LISTING BOUNDARY	Whole site
OTHER LISTINGS	-
SIGNIFICANCE LEVEL	recorded

**History:****Description:**

- Core appears to be c1880.
- Short ridge pyramid roof.
- Stepped verandahs to all sides, enclosed possibly 1930s with casement windows and weatherboard balustrade
- Chimney and fireplace
- Surrounded by old farm sheds and equipment

**Significance:**

Recorded for its demonstration of aesthetic characteristics and building techniques typical of the late 19<sup>th</sup>/early 20<sup>th</sup> century.

The house, with its surrounding trees and gardens, contributes aesthetically to the streetscape of Helidon.

**Associated Items:****References:**

**Comments:** There are a number of houses of similar style and age in this street

NOTE: This report has been prepared on the basis of evidence examined by the study team and seeks to identify the most important heritage values of the item. The purpose of this report is to provide an initial evaluation. If any action is planned which might affect the cultural heritage significance of this place, advice should be sought through the Gatton Shire Council Planning Branch.



No 53

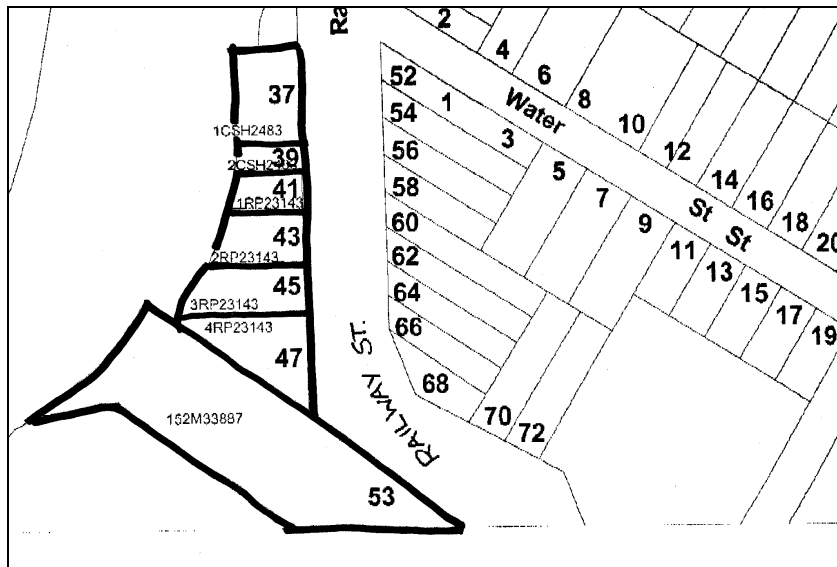

NOTE: This report has been prepared on the basis of evidence examined by the study team and seeks to identify the most important heritage values of the item. The purpose of this report is to provide an initial evaluation. If any action is planned which might affect the cultural heritage significance of this place, advice should be sought through the Gatton Shire Council Planning Branch.



NAME	-
CATEGORY	House
LOCATION	14 Lawlers Rd Helidon
RPD	8RP146973
LISTING BOUNDARY	Whole site
OTHER LISTINGS	-
SIGNIFICANCE LEVEL	Local

**History:****Description:**

- C1890s style pyramid roofed with stepped bullnose verandah.
- Curved metal window hoods.
- Original doors and windows.
- Replaced slatted balustrade and restumped with steel posts.
- Old picket fence.
- Separate outdoor toilet.

**Significance:**

Important for its demonstration of aesthetic characteristics and building techniques typical of the late 19<sup>th</sup>/early 20<sup>th</sup> century.

The house, with its surrounding trees and garden, contributes aesthetically to the streetscape.

**Associated Items:****References:****Comments:**

NOTE: This report has been prepared on the basis of evidence examined by the study team and seeks to identify the most important heritage values of the item. The purpose of this report is to provide an initial evaluation. If any action is planned which might affect the cultural heritage significance of this place, advice should be sought through the Gatton Shire Council Planning Branch.

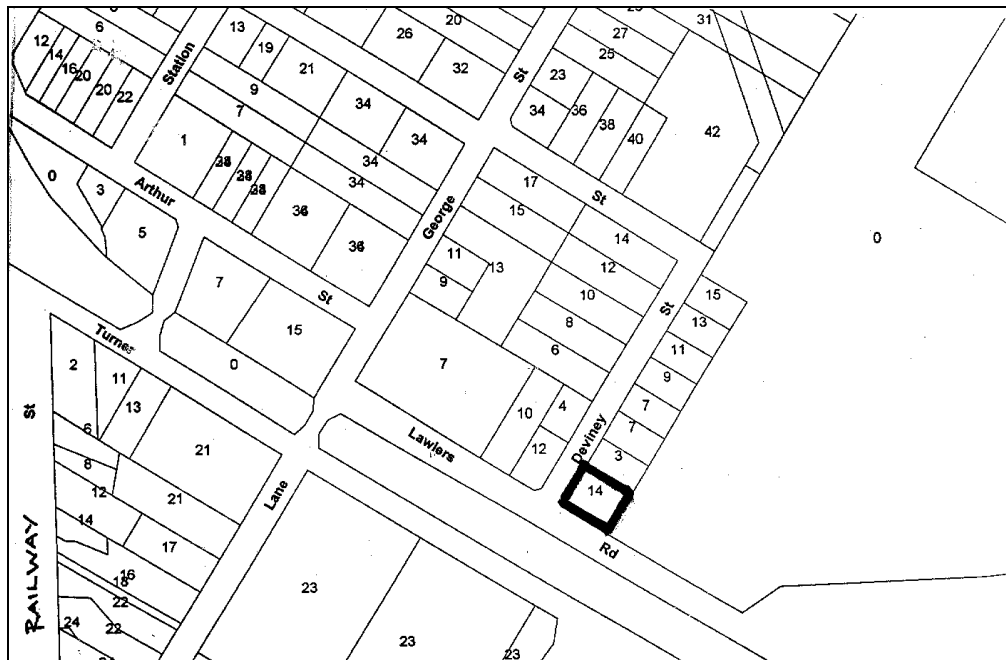

NOTE: This report has been prepared on the basis of evidence examined by the study team and seeks to identify the most important heritage values of the item. The purpose of this report is to provide an initial evaluation. If any action is planned which might affect the cultural heritage significance of this place, advice should be sought through the Gatton Shire Council Planning Branch.

NAME	Trenton Farm
CATEGORY	House
LOCATION	Lawlers Rd Helidon
RPD	3RP207914
LISTING BOUNDARY	House area
OTHER LISTINGS	-
SIGNIFICANCE LEVEL	Local

**History:**

- Relocated 1991 from Coorparoo.

**Description:**

- Short ridge pyramid roofed bungalow with incorporated verandahs.
- Front verandah refurbished, side verandah enclosed.
- Original doors and windows.
- Intact window hoods.
- Low set on timber stumps
- Post and rail fence.

**Significance:**

Important for its demonstration of early form and materials and for its demonstration of early building techniques.

The house, with its surrounding garden, contributes aesthetically to the streetscape.

As a removal house, it demonstrates the pattern of history of Gatton Shire and its development.

**Associated Items:****References:**

Historical information from current owner.

**Comments:**

NOTE: This report has been prepared on the basis of evidence examined by the study team and seeks to identify the most important heritage values of the item. The purpose of this report is to provide an initial evaluation. If any action is planned which might affect the cultural heritage significance of this place, advice should be sought through the Gatton Shire Council Planning Branch.

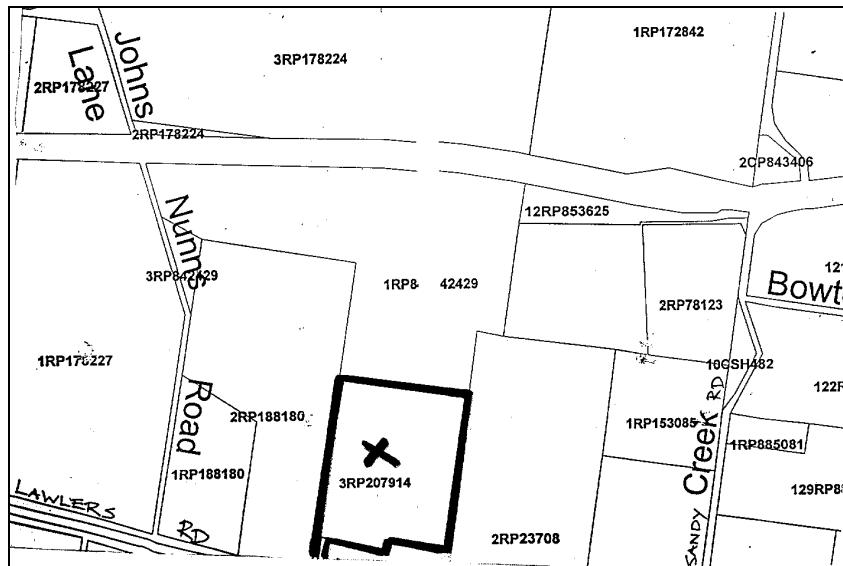

NOTE: This report has been prepared on the basis of evidence examined by the study team and seeks to identify the most important heritage values of the item. The purpose of this report is to provide an initial evaluation. If any action is planned which might affect the cultural heritage significance of this place, advice should be sought through the Gatton Shire Council Planning Branch.

NAME	-
CATEGORY	Farm house
LOCATION	Lawlers Rd Helidon
RPD	1RP186020
LISTING BOUNDARY	house site
OTHER LISTINGS	-
SIGNIFICANCE LEVEL	House local; outbuildings recorded

**History:****Description:**

- C1890s style pyramid roofed with stepped verandahs on three sides.
- Two side verandahs enclosed with weatherboards.
- Some original doors and windows.
- Highset on timber stumps.
- 1930s style rear gabled extension.
- Large tank and stand and various outbuildings including a windmill, post and rail cattle yards and butchery.

**Significance:**

Important for its demonstration of aesthetic characteristics and building techniques typical of the late 19<sup>th</sup>/early 20<sup>th</sup> century.

The house, with its surrounding trees, garden and farm buildings, contributes aesthetically to the rural landscape.

**Associated Items:****References:****Comments:**

NOTE: This report has been prepared on the basis of evidence examined by the study team and seeks to identify the most important heritage values of the item. The purpose of this report is to provide an initial evaluation. If any action is planned which might affect the cultural heritage significance of this place, advice should be sought through the Gatton Shire Council Planning Branch.





NAME	
CATEGORY	House
LOCATION	31 Station Rd Helidon
RPD	314H1261
LISTING BOUNDARY	whole site
OTHER LISTINGS	-
SIGNIFICANCE LEVEL	Local

**History:****Description:**

- Pyramid roof with stepped skillion verandah.
- Large gable probably original, small gable over entrance porch with 3 casement windows possibly a later alteration
- Weatherboard balustrade to verandah, enclosed with aluminium frame windows.

**Significance:**

Important for its demonstration of early form and materials and for its demonstration of early building techniques.

Makes a contribution to the aesthetics of the streetscape.

**Associated Items:****References:**

Comments:

NOTE: This report has been prepared on the basis of evidence examined by the study team and seeks to identify the most important heritage values of the item. The purpose of this report is to provide an initial evaluation. If any action is planned which might affect the cultural heritage significance of this place, advice should be sought through the Gatton Shire Council Planning Branch.

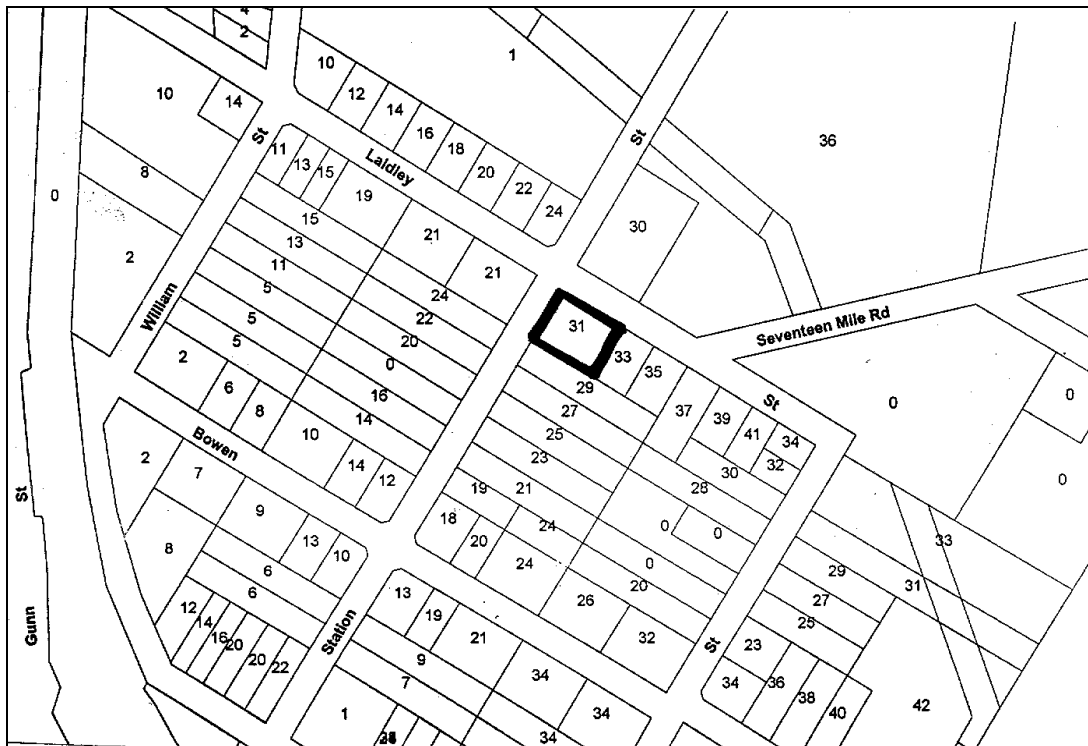

NOTE: This report has been prepared on the basis of evidence examined by the study team and seeks to identify the most important heritage values of the item. The purpose of this report is to provide an initial evaluation. If any action is planned which might affect the cultural heritage significance of this place, advice should be sought through the Gatton Shire Council Planning Branch.

NAME	-
CATEGORY	House
LOCATION	23 Station Rd Helidon
RPD	318H1261
LISTING BOUNDARY	Whole site
OTHER LISTINGS	-
SIGNIFICANCE LEVEL	Local

**History:****Description:**

- 1880s style pyramid roof and stepped curved front verandah.
- Single skin exposed stud with horizontal boards
- Original doors and sash windows
- Pressed metal ridge decoration.
- Weatherboard clad.
- Curved iron window hoods.
- Possibly refurbished two rail slat balustrade.
- Stop chamfered posts.
- Low set with timber stumps

**Significance:**

Important for its demonstration of aesthetic characteristics and building techniques typical of the late 19<sup>th</sup>/early 20<sup>th</sup> century.

The house, with its surrounding trees and garden, contributes aesthetically to the streetscape.

**Associated Items:****References:****Comments:**

NOTE: This report has been prepared on the basis of evidence examined by the study team and seeks to identify the most important heritage values of the item. The purpose of this report is to provide an initial evaluation. If any action is planned which might affect the cultural heritage significance of this place, advice should be sought through the Gatton Shire Council Planning Branch.



NOTE: This report has been prepared on the basis of evidence examined by the study team and seeks to identify the most important heritage values of the item. The purpose of this report is to provide an initial evaluation. If any action is planned which might affect the cultural heritage significance of this place, advice should be sought through the Gatton Shire Council Planning Branch.

NAME	-
CATEGORY	House
LOCATION	30 Laidley St Helidon
RPD	1RP23164
LISTING BOUNDARY	Whole site
OTHER LISTINGS	-
SIGNIFICANCE LEVEL	Local

**History:****Description:**

- 1910-1920s short ridge bungalow with incorporated verandahs.
- Side verandahs enclosed.
- Remaining open verandah shows a three-rail broomstick balustrade.
- Ornate corner brackets.
- Chimney thought to be a later addition.

**Significance:**

Important for its demonstration of early form and materials and for its demonstration of early building techniques.

The house, with its surrounding garden, contributes aesthetically to the streetscape/rural landscape.

**Associated Items:****References:****Comments:**

NOTE: This report has been prepared on the basis of evidence examined by the study team and seeks to identify the most important heritage values of the item. The purpose of this report is to provide an initial evaluation. If any action is planned which might affect the cultural heritage significance of this place, advice should be sought through the Gatton Shire Council Planning Branch.



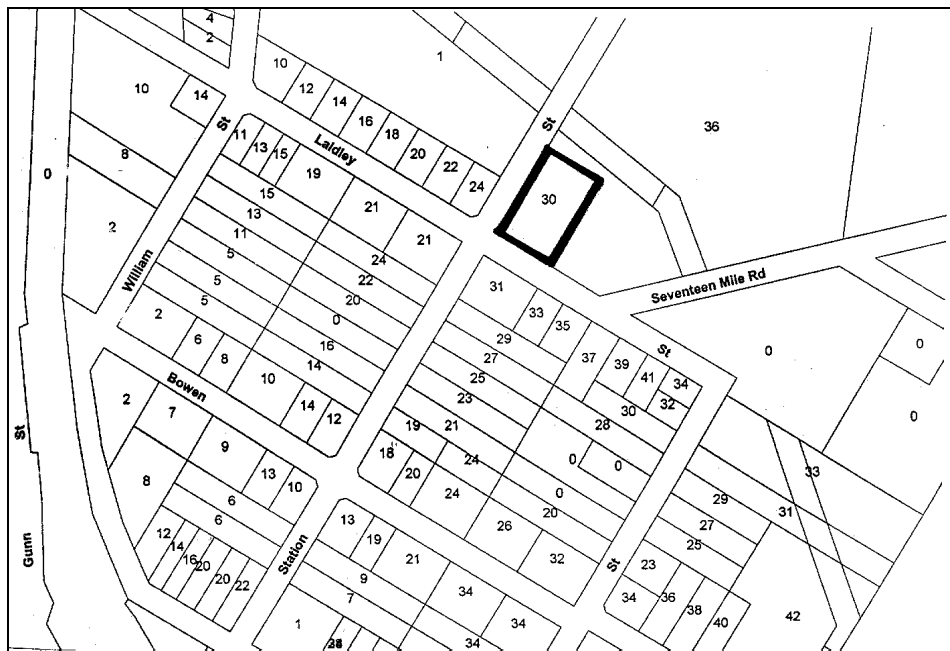

NOTE: This report has been prepared on the basis of evidence examined by the study team and seeks to identify the most important heritage values of the item. The purpose of this report is to provide an initial evaluation. If any action is planned which might affect the cultural heritage significance of this place, advice should be sought through the Gatton Shire Council Planning Branch.



NAME	-
CATEGORY	House
LOCATION	22 Station Rd Helidon
RPD	209H1261
LISTING BOUNDARY	Whole site
OTHER LISTINGS	-
SIGNIFICANCE LEVEL	Local

**History:****Description:**

- C1890s style gable ended pitched roof cottage with curved front verandah and rear skillions.
- Skillion timber and metal window hoods
- Front verandah enclosed with weatherboard balustrade and louvre windows.

**Significance:**

Important for its demonstration of aesthetic characteristics and building techniques typical of the late 19<sup>th</sup>/early 20<sup>th</sup> century.

The house, with its surrounding trees and garden, contributes aesthetically to the streetscape.

**Associated Items:**

One of several cottages of this style in this street.

**References:**

Comments:

NOTE: This report has been prepared on the basis of evidence examined by the study team and seeks to identify the most important heritage values of the item. The purpose of this report is to provide an initial evaluation. If any action is planned which might affect the cultural heritage significance of this place, advice should be sought through the Gatton Shire Council Planning Branch.



NOTE: This report has been prepared on the basis of evidence examined by the study team and seeks to identify the most important heritage values of the item. The purpose of this report is to provide an initial evaluation. If any action is planned which might affect the cultural heritage significance of this place, advice should be sought through the Gatton Shire Council Planning Branch.

NAME	-
CATEGORY	House
LOCATION	18 Station Rd Helidon
RPD	207H1261
LISTING BOUNDARY	Whole site
OTHER LISTINGS	-
SIGNIFICANCE LEVEL	Local

**History:****Description:**

- c1890s style Gable ended pitched roof with front and rear skillion enclosed verandah
- Separate kitchen wing.
- Front skillion verandah thought to be a recent addition.
- Weatherboard clad with aluminium framed windows.
- Original windows and doors not evident.

**Significance:**

Important for its demonstration of early form and materials and for its demonstration of early building techniques.

**Associated Items:**

One of several cottages of this style in this street.

**References:****Comments:**

NOTE: This report has been prepared on the basis of evidence examined by the study team and seeks to identify the most important heritage values of the item. The purpose of this report is to provide an initial evaluation. If any action is planned which might affect the cultural heritage significance of this place, advice should be sought through the Gatton Shire Council Planning Branch.

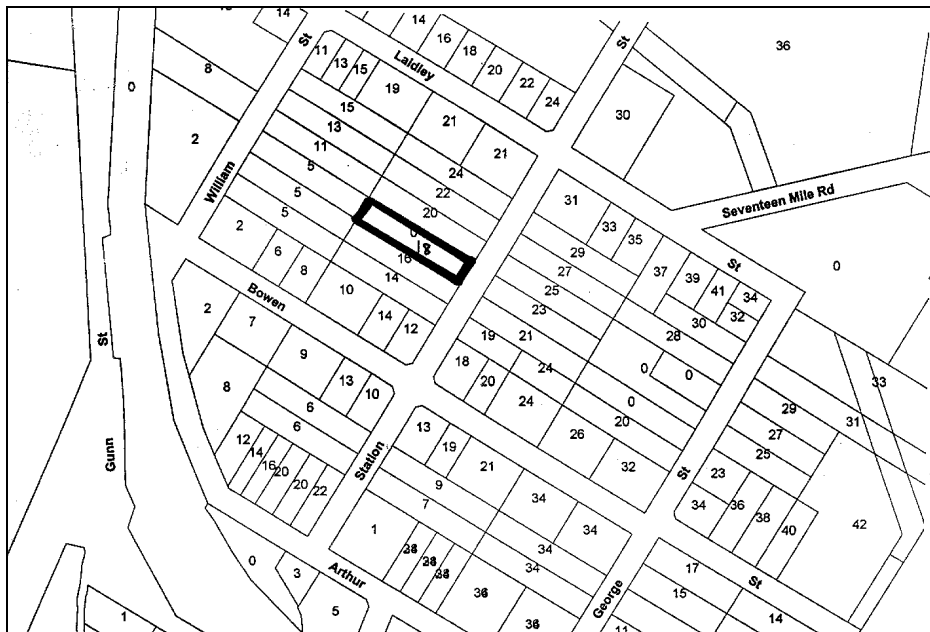

NOTE: This report has been prepared on the basis of evidence examined by the study team and seeks to identify the most important heritage values of the item. The purpose of this report is to provide an initial evaluation. If any action is planned which might affect the cultural heritage significance of this place, advice should be sought through the Gatton Shire Council Planning Branch.

NAME	-
CATEGORY	House
LOCATION	24 Station Rd Helidon
RPD	210H1261
LISTING BOUNDARY	Whole site
OTHER LISTINGS	-
SIGNIFICANCE LEVEL	Local

**History:****Description:**

- C1890s style pyramid roof with stepped skillion verandahs to front and rear.
- Front verandah partly enclosed possibly c1950s with chamfer boards and single pane casement windows and partly open with steel balustrade.
- Central stair entry.
- Weatherboard cladding extending on the left to partly enclose this side of the verandah.
- Curved ornate window hoods.

**Significance:**

Important for its demonstration of aesthetic characteristics and building techniques typical of the late 19<sup>th</sup>/early 20<sup>th</sup> century.

**Associated Items:****References:****Comments:**

NOTE: This report has been prepared on the basis of evidence examined by the study team and seeks to identify the most important heritage values of the item. The purpose of this report is to provide an initial evaluation. If any action is planned which might affect the cultural heritage significance of this place, advice should be sought through the Gatton Shire Council Planning Branch.

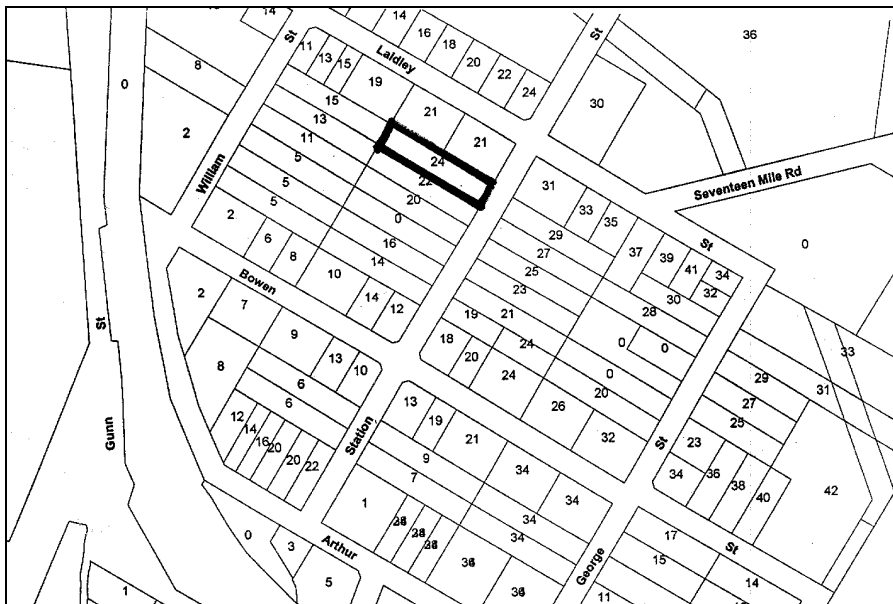

NOTE: This report has been prepared on the basis of evidence examined by the study team and seeks to identify the most important heritage values of the item. The purpose of this report is to provide an initial evaluation. If any action is planned which might affect the cultural heritage significance of this place, advice should be sought through the Gatton Shire Council Planning Branch.



NAME	Lazy Acres
CATEGORY	House
LOCATION	36 Laidley Rd Helidon
RPD	50RP228005
LISTING BOUNDARY	Whole site
OTHER LISTINGS	-
SIGNIFICANCE LEVEL	Local

**History:****Description:**

- long ridge hipped roof with asymmetrical gable projection.
- L-shaped verandah with weatherboard balustrade sleep-out enclosure and gable
- Open verandah to front entry features twinned posts, ornate corner brackets and three-rail broomstick balustrade.
- Off centre stair entry.
- High-set on timber posts with battened infill.

**Significance:**

Important for its demonstration of early form and materials and for its demonstration of early building techniques.

The house, with its surrounding garden, contributes aesthetically to the streetscape.

**Associated Items:****References:****Comments:**

NOTE: This report has been prepared on the basis of evidence examined by the study team and seeks to identify the most important heritage values of the item. The purpose of this report is to provide an initial evaluation. If any action is planned which might affect the cultural heritage significance of this place, advice should be sought through the Gatton Shire Council Planning Branch.

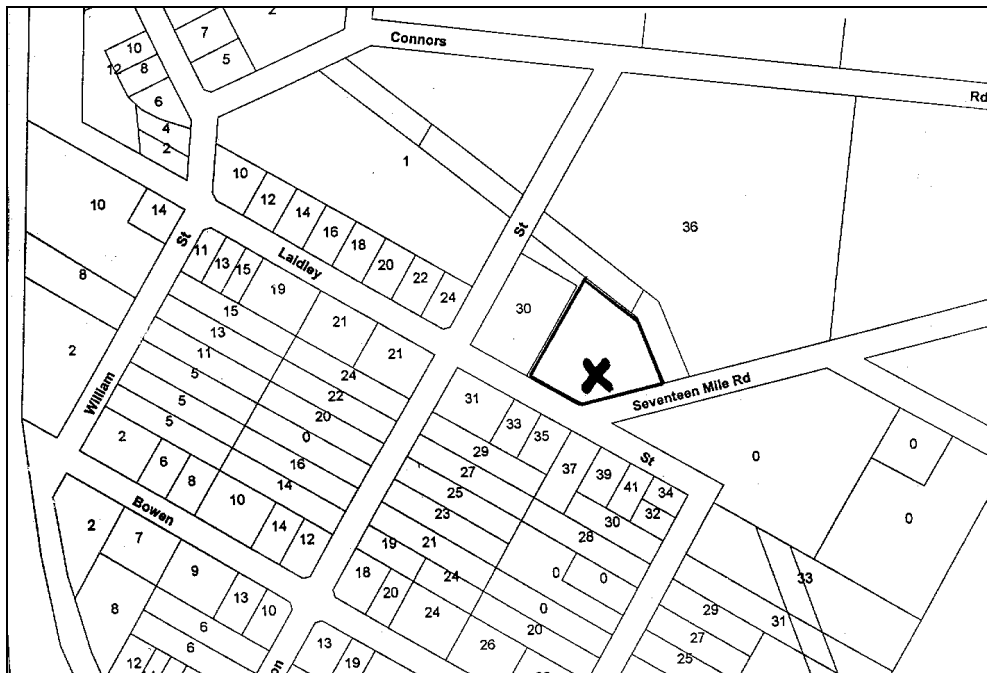

NOTE: This report has been prepared on the basis of evidence examined by the study team and seeks to identify the most important heritage values of the item. The purpose of this report is to provide an initial evaluation. If any action is planned which might affect the cultural heritage significance of this place, advice should be sought through the Gatton Shire Council Planning Branch.

NAME	-
CATEGORY	House
LOCATION	35 Laidley Rd Helidon
RPD	2RP164477
LISTING BOUNDARY	Whole site
OTHER LISTINGS	-
SIGNIFICANCE LEVEL	Local

**History:****Description:**

- gable ended pitched roof cottage with front and rear skillion, enclosed verandahs.
- Weatherboard clad.
- Central stair entry.
- Front verandah enclosed with weatherboard balustrade and louvre windows.
- Additional rear skillion of recent construction.
- Low set on timber stumps

**Significance:**

Important for its demonstration of aesthetic characteristics and building techniques typical of the late 19<sup>th</sup>/early 20<sup>th</sup> century.

**Associated Items:**

One of a number of examples this style of cottage in this area.

**References:**

Comments:

NOTE: This report has been prepared on the basis of evidence examined by the study team and seeks to identify the most important heritage values of the item. The purpose of this report is to provide an initial evaluation. If any action is planned which might affect the cultural heritage significance of this place, advice should be sought through the Gatton Shire Council Planning Branch.

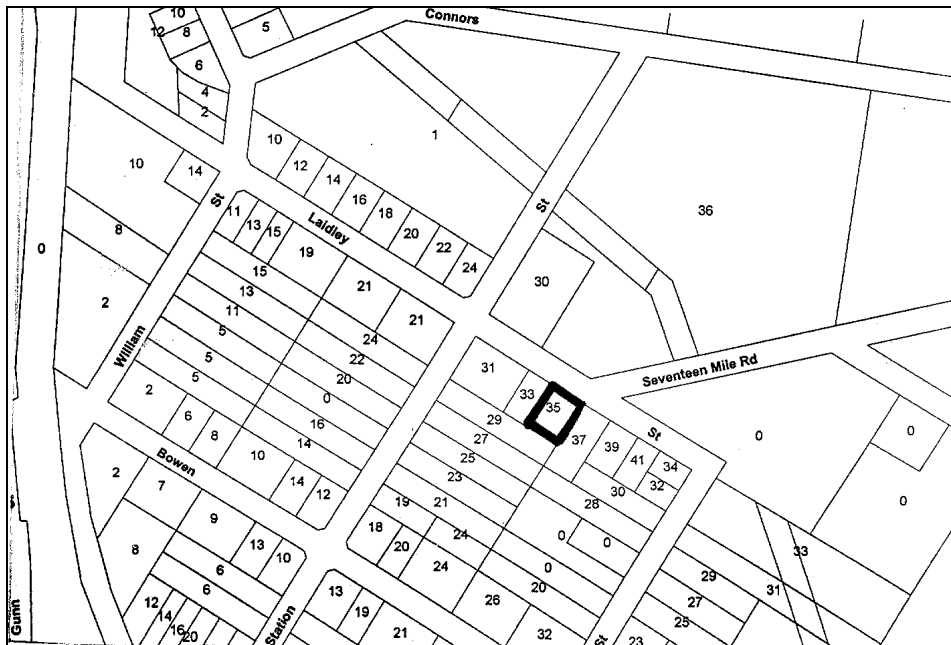

NOTE: This report has been prepared on the basis of evidence examined by the study team and seeks to identify the most important heritage values of the item. The purpose of this report is to provide an initial evaluation. If any action is planned which might affect the cultural heritage significance of this place, advice should be sought through the Gatton Shire Council Planning Branch.

NAME	-
CATEGORY	House
LOCATION	24 Bowen St Helidon
RPD	302H1261
LISTING BOUNDARY	Whole site
OTHER LISTINGS	-
SIGNIFICANCE LEVEL	Local

**History:****Description:**

- pyramid roof with stepped curved verandah on two sides.
- Side verandah enclosed with weatherboard balustrade and 5-light casement windows .
- Front verandah with central entry valance remains, no front stair evident.
- Two-rail broomstick balustrade with lattice infill over.
- Steeply pitched slatted timber and metal window hoods.

**Significance:**

Important for its demonstration of early form and materials and for its demonstration of early building techniques.

**Associated Items:****References:****Comments:**

NOTE: This report has been prepared on the basis of evidence examined by the study team and seeks to identify the most important heritage values of the item. The purpose of this report is to provide an initial evaluation. If any action is planned which might affect the cultural heritage significance of this place, advice should be sought through the Gatton Shire Council Planning Branch.

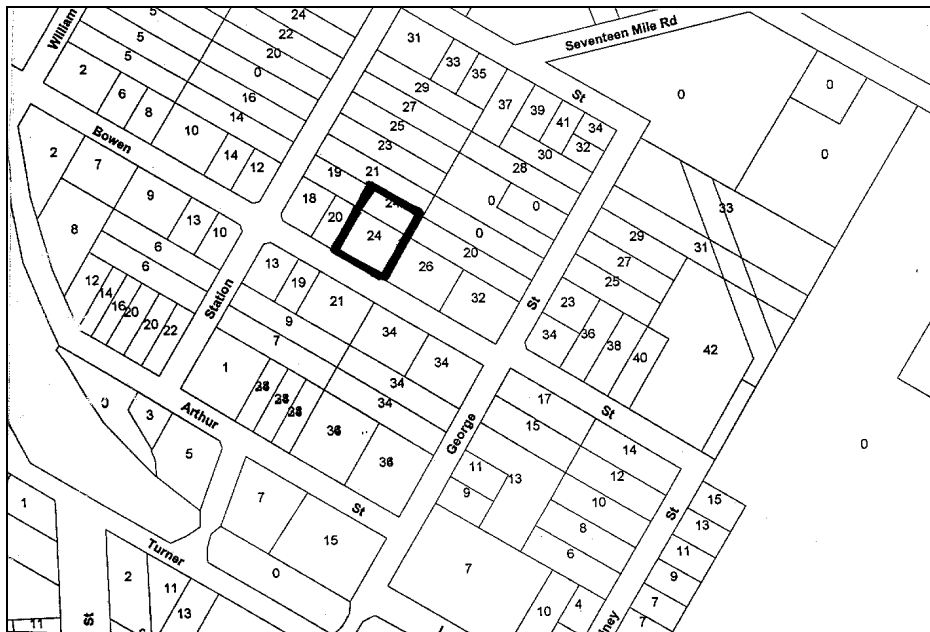

NOTE: This report has been prepared on the basis of evidence examined by the study team and seeks to identify the most important heritage values of the item. The purpose of this report is to provide an initial evaluation. If any action is planned which might affect the cultural heritage significance of this place, advice should be sought through the Gatton Shire Council Planning Branch.



NAME	
CATEGORY	House
LOCATION	28 George St Helidon
RPD	309H1261
LISTING BOUNDARY	Whole site
OTHER LISTINGS	-
SIGNIFICANCE LEVEL	Local

**History:****Description:**

- gable ended pitched roof cottage with front and rear skillion, enclosed verandahs.
- Separate kitchen wing clad with fibro, accessed via an enclosed breezeway.
- Weatherboard clad.
- Central stair entry.
- Front verandah enclosed with fibro and aluminium framed windows.
- Low set on timber stumps

**Significance:**

Important for its demonstration of aesthetic characteristics and building techniques typical of the late 19<sup>th</sup>/early 20<sup>th</sup> century.

**Associated Items:****References:**

**Comments:** A number of examples of this style of cottage are in this area.

NOTE: This report has been prepared on the basis of evidence examined by the study team and seeks to identify the most important heritage values of the item. The purpose of this report is to provide an initial evaluation. If any action is planned which might affect the cultural heritage significance of this place, advice should be sought through the Gatton Shire Council Planning Branch.



NOTE: This report has been prepared on the basis of evidence examined by the study team and seeks to identify the most important heritage values of the item. The purpose of this report is to provide an initial evaluation. If any action is planned which might affect the cultural heritage significance of this place, advice should be sought through the Gatton Shire Council Planning Branch.

NAME	-
CATEGORY	House
LOCATION	26 Bowen St Helidon
RPD	303H1261
LISTING BOUNDARY	Whole site
OTHER LISTINGS	-
SIGNIFICANCE LEVEL	Recorded

**History:****Description:**

- Short ridge pyramid roof with side facing gable and stepped verandahs.
- Front pyramid core has L-shaped bullnose verandah, enclosed on left.
- House thought to be refurbished and reclad with chamfer boards
- Unusual full length sash windows and central entry door with sidelights.
- Stop chamfered posts to front verandah, other details missing/under refurbishment.
- Set on block walls.
- Carefully tended rose garden in front yard and a large Camphor Laurel tree in the back.

**Significance:**

Recorded for its demonstration of early form and materials and for its demonstration of early building techniques.

**Associated Items:****References:**

Comments:

NOTE: This report has been prepared on the basis of evidence examined by the study team and seeks to identify the most important heritage values of the item. The purpose of this report is to provide an initial evaluation. If any action is planned which might affect the cultural heritage significance of this place, advice should be sought through the Gatton Shire Council Planning Branch.

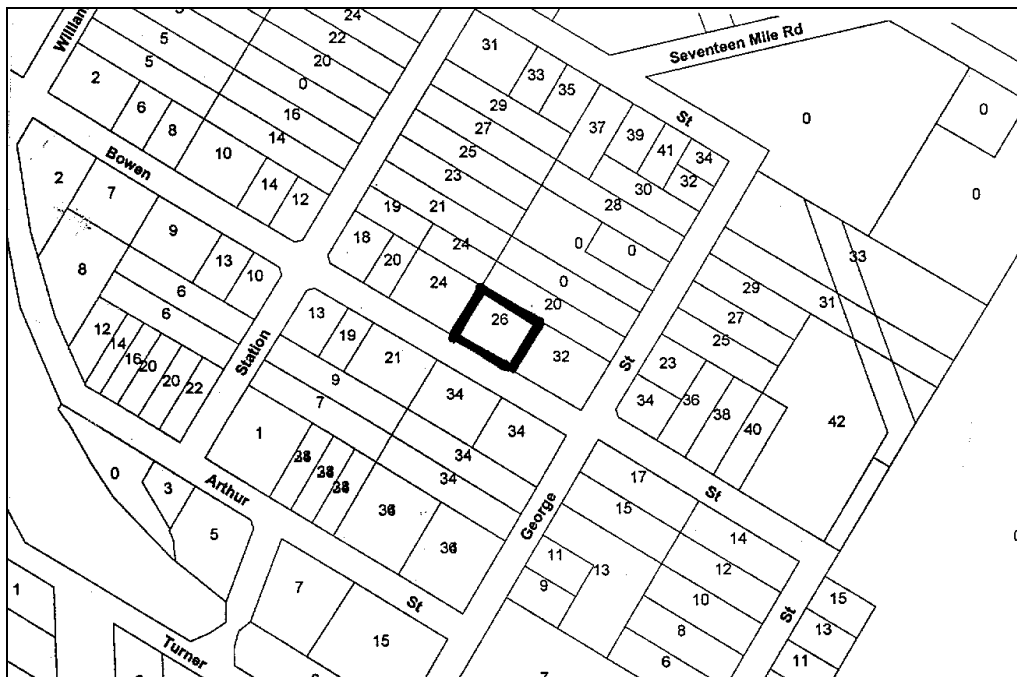

NOTE: This report has been prepared on the basis of evidence examined by the study team and seeks to identify the most important heritage values of the item. The purpose of this report is to provide an initial evaluation. If any action is planned which might affect the cultural heritage significance of this place, advice should be sought through the Gatton Shire Council Planning Branch.

NAME	-
CATEGORY	House
LOCATION	8 Deviney St Helidon
RPD	5H1268
LISTING BOUNDARY	Whole site
OTHER LISTINGS	-
SIGNIFICANCE LEVEL	Local

**History:****Description:**

- c1890s-1900s style short ridge (with iron ridge ornament) pyramid roof with rear hip and stepped curved verandah to 3 sides.
- Verandahs partly enclosed with weatherboards and aluminium framed windows to leave an L-shaped area open.
- Original verandah detailing not evident.
- Some evidence of original doors and windows.
- Recent exterior cladding has hidden the probable single skin construction.
- Low set on timber stumps

**Significance:**

Important for its demonstration of aesthetic characteristics and building techniques typical of the late 19<sup>th</sup>/early 20<sup>th</sup> century.

**Associated Items:****References:**

Comments:

NOTE: This report has been prepared on the basis of evidence examined by the study team and seeks to identify the most important heritage values of the item. The purpose of this report is to provide an initial evaluation. If any action is planned which might affect the cultural heritage significance of this place, advice should be sought through the Gatton Shire Council Planning Branch.





NOTE: This report has been prepared on the basis of evidence examined by the study team and seeks to identify the most important heritage values of the item. The purpose of this report is to provide an initial evaluation. If any action is planned which might affect the cultural heritage significance of this place, advice should be sought through the Gatton Shire Council Planning Branch.



NAME	-
CATEGORY	House
LOCATION	15 Deviney St Helidon
RPD	1RP146973
LISTING BOUNDARY	whole site
OTHER LISTINGS	-
SIGNIFICANCE LEVEL	Local

**History:****Description:**

- C1900s short ridge bungalow with incorporated front and side verandah.
- Refurbished front verandah with 2 rail slatted balustrade and corner brackets
- Decorative bullnose metal window hoods over sash windows.
- Tin stove alcove protruding at rear.
- Low set on timber stumps with central entry.
- 

**Significance:**

Important for its demonstration of aesthetic characteristics and building techniques typical of the late 19<sup>th</sup>/early 20<sup>th</sup> century.

The house, with its surrounding trees and garden, contributes aesthetically to the streetscape.

**Associated Items:****References:**

Comments:

NOTE: This report has been prepared on the basis of evidence examined by the study team and seeks to identify the most important heritage values of the item. The purpose of this report is to provide an initial evaluation. If any action is planned which might affect the cultural heritage significance of this place, advice should be sought through the Gatton Shire Council Planning Branch.



NOTE: This report has been prepared on the basis of evidence examined by the study team and seeks to identify the most important heritage values of the item. The purpose of this report is to provide an initial evaluation. If any action is planned which might affect the cultural heritage significance of this place, advice should be sought through the Gatton Shire Council Planning Branch.

NAME	-
CATEGORY	House
LOCATION	15 George St Helidon
RPD	10H1268
LISTING BOUNDARY	whole site
OTHER LISTINGS	-
SIGNIFICANCE LEVEL	Local

**History:****Description:**

- C1890s style, short ridge pyramid roof and right hand rear hip with stepped front enclosed bullnose verandah.
- Weatherboard clad with simple entry porch to enclosed verandah – stair and enclosure not original
- Decorative bullnose metal window hoods over sash windows.
- Low set on timber stumps
- 

**Significance:**

Important for its demonstration of aesthetic characteristics and building techniques typical of the late 19<sup>th</sup>/early 20<sup>th</sup> century.

**Associated Items:****References:****Comments:**

NOTE: This report has been prepared on the basis of evidence examined by the study team and seeks to identify the most important heritage values of the item. The purpose of this report is to provide an initial evaluation. If any action is planned which might affect the cultural heritage significance of this place, advice should be sought through the Gatton Shire Council Planning Branch.



NOTE: This report has been prepared on the basis of evidence examined by the study team and seeks to identify the most important heritage values of the item. The purpose of this report is to provide an initial evaluation. If any action is planned which might affect the cultural heritage significance of this place, advice should be sought through the Gatton Shire Council Planning Branch.

NAME	St Joseph's Catholic Church complex
CATEGORY	Ecclesiastical buildings
LOCATION	Gunn St Helidon
RPD	3RP892079
LISTING BOUNDARY	Whole site
OTHER LISTINGS	-
SIGNIFICANCE LEVEL	State

**History:**Church and Presbytery

Tenders were called for the church in January 1914. The foundation stone, which includes a plaque in Latin, was laid by Archbishop Duhig on 8 March. At this time, the church was said to have been the largest between Ipswich and Toowoomba. The architect was R. Coutts and the builder was R. Worley, both of Ipswich. The church was the first building of a planned new complex on a new 28 acre site described as "on an eminence about a quarter mile from the town."

The prompt start of construction was fortunate because the old church was demolished by a fierce storm only a short time later, on 3 April.

The new church was completed and opened officially at the end of September 1914.

The date of the Presbytery is not certain.

Hall

The hall is the former St Joseph's school, associated with St Joseph's Convent (see separate listing).

A Catholic school was established in Helidon c1871 and was registered as a non-vested school. In 1874, the school was taken over by the Sisters of Joseph who also established a convent. The sisters withdrew from Queensland in 1875 and the school temporarily closed. In January 1880, the Sisters of Mercy agreed to take over the school. The buildings at this time were on the eastern bank of Lockyer Creek.

On 1 August 1915, a new school was built on the large site where St Joseph's Church had been opened the previous year. The architects were GHM Addison & Son of Brisbane.

The convent closed in 1963 and the buildings were taken over by the Christian Brothers. The school was moved to its current position and is now used as a hall.

**Description:**

The church, the hall (former School), bell tower and presbytery are in a line along the edge of a sharp fall to creek flats where there are the remains of an old sports ground. (Goal posts, Basketball Hoops)

**Church:**

- Gable ended pitched corrugated roof
- Gabled flat pan and roll roofed, central front entry porch.
- Two roof top vents and a larger pyramid roofed lantern that protrudes to the interior, possibly for light or ventilation.
- Rear semi-octagonal sanctuary with the vestries on each side.

NOTE: This report has been prepared on the basis of evidence examined by the study team and seeks to identify the most important heritage values of the item. The purpose of this report is to provide an initial evaluation. If any action is planned which might affect the cultural heritage significance of this place, advice should be sought through the Gatton Shire Council Planning Branch.

- Feature coloured glass circular windows arranged symmetrically, two on the front and two on the rear elevation.
- Constructed of brick and buttressed with rendered masonry along the side elevations.
- Semi-circular arched windows with label moulds are centred between the buttresses along the side elevations.
- Smaller semi-circular coloured glass arched windows feature in the Sanctuary.
- Internally a semi-circular arch separates the Nave from the Sanctuary.
- Ceiling supported by hammer beam trusses and is partly lined with tongue and groove boards.

#### **Bell Tower**

- Large bell in steel-framed tower surmounted by a small gable roof and Latin cross.

#### **Hall**

- Previously the school building – moved from elsewhere on site
- Gable ended pitched corrugated roof. Decorative timber infill to each gable end.
- Bank of six casement windows with timber and metal window hoods at each gable end.
- Three simply designed vents are spaced evenly across the ridge of the roof.
- Verandahs to both sides. The front verandah has a pedimented entry and valanced bay but is enclosed with weatherboards and casement windows otherwise. The rear verandah is open with a two rail dowel balustrade, valance and corner brackets.

#### **Presbytery**

- C1900 asymmetrical bungalow with L-shaped incorporated verandah and enclosed sleep out along the right hand side.
- The gable front features a tripartite sash window with coloured glass and curved window hood.
- A side gable features a double sash window and curved hood.
- The residence is clad with weatherboard.
- Single skin with exposed studs and vertical T&G boards.
- Simple two rail slatted balustrade thought to be a refurbishment.
- French doors with fanlights open to the verandah.

#### **Significance:**

The complex is important in demonstrating the principal characteristics of a substantial church and educational complex in a country town.

The buildings individually exhibit aesthetic characteristics valued by the community.

The place has a strong association with the Helidon community for social, spiritual and educational reasons.

#### **Associated Items:**

Convent - Listed separately.

Catholic Cemetery – listed separately

#### **References:**

Qld Times 29.9.1914

NOTE: This report has been prepared on the basis of evidence examined by the study team and seeks to identify the most important heritage values of the item. The purpose of this report is to provide an initial evaluation. If any action is planned which might affect the cultural heritage significance of this place, advice should be sought through the Gatton Shire Council Planning Branch.





- 1 Church
- 2 Hall
- 3 Presbytery

NOTE: This report has been prepared on the basis of evidence examined by the study team and seeks to identify the most important heritage values of the item. The purpose of this report is to provide an initial evaluation. If any action is planned which might affect the cultural heritage significance of this place, advice should be sought through the Gatton Shire Council Planning Branch.



NOTE: This report has been prepared on the basis of evidence examined by the study team and seeks to identify the most important heritage values of the item. The purpose of this report is to provide an initial evaluation. If any action is planned which might affect the cultural heritage significance of this place, advice should be sought through the Gatton Shire Council Planning Branch.



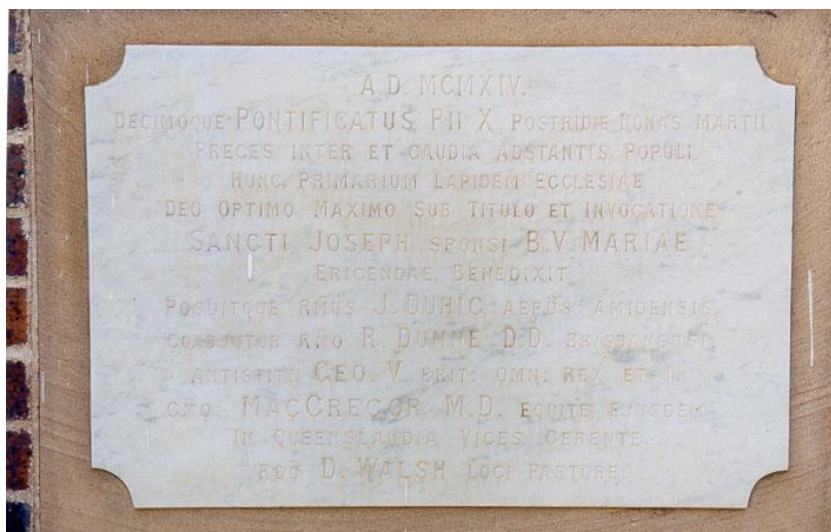

NOTE: This report has been prepared on the basis of evidence examined by the study team and seeks to identify the most important heritage values of the item. The purpose of this report is to provide an initial evaluation. If any action is planned which might affect the cultural heritage significance of this place, advice should be sought through the Gatton Shire Council Planning Branch.





NOTE: This report has been prepared on the basis of evidence examined by the study team and seeks to identify the most important heritage values of the item. The purpose of this report is to provide an initial evaluation. If any action is planned which might affect the cultural heritage significance of this place, advice should be sought through the Gatton Shire Council Planning Branch.

NAME	Formerly St Joseph's Convent
CATEGORY	Ecclesiastical building
LOCATION	Gunn St Helidon
RPD	4RP897077
LISTING BOUNDARY	Whole site
OTHER LISTINGS	-
SIGNIFICANCE LEVEL	State

**History:**

A Catholic school was established in Helidon c1871 and was registered as a non-vested school. In 1874, the school was taken over by the Sisters of Joseph who also established a convent. The sisters withdrew from Queensland in 1875 and the school temporarily closed.

In January 1880, the Sisters of Mercy agreed to take over the school. The buildings at this time were on the eastern bank of Lockyer Creek.

On 1 August 1915, a new school was built on the large site where St Joseph's Church had been opened the previous year (see separate listing). A new convent was built next and was opened on 21 May 1916. Both buildings were designed by Brisbane Architects GHM Addison & Son.

The convent school closed in 1963 due to low enrolments and the buildings were subsequently purchased by the Christian Brothers for use as a Novitiate. In the 1990s, the convent was purchased by the Magnificat Meal Movement, a breakaway neo-Catholic religious sect not recognised by the Catholic Church.

**Description:**

Note: It was not possible to inspect the buildings.

**Significance:**

Significant as a former part of the former St Joseph's Church Complex which is important in demonstrating the principal characteristics of a substantial church and educational complex in a country town.

The building individually exhibits aesthetic characteristics valued by the community.

The place has a strong association with the Helidon community for social, spiritual and educational reasons.

The place is associated with the prominent architectural firm GHM Addison and Son.

**Associated Items:**

St Joseph's church complex adjacent  
Catholic Cemetery

**References:**

Helen Bennett *Gatton Shire Thematic Historical Overview* Cultural Heritage Branch EPA 1999

NOTE: This report has been prepared on the basis of evidence examined by the study team and seeks to identify the most important heritage values of the item. The purpose of this report is to provide an initial evaluation. If any action is planned which might affect the cultural heritage significance of this place, advice should be sought through the Gatton Shire Council Planning Branch.

**Comment**

NOTE: This report has been prepared on the basis of evidence examined by the study team and seeks to identify the most important heritage values of the item. The purpose of this report is to provide an initial evaluation. If any action is planned which might affect the cultural heritage significance of this place, advice should be sought through the Gatton Shire Council Planning Branch.





NOTE: This report has been prepared on the basis of evidence examined by the study team and seeks to identify the most important heritage values of the item. The purpose of this report is to provide an initial evaluation. If any action is planned which might affect the cultural heritage significance of this place, advice should be sought through the Gatton Shire Council Planning Branch.

NAME	Catholic Cemetery
CATEGORY	Cemetery
LOCATION	Helidon Dip Road
RPD	
LISTING BOUNDARY	Whole site
OTHER LISTINGS	-
SIGNIFICANCE LEVEL	Local

**History:****Description:**

Simple country cemetery, numerous headstones

**Significance:**

Important for its demonstration of the characteristics of a small country cemetery; for its association with the social and spiritual evolution of the surrounding district, particularly the Catholic community; and for its ability to yield information on local social history and the individual family histories of local residents.

**Associated Items:**

St Joseph's Catholic complex  
Former St Joseph's Convent

**References:****Comments:**

NOTE: This report has been prepared on the basis of evidence examined by the study team and seeks to identify the most important heritage values of the item. The purpose of this report is to provide an initial evaluation. If any action is planned which might affect the cultural heritage significance of this place, advice should be sought through the Gatton Shire Council Planning Branch.



NOTE: This report has been prepared on the basis of evidence examined by the study team and seeks to identify the most important heritage values of the item. The purpose of this report is to provide an initial evaluation. If any action is planned which might affect the cultural heritage significance of this place, advice should be sought through the Gatton Shire Council Planning Branch.

NAME	Helidon Tennis Club
CATEGORY	Club House
LOCATION	Arthur St Helidon
RPD	4, 5 and 6 of RP2592
LISTING BOUNDARY	Building only
OTHER LISTINGS	-
SIGNIFICANCE LEVEL	Recorded

**History:**

The building was originally the Clarendon School and moved here c1950s

**Description:**

- Gable ended weatherboard building with verandahs to two sides.
- Partly built in verandah and partly weatherboard balustrade with louvre window infill.

**Significance:**

Recorded for its demonstration of early form and materials and for its demonstration of early building techniques, and for its former association with education in the region.

**Associated Items:****References:**

Historical information by local resident.

**Comments:**

NOTE: This report has been prepared on the basis of evidence examined by the study team and seeks to identify the most important heritage values of the item. The purpose of this report is to provide an initial evaluation. If any action is planned which might affect the cultural heritage significance of this place, advice should be sought through the Gatton Shire Council Planning Branch.



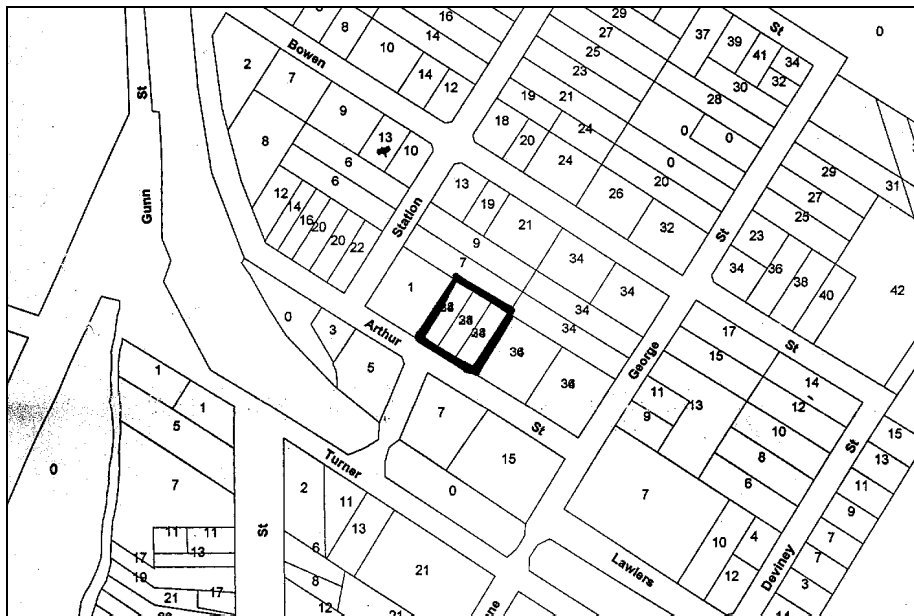

NOTE: This report has been prepared on the basis of evidence examined by the study team and seeks to identify the most important heritage values of the item. The purpose of this report is to provide an initial evaluation. If any action is planned which might affect the cultural heritage significance of this place, advice should be sought through the Gatton Shire Council Planning Branch.

NAME	-
CATEGORY	House
LOCATION	13 Bowen St
RPD	1RP138808
LISTING BOUNDARY	whole site
OTHER LISTINGS	-
SIGNIFICANCE LEVEL	Recorded

**History:****Description:**

- Victorian pyramid roof and stepped curved front verandah.
- Detached kitchen and covered breezeway access.
- Side elevation faces the street.
- Original doors and windows.
- weatherboard balustrade and corner brackets.
- Adjustable timber louvre infill to verandah.
- Curved iron window hoods.

**Significance:**

Recorded for its demonstration of early form and materials and for its demonstration of early building techniques.

**Associated Items:****References:**

Comments:

NOTE: This report has been prepared on the basis of evidence examined by the study team and seeks to identify the most important heritage values of the item. The purpose of this report is to provide an initial evaluation. If any action is planned which might affect the cultural heritage significance of this place, advice should be sought through the Gatton Shire Council Planning Branch.



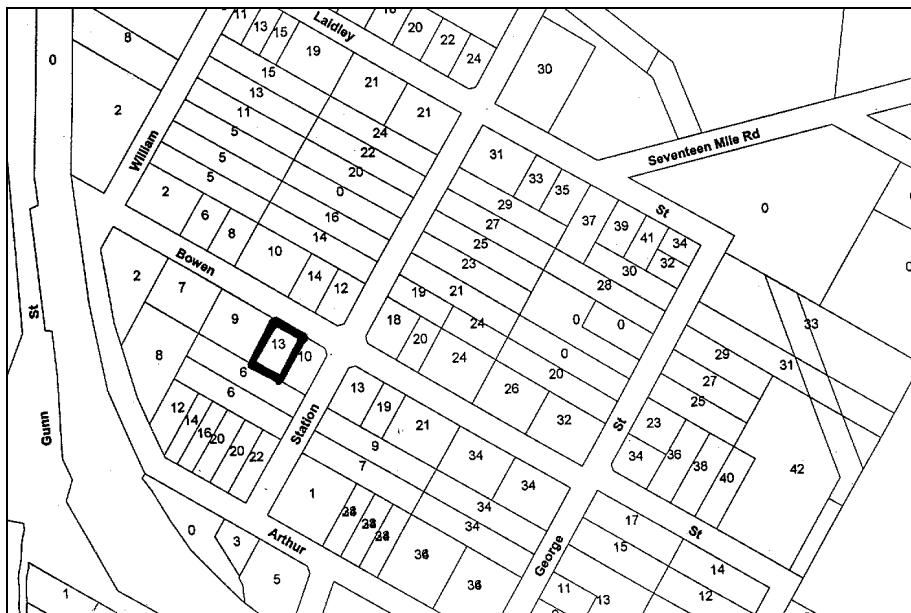

NOTE: This report has been prepared on the basis of evidence examined by the study team and seeks to identify the most important heritage values of the item. The purpose of this report is to provide an initial evaluation. If any action is planned which might affect the cultural heritage significance of this place, advice should be sought through the Gatton Shire Council Planning Branch.

NAME	-
CATEGORY	House
LOCATION	16 Station Rd Helidon
RPD	206H1261
LISTING BOUNDARY	Whole site
OTHER LISTINGS	-
SIGNIFICANCE LEVEL	Recorded

**History:****Description:**

- Pyramid bungalow roof.
- Paired posts framing the entrance.
- Front door with French doors either side.
- Front verandah refurbished with a weatherboard balustrade and enclosed with aluminium framed windows.
- Slatted timber and metal window hoods
- Stove alcove protrudes along the side elevation.
- High set with timber stumps. Slatted batten infill.
- Water tank and stand
- 

**Significance:**

Recorded for its demonstration of early form and materials and for its demonstration of early building techniques.

**Associated Items:****References:**

Comments:

NOTE: This report has been prepared on the basis of evidence examined by the study team and seeks to identify the most important heritage values of the item. The purpose of this report is to provide an initial evaluation. If any action is planned which might affect the cultural heritage significance of this place, advice should be sought through the Gatton Shire Council Planning Branch.



NOTE: This report has been prepared on the basis of evidence examined by the study team and seeks to identify the most important heritage values of the item. The purpose of this report is to provide an initial evaluation. If any action is planned which might affect the cultural heritage significance of this place, advice should be sought through the Gatton Shire Council Planning Branch.

NAME	General store
CATEGORY	Business
LOCATION	Railway St Helidon
RPD	452CSH280
LISTING BOUNDARY	Whole of site
OTHER LISTINGS	-
SIGNIFICANCE LEVEL	Recorded

**History:**

Long association as a shop from approx 1920s

**Description:**

- Operating as a general store.
- Simple rectangular plan gable ended building clad with weatherboard.
- Skillion addition on right hand side (facing photo) houses a kitchen.
- Few sash windows remain. The front is accessed via aluminium sliding glass door.

**Significance:**

Recorded for the evidence it contains of the traditional form, detailing and materials of a small shop.

It is important as a demonstration of the history of commercial activity in the Helidon community in the vicinity of the railway.

**Associated Items:****References:**

Historical information by local resident

**Comments:**

NOTE: This report has been prepared on the basis of evidence examined by the study team and seeks to identify the most important heritage values of the item. The purpose of this report is to provide an initial evaluation. If any action is planned which might affect the cultural heritage significance of this place, advice should be sought through the Gatton Shire Council Planning Branch.



NOTE: This report has been prepared on the basis of evidence examined by the study team and seeks to identify the most important heritage values of the item. The purpose of this report is to provide an initial evaluation. If any action is planned which might affect the cultural heritage significance of this place, advice should be sought through the Gatton Shire Council Planning Branch.

NAME	Alice Creek Gold Mine
CATEGORY	Industrial site
LOCATION	Off Gold Mine Rd (which is off Seventeen Mile Rd)
RPD	
LISTING BOUNDARY	Site of mining artifacts
OTHER LISTINGS	-
SIGNIFICANCE LEVEL	Recorded

**History:**

A gold mine was established here in the early 1900s. Its origins are obscure and its returns are said to have been meagre.

**Description:**

It has not been possible to inspect this property as the owner could not be contacted

A stamper and a brick kiln are shown in photos in  
Ann Wallin & Associates Pty Ltd *Helidon Hills A Predictive Cultural Heritage Report* Wesroc 1998

**Significance:** Recorded for its historical interest

**Associated Items:****References:**

**Comments:** This is an interesting archaeological site on private property.

NOTE: This report has been prepared on the basis of evidence examined by the study team and seeks to identify the most important heritage values of the item. The purpose of this report is to provide an initial evaluation. If any action is planned which might affect the cultural heritage significance of this place, advice should be sought through the Gatton Shire Council Planning Branch.