

Gatton Shire Cultural Heritage Study

Vol 4 Withcott Mt Sylvia Tent Hill Ropeley Special Sites

A report for
Gatton Shire Council
by
Buchanan Architects
December 2000



WITHCOTT

Former Methodist Church, Lot 1 Blanchview Rd (cnr Church rd)	742
Farmhouse, Lot 45 Blanchview Rd	744
"Blanchview", Blanchview Rd (cnr Church St)	748
Former Blanchview School building and monument, 9214 Blanchview Rd	750
Farmhouse, 9214 Blanchview Rd	754
House, Blanchview Rd	756
House, Blanchview Rd	758
House, Jones St Withcott	760
Farmhouse, Taylors Rd Withcott (at end of road)	762
Scout Hall, Roche's Rd (cnr Little Oakey Rd)	764
House, Blanchview Rd	766

NOTE: This report has been prepared on the basis of evidence examined by the study team and seeks to identify the most important heritage values of the item. The purpose of this report is to provide an initial evaluation. If any action is planned which might affect the cultural heritage significance of this place, advice should be sought through the Gatton Shire Council Planning Branch.

NAME	
CATEGORY	Former Methodist Church
LOCATION	Lot 1 Blanchview Rd (cnr Church rd)
RPD	1RP21376
LISTING BOUNDARY	Whole site
OTHER LISTINGS	-
SIGNIFICANCE LEVEL	Local

History:

Built on this site, year of construction not established

Description:

- Gable ended pitched roof and rectangular plan building
- Refurbished as a dwelling
- Weatherboard clad.
- Old slab and wire fence.

Significance:

Significant as a good example of a simple country church. It is important in exhibiting a range of aesthetic characteristics valued by the local community, in particular the building's traditional form, scale and materials.

Important for its contribution to the rural landscape.

Associated Places:**References:****Comments:**

NOTE: This report has been prepared on the basis of evidence examined by the study team and seeks to identify the most important heritage values of the item. The purpose of this report is to provide an initial evaluation. If any action is planned which might affect the cultural heritage significance of this place, advice should be sought through the Gatton Shire Council Planning Branch.

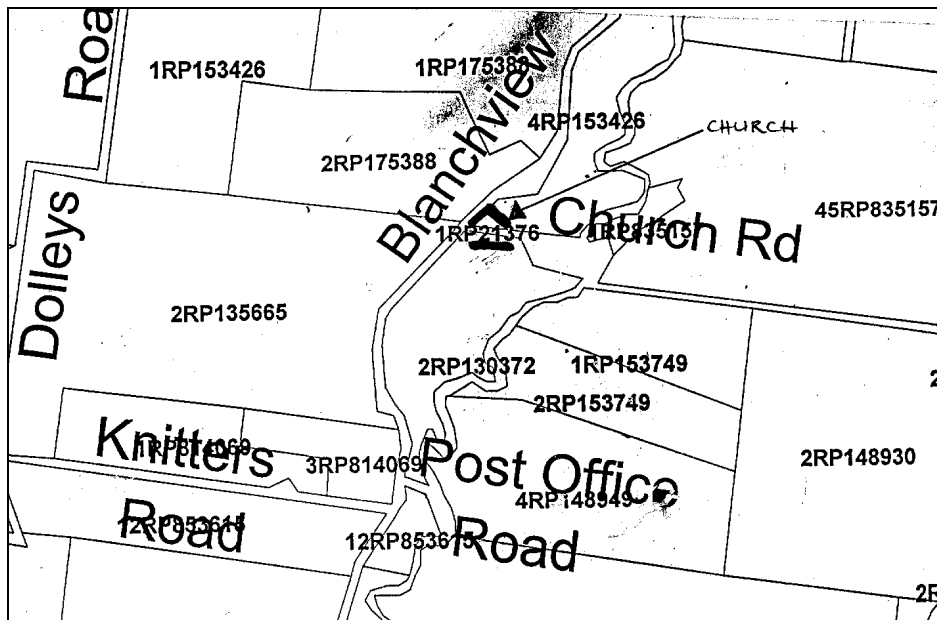

NOTE: This report has been prepared on the basis of evidence examined by the study team and seeks to identify the most important heritage values of the item. The purpose of this report is to provide an initial evaluation. If any action is planned which might affect the cultural heritage significance of this place, advice should be sought through the Gatton Shire Council Planning Branch.

NAME	
CATEGORY	Farmhouse
LOCATION	Lot 45 Blanchview Rd
RPD	45RP835157
LISTING BOUNDARY	Area containing Buildings
OTHER LISTINGS	-
SIGNIFICANCE LEVEL	Local

History:

- Joseph Hughs' grandfather first selected the property, passed to Fred Hughs then to Reg Hughs who is survived by his wife Mrs Hughs. It was operated as a dairy for several generations.
- The new bridge over Monkey Waterhole Springs will be named "Hughs Bridge" in honour of the family.
- The original core, said to be from c1850s was relocated from the base of the hill on which it now is located.

Description:

- Original section of the dwelling was the pyramid roof core with three sides stepped curved verandah. The gable ended pitched section with side skillion was added c1890s.
- Weatherboard clad with original windows and doors.
- Stop chamfered posts with capitals and ornate corner brackets.
- Slatted two-rail balustrade.
- Various window hoods.
- Water tanks and log stands
- Various farm sheds including creamery, stables and barns, machinery shed.

Significance:

Important for its demonstration of aesthetic characteristics and building techniques typical of the late 19th/early 20th century, possibly with a section dating from the period of early selection (mid-1860s)

Associated with an early family of the district.

The farm buildings are recorded and demonstrate early construction techniques.

Associated Places:**References:**

Historical information provided by current owner.

Comments:

NOTE: This report has been prepared on the basis of evidence examined by the study team and seeks to identify the most important heritage values of the item. The purpose of this report is to provide an initial evaluation. If any action is planned which might affect the cultural heritage significance of this place, advice should be sought through the Gatton Shire Council Planning Branch.



NOTE: This report has been prepared on the basis of evidence examined by the study team and seeks to identify the most important heritage values of the item. The purpose of this report is to provide an initial evaluation. If any action is planned which might affect the cultural heritage significance of this place, advice should be sought through the Gatton Shire Council Planning Branch.



NOTE: This report has been prepared on the basis of evidence examined by the study team and seeks to identify the most important heritage values of the item. The purpose of this report is to provide an initial evaluation. If any action is planned which might affect the cultural heritage significance of this place, advice should be sought through the Gatton Shire Council Planning Branch.

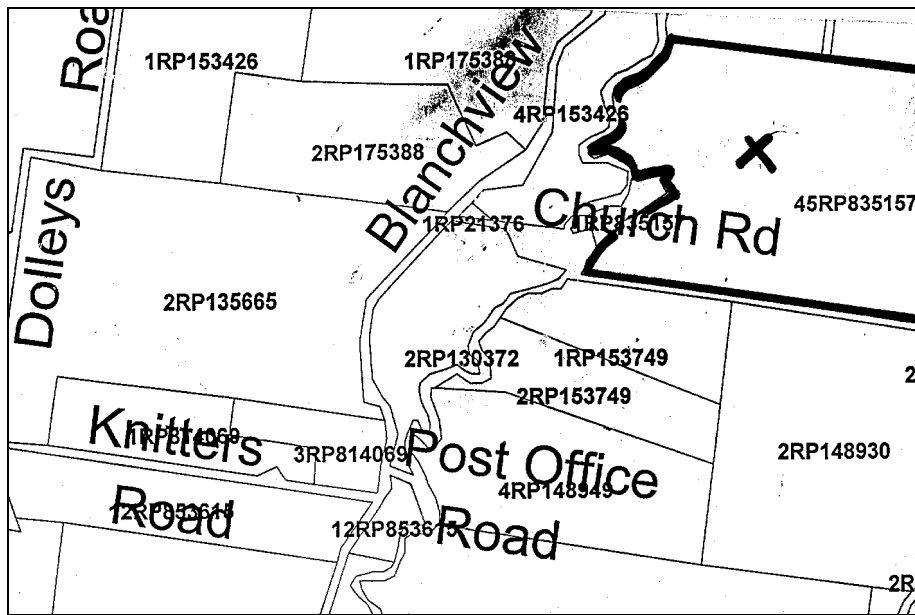

NOTE: This report has been prepared on the basis of evidence examined by the study team and seeks to identify the most important heritage values of the item. The purpose of this report is to provide an initial evaluation. If any action is planned which might affect the cultural heritage significance of this place, advice should be sought through the Gatton Shire Council Planning Branch.

NAME	"Blanchview"
CATEGORY	House
LOCATION	Blanchview Rd (cnr Church St)
RPD	2RP130372
LISTING BOUNDARY	House area
OTHER LISTINGS	-
SIGNIFICANCE LEVEL	Local

History:

The Blanchard family owned the property, originally named Monkey Waterhole Springs after the series of natural spring waterholes that run through the area. The local policeman from Helidon, stated that the name was too long for his records and suggested that the property should be called "Blanchview". Due to the early settlement of this area by the family, the road has been given the same name. The property operated for some time as a dairy farm and the dwelling remains in its original position.

Description:

- C1880s style core, short ridge pyramid roof with stepped curved verandahs to three sides. Right hand rear half hipped section also c 1880s.
- Left hand L-shaped section is new construction linking to rooms that formed a part of the Harristown railway building that has been relocated to this site. The verandah continues to wrap around the new wing and are constructed to match the original detailing.
- Weatherboard clad with original sash windows.
- Curved tin window hoods to exposed areas.
- Central stair entry, cross-braced balustrade, stop chamfered posts with capitals and corner brackets.

Significance:

Important for its demonstration of aesthetic characteristics and building techniques typical of the late 19th/early 20th century.

The house, with its surrounding trees and garden, contributes aesthetically to the streetscape.

Important for its association with an early family of the district.

Associated Places:**References:**

Historical information supplied by current owner.

Comments:

NOTE: This report has been prepared on the basis of evidence examined by the study team and seeks to identify the most important heritage values of the item. The purpose of this report is to provide an initial evaluation. If any action is planned which might affect the cultural heritage significance of this place, advice should be sought through the Gatton Shire Council Planning Branch.

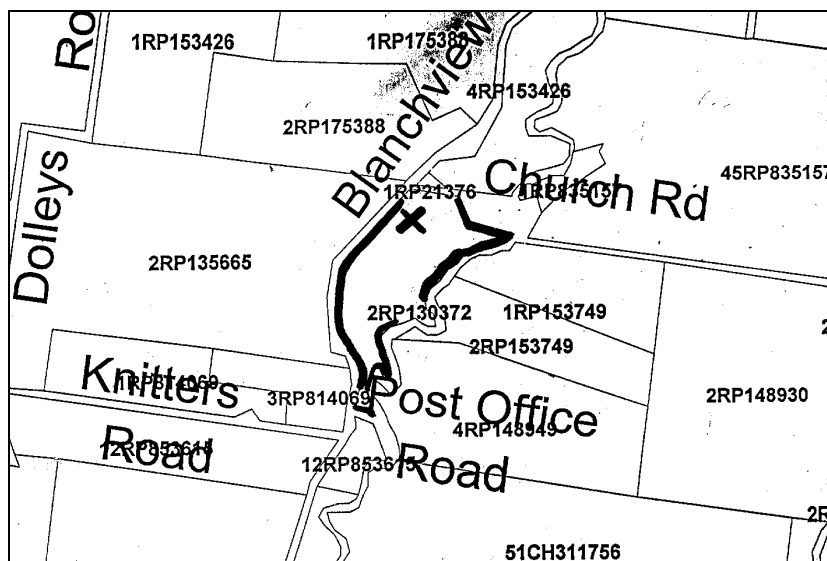

NOTE: This report has been prepared on the basis of evidence examined by the study team and seeks to identify the most important heritage values of the item. The purpose of this report is to provide an initial evaluation. If any action is planned which might affect the cultural heritage significance of this place, advice should be sought through the Gatton Shire Council Planning Branch.

NAME	Former Blanchview State School
CATEGORY	Former Blanchview School building and monument
LOCATION	9214 Blanchview Rd
RPD	2CH311700
LISTING BOUNDARY	Building only and monument site
OTHER LISTINGS	
SIGNIFICANCE LEVEL	Recorded

History:

The school opened as Monkey Waterholes Provisional School in 1892. The name later changed to Blanchview and the school closed in 1966. The building is now privately owned and has been relocated to a property further south along Blanchview Road. The school is becoming dilapidated and is not currently being used.

A monument marks the school's original site.

Description:

- Gable ended pitched roof with stepped front skillion verandah and enclosed side verandah.
- Weatherboard clad with symmetrically placed four light sash windows and a bank of three casement windows at the gable end.
- Entry porch is undecorated and the posts are square, the front entry door is not identified, the rear entry is a French door.

Significance:

Recorded as an example of an early country school, now closed. The erection of the monument indicates community affection for the school's role in the educational and social life of the local community.

Associated Places:**References:****Comments:**

NOTE: This report has been prepared on the basis of evidence examined by the study team and seeks to identify the most important heritage values of the item. The purpose of this report is to provide an initial evaluation. If any action is planned which might affect the cultural heritage significance of this place, advice should be sought through the Gatton Shire Council Planning Branch.



NOTE: This report has been prepared on the basis of evidence examined by the study team and seeks to identify the most important heritage values of the item. The purpose of this report is to provide an initial evaluation. If any action is planned which might affect the cultural heritage significance of this place, advice should be sought through the Gatton Shire Council Planning Branch.



Monument marking the original location of the Blanchview School Building

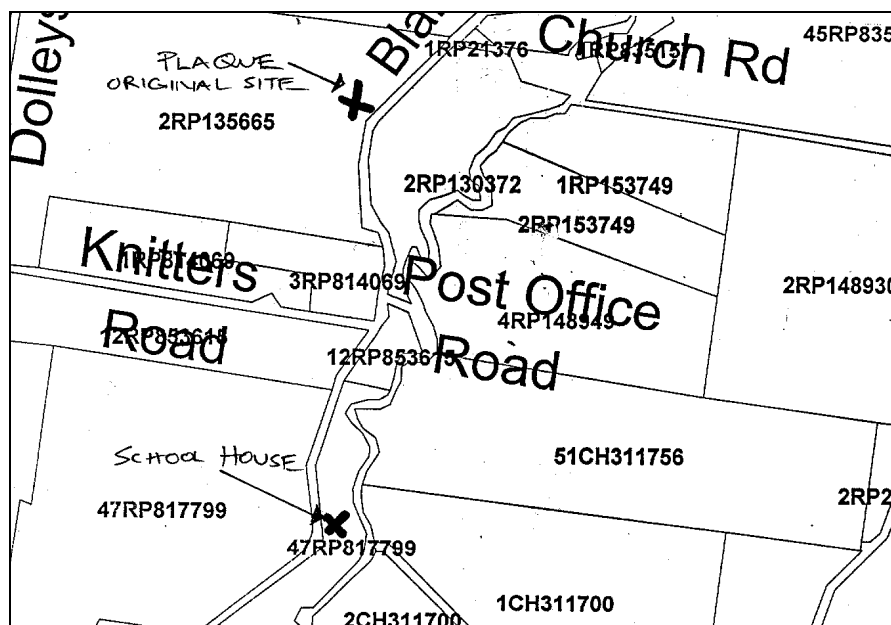

NOTE: This report has been prepared on the basis of evidence examined by the study team and seeks to identify the most important heritage values of the item. The purpose of this report is to provide an initial evaluation. If any action is planned which might affect the cultural heritage significance of this place, advice should be sought through the Gatton Shire Council Planning Branch.

NOTE: This report has been prepared on the basis of evidence examined by the study team and seeks to identify the most important heritage values of the item. The purpose of this report is to provide an initial evaluation. If any action is planned which might affect the cultural heritage significance of this place, advice should be sought through the Gatton Shire Council Planning Branch.

NAME	
CATEGORY	Farmhouse
LOCATION	9214 Blanchview Rd
RPD	2CH311700
LISTING BOUNDARY	House site
OTHER LISTINGS	-
SIGNIFICANCE LEVEL	Local

History:**Description:**

- Short ridge pyramid roof with stepped curved three sides verandah.
- Restored cross braced balustrade
- Original doors and windows

Significance:

Important for its demonstration of aesthetic characteristics and building techniques typical of the late 19th/early 20th century.

The house, with its surrounding trees, contributes aesthetically to the landscape.

Associated Places:**References:****Comments:**

NOTE: This report has been prepared on the basis of evidence examined by the study team and seeks to identify the most important heritage values of the item. The purpose of this report is to provide an initial evaluation. If any action is planned which might affect the cultural heritage significance of this place, advice should be sought through the Gatton Shire Council Planning Branch.

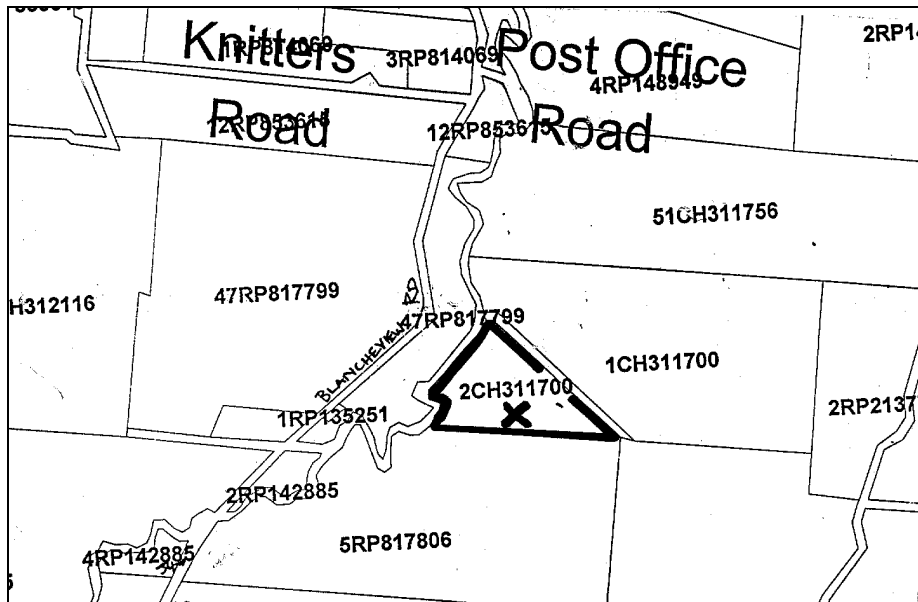

NOTE: This report has been prepared on the basis of evidence examined by the study team and seeks to identify the most important heritage values of the item. The purpose of this report is to provide an initial evaluation. If any action is planned which might affect the cultural heritage significance of this place, advice should be sought through the Gatton Shire Council Planning Branch.

NAME	-
CATEGORY	House
LOCATION	Blanchview Rd
RPD	1RP117062
LISTING BOUNDARY	House only
OTHER LISTINGS	-
SIGNIFICANCE LEVEL	Recorded

History:**Description:**

- Relocated and currently under going refurbishment.
- C1890s pyramid roof with asymmetrical gable and left-hand half-hipped extension, stepped curved L-shaped verandah.
- The building is very noticeable from Blanchview Road.

Significance:

Recorded for its demonstration of aesthetic characteristics and building techniques typical of the late 19th/early 20th century.

When refurbished, it will make an aesthetic contribution to the landscape.

As a removal house, it demonstrates the pattern of history of Gatton Shire and its development.

Associated Places:**References:**

Comments: Might be worthy of a local listing when refurbished

NOTE: This report has been prepared on the basis of evidence examined by the study team and seeks to identify the most important heritage values of the item. The purpose of this report is to provide an initial evaluation. If any action is planned which might affect the cultural heritage significance of this place, advice should be sought through the Gatton Shire Council Planning Branch.

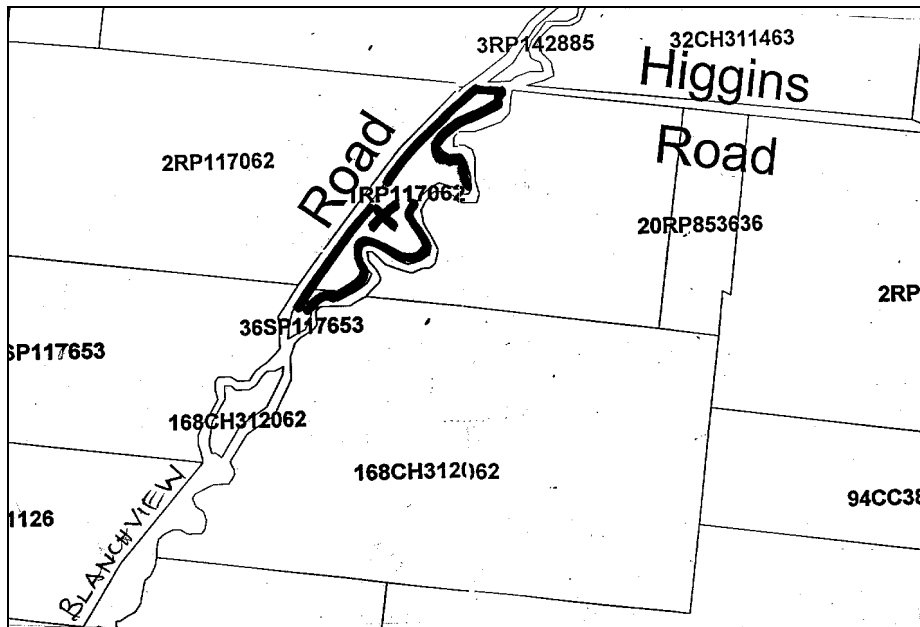

NOTE: This report has been prepared on the basis of evidence examined by the study team and seeks to identify the most important heritage values of the item. The purpose of this report is to provide an initial evaluation. If any action is planned which might affect the cultural heritage significance of this place, advice should be sought through the Gatton Shire Council Planning Branch.

NAME	
CATEGORY	House
LOCATION	Blanchview Rd
RPD	5RP817806
LISTING BOUNDARY	House site
OTHER LISTINGS	-
SIGNIFICANCE LEVEL	Local

History:**Description:**

- C1890s style short ridge pyramid roof cottage with stepped skillion verandah to two sides.
- Verandahs enclosed
- Weatherboard clad with stove alcove evident.
- Low set with batten infill between stumps.

Significance:

Important for its demonstration of aesthetic characteristics and building techniques typical of the late 19th/early 20th century.

The house, with its surrounding trees, contributes aesthetically to the streetscape.

Associated Places:**References:****Comments:**

NOTE: This report has been prepared on the basis of evidence examined by the study team and seeks to identify the most important heritage values of the item. The purpose of this report is to provide an initial evaluation. If any action is planned which might affect the cultural heritage significance of this place, advice should be sought through the Gatton Shire Council Planning Branch.

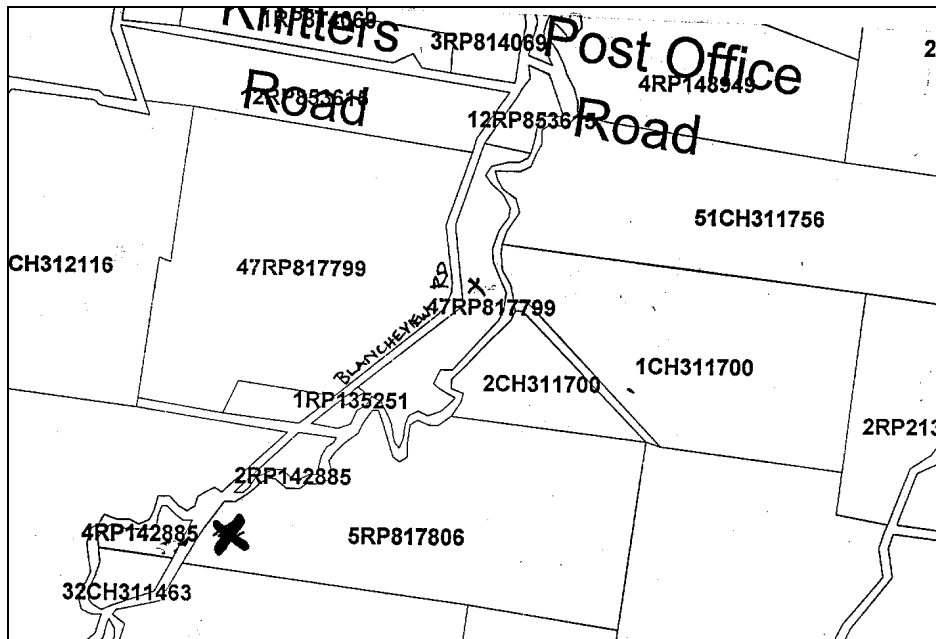

NOTE: This report has been prepared on the basis of evidence examined by the study team and seeks to identify the most important heritage values of the item. The purpose of this report is to provide an initial evaluation. If any action is planned which might affect the cultural heritage significance of this place, advice should be sought through the Gatton Shire Council Planning Branch.

NAME	
CATEGORY	House
LOCATION	Jones St Withcott
RPD	5RP903407
LISTING BOUNDARY	House site
OTHER LISTINGS	-
SIGNIFICANCE LEVEL	Local

History:**Description:**

- C1880s short ridge pyramid roofed cottage with stepped curved front verandah.
- Central entry flanked with paired stop chamfered posts.
- Original verandah detailing lost, new sheeted balustrade.
- Original doors and windows.
- Ornate curved tin window hoods.
- Adjacent to the main road (Warrego Highway)

Significance:

Important for its demonstration of aesthetic characteristics and building techniques typical of the late 19th/early 20th century.

The house, with its surrounding trees and garden, contributes aesthetically to the streetscape.

Associated Places:**References:****Comments:**

NOTE: This report has been prepared on the basis of evidence examined by the study team and seeks to identify the most important heritage values of the item. The purpose of this report is to provide an initial evaluation. If any action is planned which might affect the cultural heritage significance of this place, advice should be sought through the Gatton Shire Council Planning Branch.

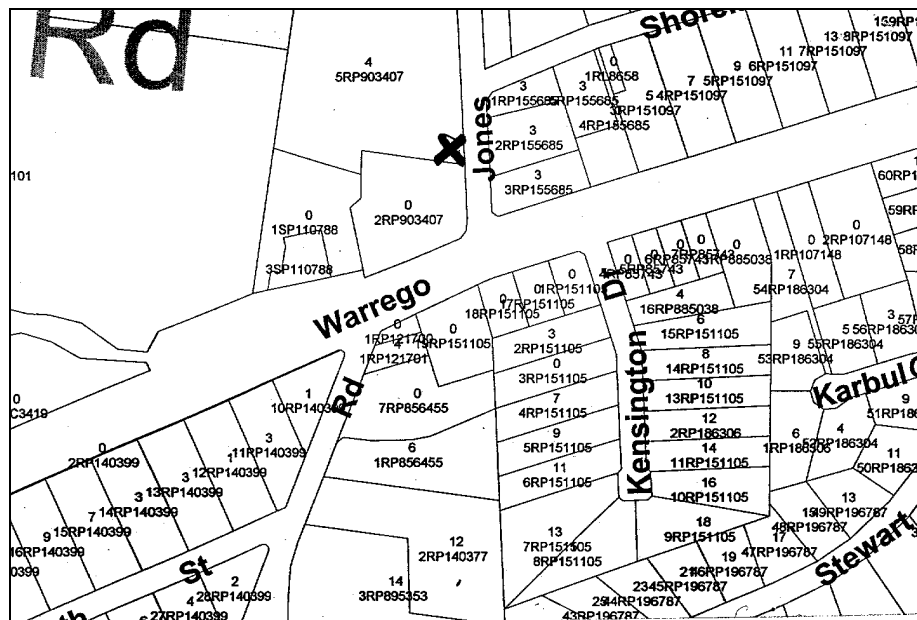

NOTE: This report has been prepared on the basis of evidence examined by the study team and seeks to identify the most important heritage values of the item. The purpose of this report is to provide an initial evaluation. If any action is planned which might affect the cultural heritage significance of this place, advice should be sought through the Gatton Shire Council Planning Branch.

NAME	-
CATEGORY	Farmhouse
LOCATION	Taylors Rd Withcott (at end of road)
RPD	10RP215723
LISTING BOUNDARY	House and outbuilding site
OTHER LISTINGS	-
SIGNIFICANCE LEVEL	Recorded

History:

.

Description:

- A much altered residence with a hip roof section and pyramid roofed section and stepped front verandah.
- Several out buildings including a barn and a creamery .
- Large established garden and water tank with log stand.
- Post and rail fence.

Significance:

Recorded for its demonstration of aesthetic characteristics and building techniques typical of the late 19th/early 20th century.

The house, with its surrounding trees and garden, contributes aesthetically to the landscape.

Associated Places:**References:****Comments:**

NOTE: This report has been prepared on the basis of evidence examined by the study team and seeks to identify the most important heritage values of the item. The purpose of this report is to provide an initial evaluation. If any action is planned which might affect the cultural heritage significance of this place, advice should be sought through the Gatton Shire Council Planning Branch.

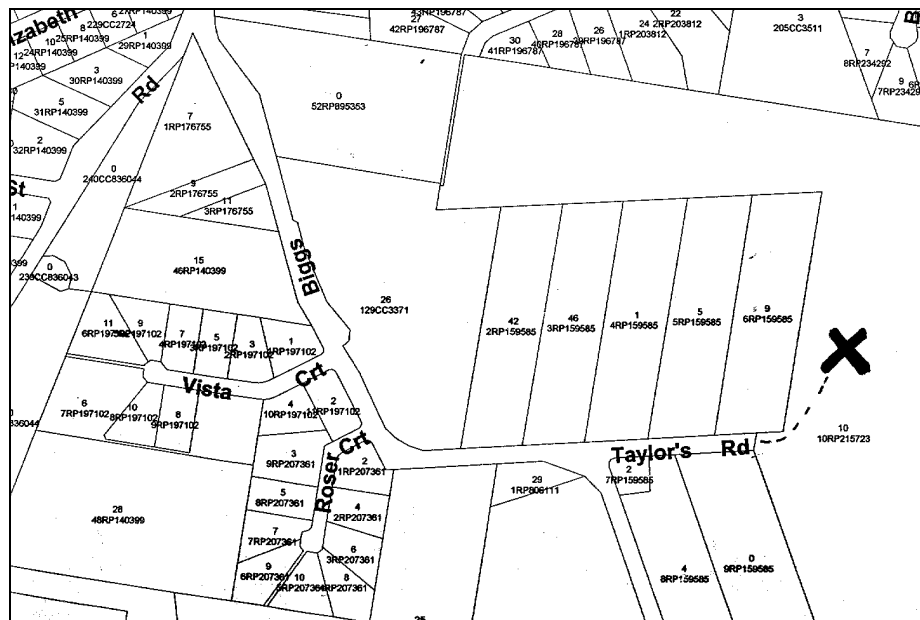

NOTE: This report has been prepared on the basis of evidence examined by the study team and seeks to identify the most important heritage values of the item. The purpose of this report is to provide an initial evaluation. If any action is planned which might affect the cultural heritage significance of this place, advice should be sought through the Gatton Shire Council Planning Branch.

NAME	Scout Hall
CATEGORY	Former School
LOCATION	Roche's Rd (cnr Little Oakey Rd)
RPD	102CC636
LISTING BOUNDARY	Whole site
OTHER LISTINGS	-
SIGNIFICANCE LEVEL	recorded

History:**Description:**

- Gabled ended pitched roof building with incorporated front and side verandahs
- Side verandah enclosed.
- Weatherboard clad.
- Features a bank of six casement windows on gable end with a skillion slatted timber and tin hood.
- High set on log stumps.

Significance:

Recorded as an example of an early country school.

Associated Places:**References:****Comments:**

NOTE: This report has been prepared on the basis of evidence examined by the study team and seeks to identify the most important heritage values of the item. The purpose of this report is to provide an initial evaluation. If any action is planned which might affect the cultural heritage significance of this place, advice should be sought through the Gatton Shire Council Planning Branch.

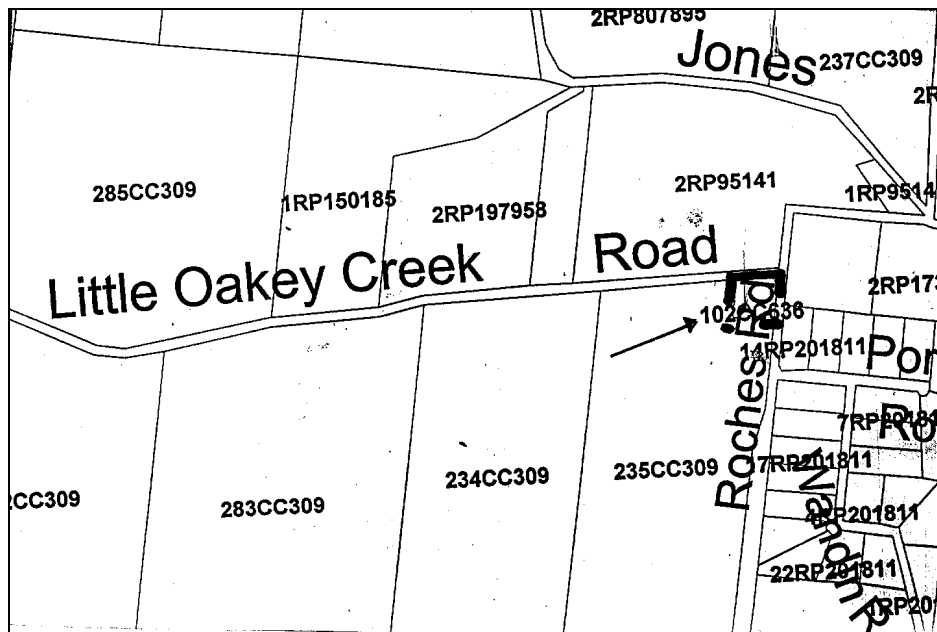

NOTE: This report has been prepared on the basis of evidence examined by the study team and seeks to identify the most important heritage values of the item. The purpose of this report is to provide an initial evaluation. If any action is planned which might affect the cultural heritage significance of this place, advice should be sought through the Gatton Shire Council Planning Branch.

NAME	
CATEGORY	House
LOCATION	Blanchview Rd
RPD	4RP153426
LISTING BOUNDARY	House site
OTHER LISTINGS	-
SIGNIFICANCE LEVEL	Local

History:**Description:**

- C1890s style short ridge pyramid roof with stepped curved verandahs on four sides with the kitchen built to one corner.
- Two rail broomstick balustrade with plain posts.
- High set with timber posts and batten infill.
- Rear glazed enclosed sunroom.
- Several sheds and out buildings located on the right hand side of the house.

Significance:

Recorded for its demonstration of aesthetic characteristics and building techniques typical of the late 19th/early 20th century.

The house, with its surrounding trees and garden, contributes aesthetically to the landscape.

Associated Places:**References:****Comments:**

NOTE: This report has been prepared on the basis of evidence examined by the study team and seeks to identify the most important heritage values of the item. The purpose of this report is to provide an initial evaluation. If any action is planned which might affect the cultural heritage significance of this place, advice should be sought through the Gatton Shire Council Planning Branch.



View to the left side elevation of the house. Blanchview Road runs past behind the trees on the right hand side of picture.

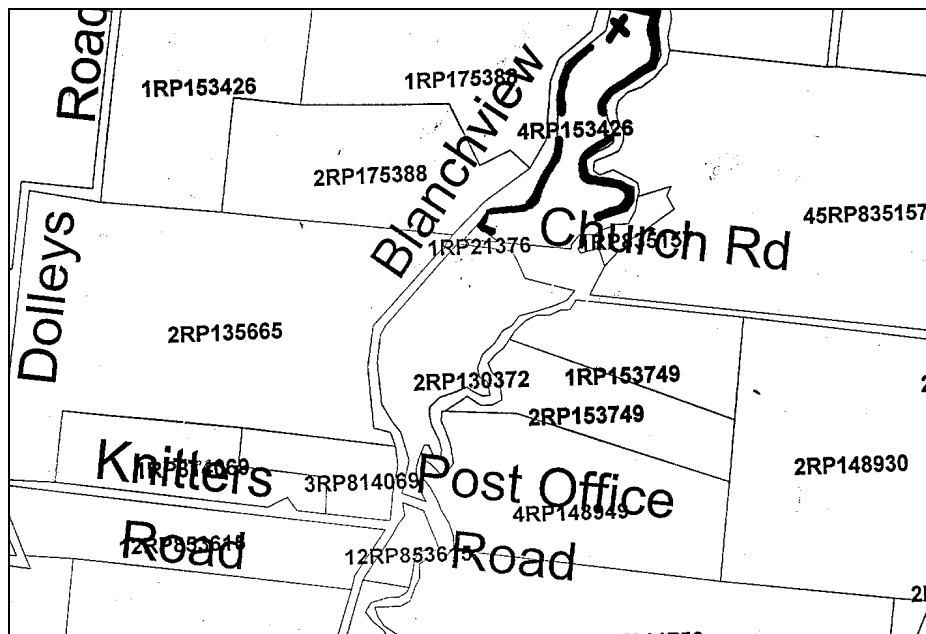

NOTE: This report has been prepared on the basis of evidence examined by the study team and seeks to identify the most important heritage values of the item. The purpose of this report is to provide an initial evaluation. If any action is planned which might affect the cultural heritage significance of this place, advice should be sought through the Gatton Shire Council Planning Branch.

MT SYLVIA

TENT HILL

ROPELEY

“Hopewell”, Lot3/4 Woodlands Road	782
Farmhouse, Manteufels Road	786
House, Tenthill Ck Road (near intersection with Ropely Rd)	788
Farmhouse, Rockside Rd, just past creek crossing	790
Immanuel Lutheran Church, Ropeley	792
Ropeley State School and residence, Cnr Hogers Rd & Ropely-Rockside Rd	796
Farmhouse, Ropely-Rockside Rd, almost opposite Ropely School	800
Farm, Ropely-Rockside Rd	802
Cemetery, Ropely-Rockside Rd	804
Farmhouse, Lot 14, Ropely-Rockside Rd (200m after bitumen ends)	806
Ropeley Apostolic Church, Ropeley, Cnr Steinmuller and Katts Rd	808
Farmhouse, At intersection of Kleidons, Kuss and Steinmullers Rds	810
Ingoldsby Cemetery, Ingoldsby Rd (before Goulds Rd)	812
Old Ingoldsby School House, Ingoldsby Road	814
Caffey Cemetery Caffey Connection Road	816
Cross Lutheran Church, Mt Sylvania, Left Hand Branch Rd (1.3km from Mt Sylvania School)	818
Church Hill Farm, Left Hand Branch Rd, Mt Sylvania	820
Mt Sylvania State School, Cnr Mt Sylvania Rd and Lefthand Branch Rd (a T-junction)	822
Former Mt Sylvania Post Office and residence, 1304 Mt Sylvania Rd	824
Shed, Cnr Left Hand Branch Rd and Mt Sylvania Rd	826
St Patrick’s Catholic Church, Mt Sylvania	828
Farmhouse, 1458 Mt Sylvania Rd (near Hahn’s Crossing)	830
Junction View Public Hall, Mt Sylvania Rd (between West Haldon Rd and Lunds Rd)1km from school	832
Junction View State School and residence, Mt Sylvania Rd	834
“Glenrock”, East Haldon Rd (at end)	836
Graves of William and Sarah Philp, off East Haldon Rd	838
Uniting Church, Lockyer Parish, Mt Sylvania Back.Mt Sylvania Rd	840
Tent Hill Cricket Club Pavilion, Ropehill Rd, beside Bert and Lil Peach Memorial Oval No 2	842
Upper Tent Hill School and residence Upper Tent Hill School Lane	844
Lower Tenthill State School Lower Tenthill Road	846
House, Mt Sylvania Rd (near Tenthill Ck Rd)	848
Tent Hill Hotel, Mt Sylvania Rd, Tent Hill	850
Farmhouse, 400 Mt Sylvania Rd between Tenthill Ck Rd and Upper Tenthill School Lane	852
Farmhouse, 348 Mt Sylvania Rd between Tenthill Ck Rd and Upper Tenthill School Lane	854
” Pepperina Place”, Mt Sylvania	856

NOTE: This report has been prepared on the basis of evidence examined by the study team and seeks to identify the most important heritage values of the item. The purpose of this report is to provide an initial evaluation. If any action is planned which might affect the cultural heritage significance of this place, advice should be sought through the Gatton Shire Council Planning Branch.

NAME	Hopewell
CATEGORY	Farm house
LOCATION	Lot3/4 Woodlands Road
RPD	Lots 3 & 4 RP201231
LISTING BOUNDARY	House site (currently defined by a fenced yard)
OTHER LISTINGS	nil
SIGNIFICANCE LEVEL	Local

History: Kristian and Seraphina Manteufel arrived in Australia from Germany in 1886. Their property was originally 160 acres and they ran it as a dairy farm.

Their original house still survives as the kitchen wing of the existing house which is thought to have been built in the 1890s. Early photos show that it once had a semi-circular pediment.

Their son Emil took over the farm and ran it as a dairy and mixed farm growing a variety of crops including cotton until his death at age 52 at the end of World War II. The property is still owned by a descendant.

The large silky oak near the house was planted in 1935.

Description:

The older (1880s) section is built on log bearers. The stumps continue up as posts to support the frame.

The older section is linked to the main house by a breezeway.

The main house (1890s) is a timber house with exposed stud frame and a pyramid main roof. It is surrounded on four sides by verandahs which have cast iron balustrade.

The house is surrounded by mature trees including silky oak and jacaranda and there is a very old clump of bougainvillea.

Significance:

The house is Important for its demonstration of aesthetic characteristics and building techniques typical of the late 19th century, now becoming rare.

The original house, now the kitchen wing, is an important and rare example of very early and unusual building techniques.

The house, with its surrounding garden, contributes aesthetically to the rural landscape.

The house is associated with an early Gatton family.

Associated Items:

References: Information provided by current owner

Comments:

NOTE: This report has been prepared on the basis of evidence examined by the study team and seeks to identify the most important heritage values of the item. The purpose of this report is to provide an initial evaluation. If any action is planned which might affect the cultural heritage significance of this place, advice should be sought through the Gatton Shire Council Planning Branch.



NOTE: This report has been prepared on the basis of evidence examined by the study team and seeks to identify the most important heritage values of the item. The purpose of this report is to provide an initial evaluation. If any action is planned which might affect the cultural heritage significance of this place, advice should be sought through the Gatton Shire Council Planning Branch.



Stumps on the original houses extend up to become the frame

NOTE: This report has been prepared on the basis of evidence examined by the study team and seeks to identify the most important heritage values of the item. The purpose of this report is to provide an initial evaluation. If any action is planned which might affect the cultural heritage significance of this place, advice should be sought through the Gatton Shire Council Planning Branch.

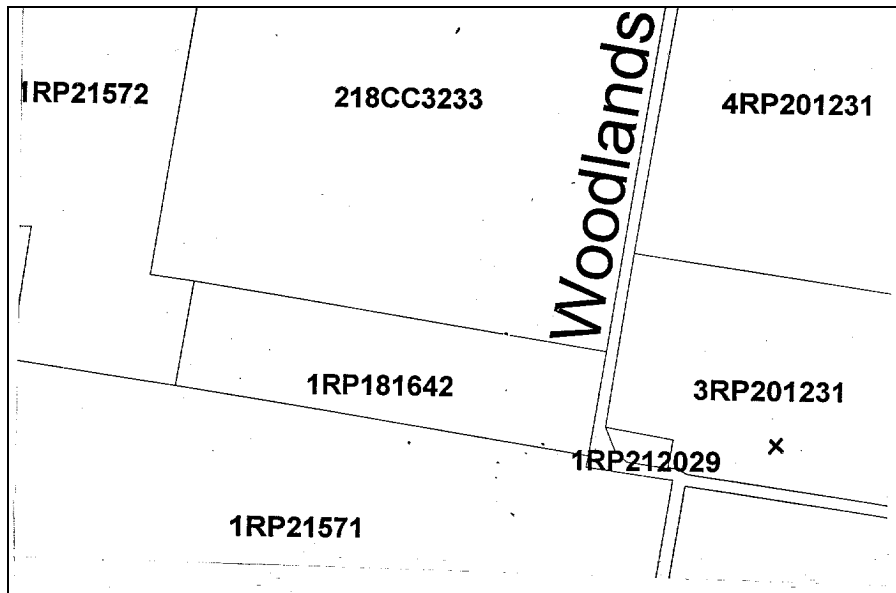

NOTE: This report has been prepared on the basis of evidence examined by the study team and seeks to identify the most important heritage values of the item. The purpose of this report is to provide an initial evaluation. If any action is planned which might affect the cultural heritage significance of this place, advice should be sought through the Gatton Shire Council Planning Branch.

NAME	
CATEGORY	Farm house
LOCATION	Manteufels Road
RPD	1RP135409
LISTING BOUNDARY	House site
OTHER LISTINGS	Nil
SIGNIFICANCE LEVEL	Recorded

History:

Description:

Two houses on property, one c1900, tank at side. An older house is at the rear. Old dairy and sheds are on the property.

Significance:

Important for its demonstration of aesthetic characteristics and building techniques typical of the late 19th/early 20th century, now becoming rare.

The house, with its surrounding trees, contributes aesthetically to the streetscape/rural landscape.

Associated Items:

References:

Comments:.

NOTE: This report has been prepared on the basis of evidence examined by the study team and seeks to identify the most important heritage values of the item. The purpose of this report is to provide an initial evaluation. If any action is planned which might affect the cultural heritage significance of this place, advice should be sought through the Gatton Shire Council Planning Branch.

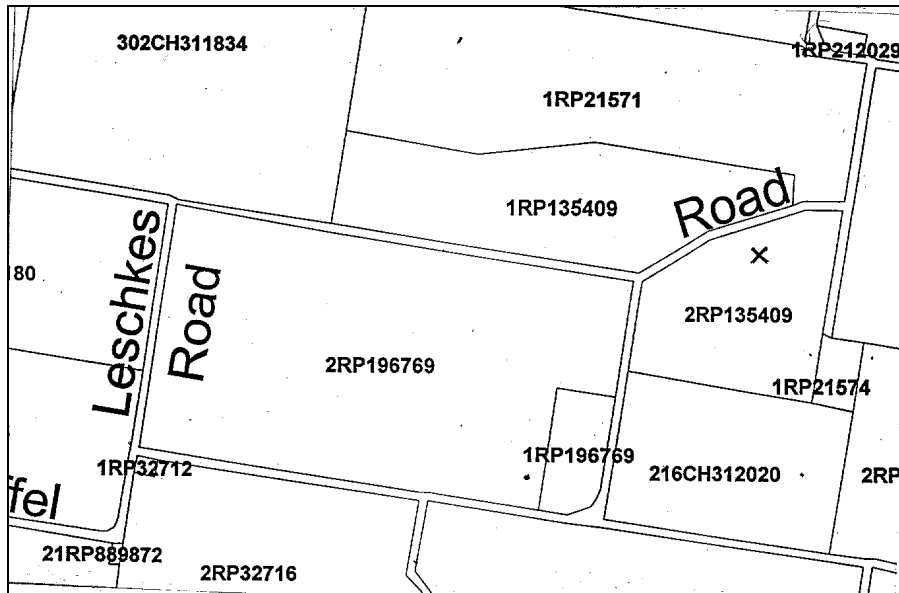

NOTE: This report has been prepared on the basis of evidence examined by the study team and seeks to identify the most important heritage values of the item. The purpose of this report is to provide an initial evaluation. If any action is planned which might affect the cultural heritage significance of this place, advice should be sought through the Gatton Shire Council Planning Branch.

NAME	
CATEGORY	House
LOCATION	Tenthill Ck Road (near intersection with Ropely Rd)
RPD	2RP158513
LISTING BOUNDARY	House site
OTHER LISTINGS	Nil
SIGNIFICANCE LEVEL	Local

History:

Description:

Small cottage with detached kitchen,
weatherboard, steeply pitched roof on both wings, gable ended
Open front and rear verandahs
Corrugated galvanised iron roof

Farm sheds on property

Significance:

Significant as an example of a small cottage with detached kitchen wing, typical of many similar cottages that once existed in the area but are now becoming rare.

The house, with its surrounding farm buildings and trees, contributes aesthetically to the rural landscape.

Associated Items:

References:

Comments:

NOTE: This report has been prepared on the basis of evidence examined by the study team and seeks to identify the most important heritage values of the item. The purpose of this report is to provide an initial evaluation. If any action is planned which might affect the cultural heritage significance of this place, advice should be sought through the Gatton Shire Council Planning Branch.

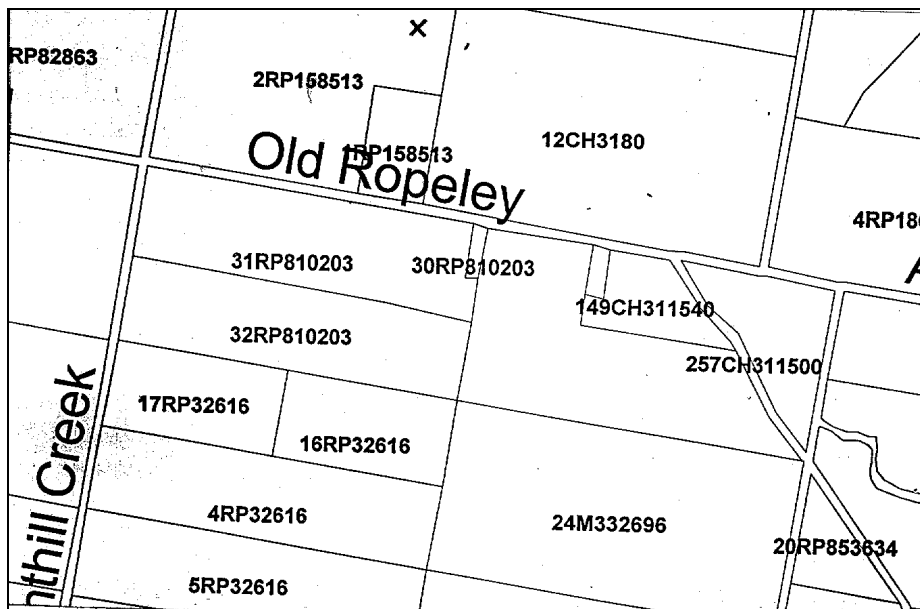

NOTE: This report has been prepared on the basis of evidence examined by the study team and seeks to identify the most important heritage values of the item. The purpose of this report is to provide an initial evaluation. If any action is planned which might affect the cultural heritage significance of this place, advice should be sought through the Gatton Shire Council Planning Branch.

NAME	
CATEGORY	Farm house
LOCATION	Rockside Rd, just past creek crossing
RPD	185RP886115
LISTING BOUNDARY	House site
OTHER LISTINGS	Nil
SIGNIFICANCE LEVEL	Recorded

History:**Description:**

- C1910 house, gable ended on the western side with possible later extensions and attached garage
- Front wall vertical TGVJ
- Double hung windows, metal window hoods
- House yard fenced with pipe and wire fence
- Farm outbuildings include slab barn, slab milking bails, typical square cream shed, corrugated galvanised iron sheds

Significance:

Important for its demonstration of aesthetic characteristics and building techniques typical of the early 20th century.

The surrounding farm buildings demonstrate early building techniques and have the ability to yield information about early farming practices.

Associated Items:**References:****Comments:**

NOTE: This report has been prepared on the basis of evidence examined by the study team and seeks to identify the most important heritage values of the item. The purpose of this report is to provide an initial evaluation. If any action is planned which might affect the cultural heritage significance of this place, advice should be sought through the Gatton Shire Council Planning Branch.

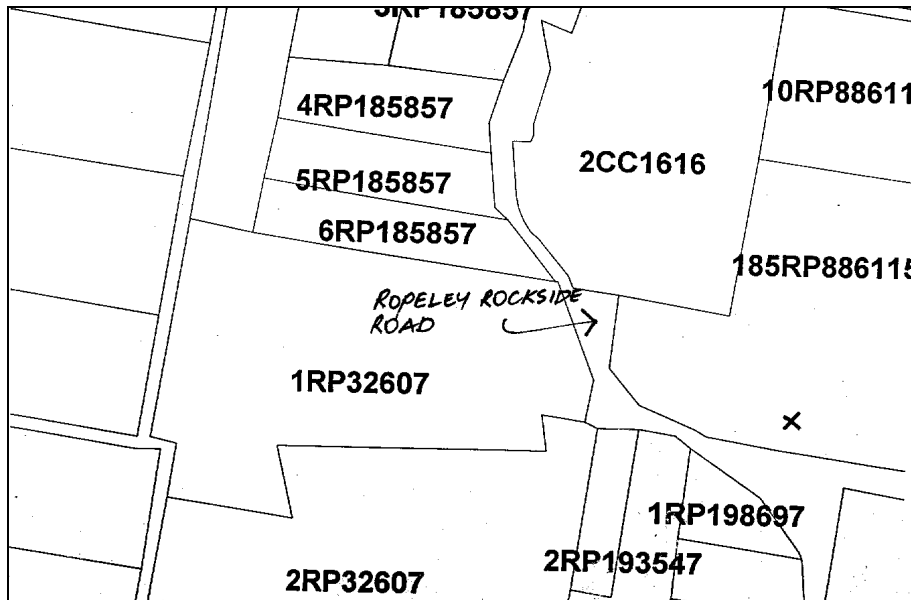

NOTE: This report has been prepared on the basis of evidence examined by the study team and seeks to identify the most important heritage values of the item. The purpose of this report is to provide an initial evaluation. If any action is planned which might affect the cultural heritage significance of this place, advice should be sought through the Gatton Shire Council Planning Branch.

NAME	Immanuel Lutheran Church, Ropeley
CATEGORY	Church complex
LOCATION	Ropeley-Rockside Rd
RPD	1RP58307
LISTING BOUNDARY	Whole of site
OTHER LISTINGS	Nil
SIGNIFICANCE LEVEL	Local

History:Church

A Lutheran church was built at Ropeley in 1889. The current church is a replacement.

Hall

A plaque on the hall states that a bequest from C.L.D. Wittenberg enabled it to be built.

Tree plantings

Most of the trees were planted by youth groups in the 1940s

Description:Church:

Typical gable-ended timber-framed building with steeply pitched roof and lancet windows

Clad in vinyl sheeting

Front and side porches, separate vestry

Buttresses along sides (added after a storm shifted the building on its stumps)

The interior is lined with clear pine boarding and has a raised altar-sanctuary. Collar tie ceiling. The pews are pine and there is an original pine pulpit. The front door leading into the entry porch is grained.

Hall:

Lowset weatherboard-clad building

front gable and rear hip corrugated galvanised iron roof

8-pane casement windows

Front and side porches have typical 1930s jettied box gable ends

kitchen annexe attached to side

The interior is lined with TGVJ and has a raised stage

Manse

Typical Californian bungalow style

Lowset

Coloured glass in windows

Shelter shed

Gable-roofed open shed

Post frame. Corrugated galvanised iron roof and rear wall

Situated between the hall and the church

Toilet block:

a skillion-roofed toilet block is at the rear of the hall

Graveyard

The graveyard contains substantial headstones, the majority bearing German names; some are in the German language

NOTE: This report has been prepared on the basis of evidence examined by the study team and seeks to identify the most important heritage values of the item. The purpose of this report is to provide an initial evaluation. If any action is planned which might affect the cultural heritage significance of this place, advice should be sought through the Gatton Shire Council Planning Branch.

Plantings

The front boundary is marked with a row of hoop pines and other rows of hoop pines lead to the graveyard.

Significance:

Significant as a good and rare example of an intact country church complex in an isolated position, containing a church, hall, shelter shed, residence, graveyard and major tree plantings.

It is important in exhibiting a range of aesthetic characteristics valued by the local community, in particular the traditional form and scale of the buildings. The trees, including formal rows of mature hoop pines, are an important part of the setting.

The complex makes an important contribution to the rural landscape.

It has a strong association with the spiritual and social life of the surrounding community.

Associated Items:**References:**

Comments: This is an attractive and cohesive complex



NOTE: This report has been prepared on the basis of evidence examined by the study team and seeks to identify the most important heritage values of the item. The purpose of this report is to provide an initial evaluation. If any action is planned which might affect the cultural heritage significance of this place, advice should be sought through the Gatton Shire Council Planning Branch.



NOTE: This report has been prepared on the basis of evidence examined by the study team and seeks to identify the most important heritage values of the item. The purpose of this report is to provide an initial evaluation. If any action is planned which might affect the cultural heritage significance of this place, advice should be sought through the Gatton Shire Council Planning Branch.

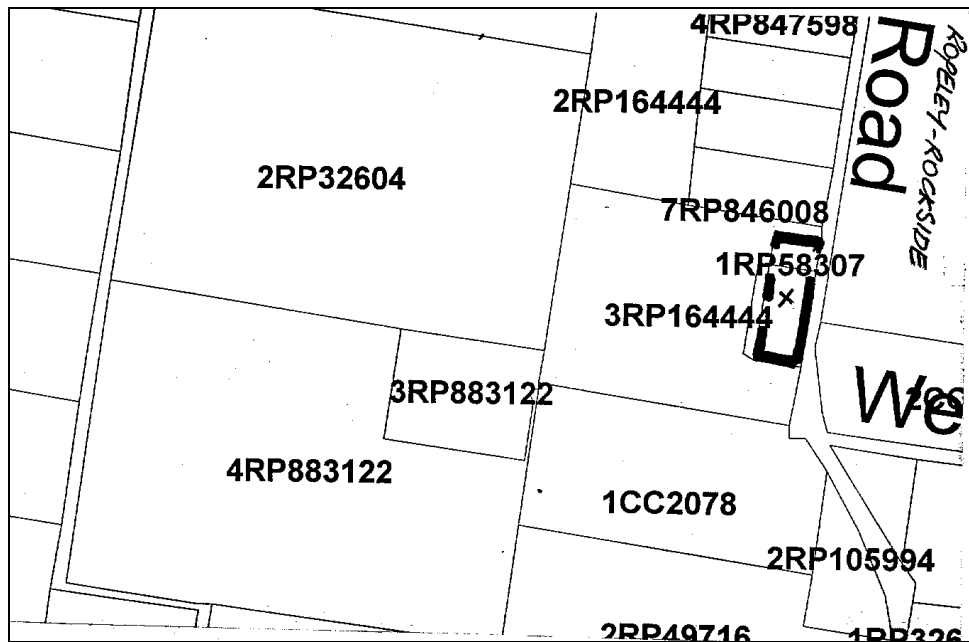

NOTE: This report has been prepared on the basis of evidence examined by the study team and seeks to identify the most important heritage values of the item. The purpose of this report is to provide an initial evaluation. If any action is planned which might affect the cultural heritage significance of this place, advice should be sought through the Gatton Shire Council Planning Branch.

NAME	Ropeley State School and residence
CATEGORY	School
LOCATION	Cnr Hogers Rd and Ropely-Rockside Rd
RPD	1RP32695
LISTING BOUNDARY	Whole of site
OTHER LISTINGS	Nil
SIGNIFICANCE LEVEL	Local

History:

The school was opened in July 1890 as Deep Gully School, but the name was changed to Ropeley in 1892 to avoid confusion with Deep Creek near Fernvale.

A new school building was constructed in 1902 when the former provisional school was elevated to school status. A playshed was built in 1907.

The school was originally on the eastern side of Deep Gully but it was shifted to its present site on the western side and re-opened in March 1938.

A new library and classroom were officially opened in January 1971.

Description:School

Highset school building

Verandah front and back, slatted balustrade, front partly enclosed

Casement windows in gable end with timber-framed corrugated galvanised iron hood

Concrete stumps

Built in underneath with metal and glass louvres

Newer classroom blocks

Elevated toilet block near tennis court

Open pyramid-roofed play shelter

Mature trees in grounds

Residence

Typical interwar style

Significance:

Significant as a good and intact example of an early country school, demonstrating many of the typical features including classrooms, residence, playshed, tennis court and tree plantings.

It is important for its demonstration of traditional forms and materials and, with its landscaping, it makes an aesthetic contribution to the rural landscape.

Important for its association with the educational and social life of the local community over a long period.

Associated Places:

References: Helen Bennett *Gatton Shire Thematic Historical Overview* Cultural Heritage Branch EPA 1999

Comments:

NOTE: This report has been prepared on the basis of evidence examined by the study team and seeks to identify the most important heritage values of the item. The purpose of this report is to provide an initial evaluation. If any action is planned which might affect the cultural heritage significance of this place, advice should be sought through the Gatton Shire Council Planning Branch.



NOTE: This report has been prepared on the basis of evidence examined by the study team and seeks to identify the most important heritage values of the item. The purpose of this report is to provide an initial evaluation. If any action is planned which might affect the cultural heritage significance of this place, advice should be sought through the Gatton Shire Council Planning Branch.

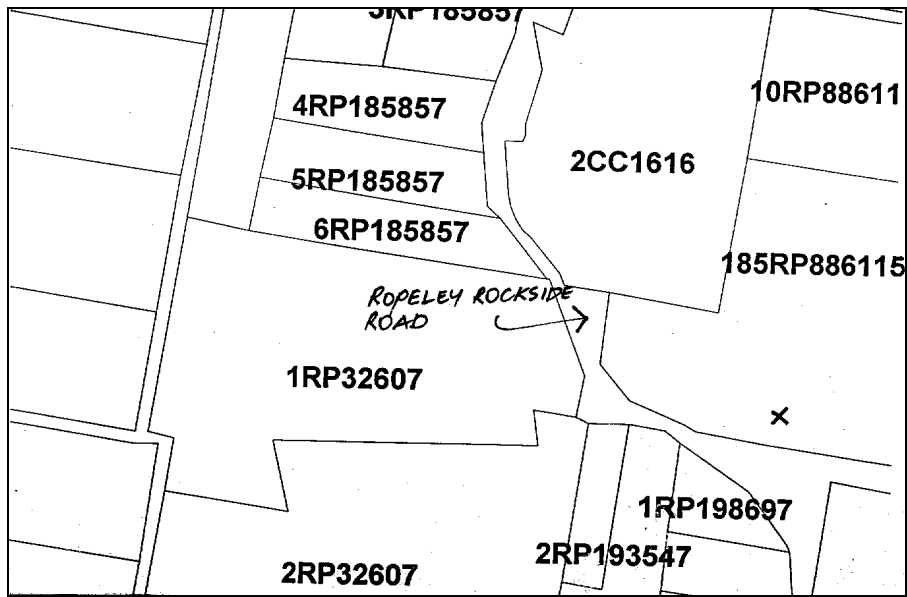

NOTE: This report has been prepared on the basis of evidence examined by the study team and seeks to identify the most important heritage values of the item. The purpose of this report is to provide an initial evaluation. If any action is planned which might affect the cultural heritage significance of this place, advice should be sought through the Gatton Shire Council Planning Branch.

NOTE: This report has been prepared on the basis of evidence examined by the study team and seeks to identify the most important heritage values of the item. The purpose of this report is to provide an initial evaluation. If any action is planned which might affect the cultural heritage significance of this place, advice should be sought through the Gatton Shire Council Planning Branch.

NAME	
CATEGORY	Farm house
LOCATION	Ropely-Rockside Rd, almost opposite Ropely School
RPD	157CC1831
LISTING BOUNDARY	House site
OTHER LISTINGS	-
SIGNIFICANCE LEVEL	Recorded

History:

Olm family farm

Description:

A typical older farm complex of this district. House possibly c1890, verandah front and side, detached kitchen with brick chimney

Slab and corrugated galvanised iron outbuildings

Slab barn, cream shed

Yards

Very large fig trees

Significance:

The house is Important for its demonstration of aesthetic characteristics and building techniques typical of the late 19th century, now becoming rare.

The house, with its surrounding farm buildings and large fig trees, contributes aesthetically to the rural landscape.

The surrounding farm buildings demonstrate early building techniques and some have the ability to yield information about early farming practices.

The house is associated with an early Gatton family.

Associated Items:**References:****Comments:**

NOTE: This report has been prepared on the basis of evidence examined by the study team and seeks to identify the most important heritage values of the item. The purpose of this report is to provide an initial evaluation. If any action is planned which might affect the cultural heritage significance of this place, advice should be sought through the Gatton Shire Council Planning Branch.

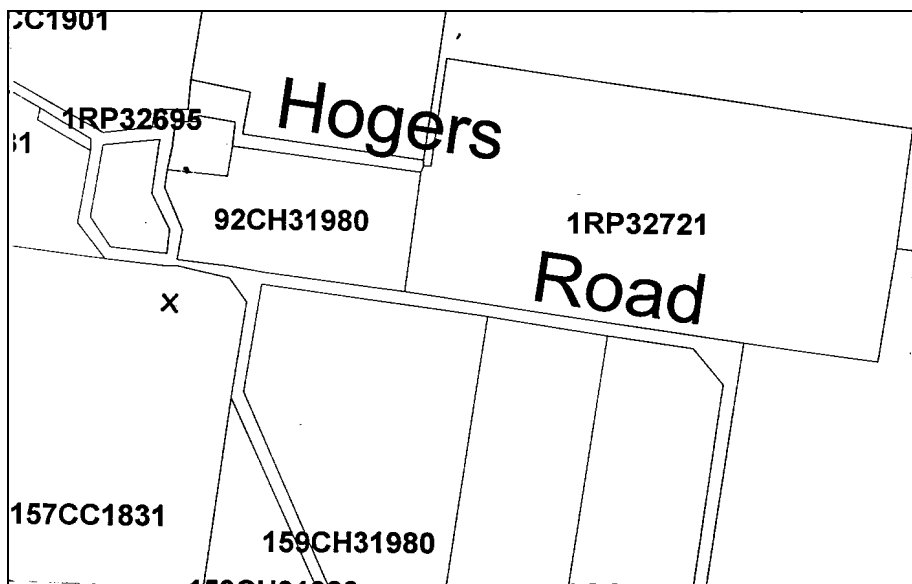

NOTE: This report has been prepared on the basis of evidence examined by the study team and seeks to identify the most important heritage values of the item. The purpose of this report is to provide an initial evaluation. If any action is planned which might affect the cultural heritage significance of this place, advice should be sought through the Gatton Shire Council Planning Branch.

NAME	
CATEGORY	Farm
LOCATION	Ropely-Rockside Rd
RPD	159CH31980
LISTING BOUNDARY	House site
OTHER LISTINGS	-
SIGNIFICANCE LEVEL	recorded

History: Owners have been Connelly, Katt, Olm and Schulz (since c1954)

Description:

House c1890
Old barns and outbuildings
Huge fig tree

Significance:

The house is important for its demonstration of aesthetic characteristics and building techniques typical of the late 19th century, now becoming rare.

The surrounding farm buildings demonstrate early building techniques and have the ability to yield information about early farming practices.

The house is associated with early Gatton families.

Associated Items:

References:

Comments:.

NOTE: This report has been prepared on the basis of evidence examined by the study team and seeks to identify the most important heritage values of the item. The purpose of this report is to provide an initial evaluation. If any action is planned which might affect the cultural heritage significance of this place, advice should be sought through the Gatton Shire Council Planning Branch.

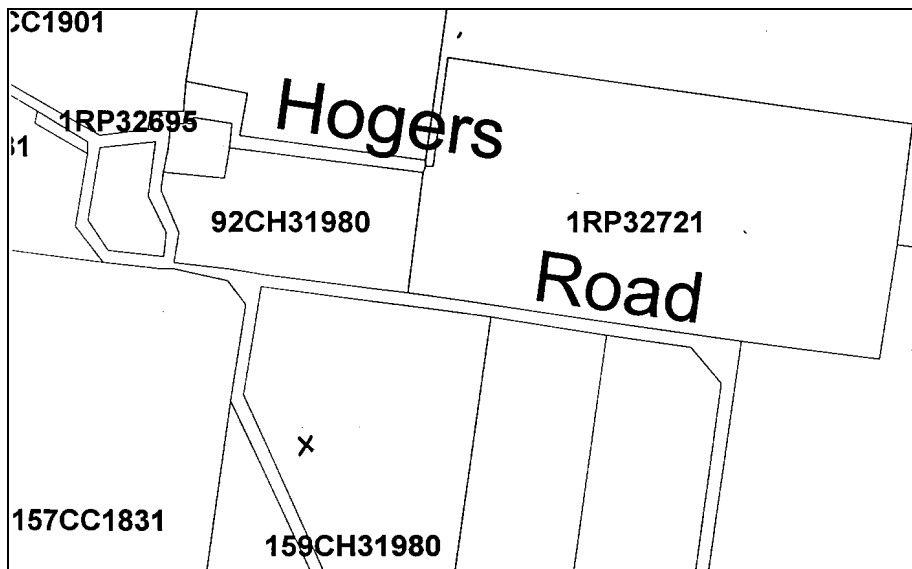

NOTE: This report has been prepared on the basis of evidence examined by the study team and seeks to identify the most important heritage values of the item. The purpose of this report is to provide an initial evaluation. If any action is planned which might affect the cultural heritage significance of this place, advice should be sought through the Gatton Shire Council Planning Branch.

NAME	Lutheran Cemetery
CATEGORY	Cemetery
LOCATION	Ropely-Rockside Rd
RPD	2RP32605
LISTING BOUNDARY	House site
OTHER LISTINGS	
SIGNIFICANCE LEVEL	Local

History:**Description:**

Small cemetery

Many graves fenced with iron lace panels on a brick or timber base, some timber bases recently replaced

Some head markers are cast iron plaques

Many German names, some inscriptions are in the German language

Most graves c1900, oldest believed to be 1884

Surrounded by a pipe and chain wire fence

Significance:

Important for its demonstration of the characteristics of a small country cemetery; for its association with the social and spiritual evolution of the surrounding district; and for its ability to yield information on local social history and the family history of local residents, particularly the German residents of the community.

The large proportion of cast iron burial markers with raised inscriptions, some in the German language, is uncommon.

Associated Items:**References:****Comments:**

NOTE: This report has been prepared on the basis of evidence examined by the study team and seeks to identify the most important heritage values of the item. The purpose of this report is to provide an initial evaluation. If any action is planned which might affect the cultural heritage significance of this place, advice should be sought through the Gatton Shire Council Planning Branch.

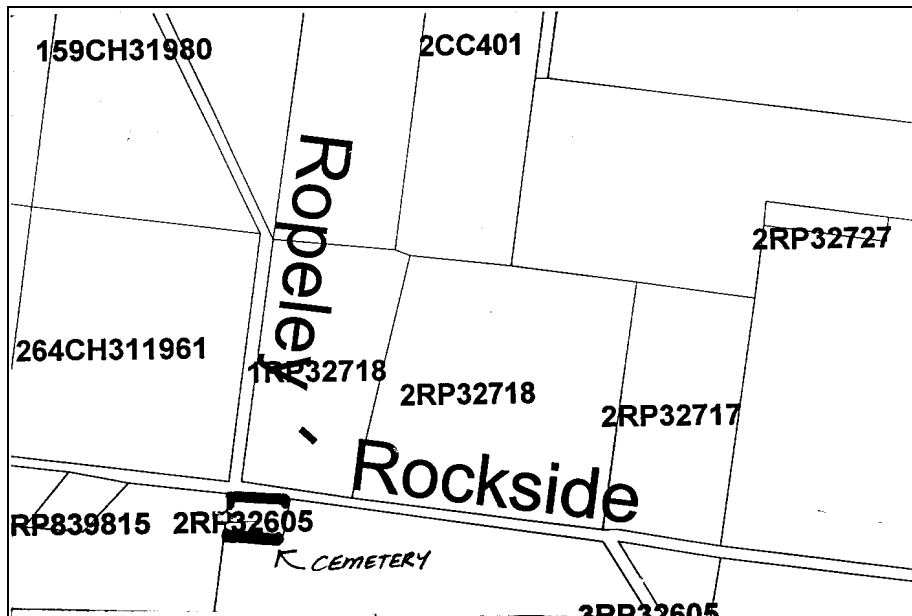

NOTE: This report has been prepared on the basis of evidence examined by the study team and seeks to identify the most important heritage values of the item. The purpose of this report is to provide an initial evaluation. If any action is planned which might affect the cultural heritage significance of this place, advice should be sought through the Gatton Shire Council Planning Branch.

NAME	
CATEGORY	farmhouse
LOCATION	Lot 14, Ropely-Rockside Rd (200m after bitumen ends)
RPD	14RP802572
LISTING BOUNDARY	House site
OTHER LISTINGS	
SIGNIFICANCE LEVEL	House local; farm buildings recorded

History:**Description:**

Timber house

Pyramid roof extends across verandahs which have a slatted balustrade

Slab building and other farm buildings in quite good condition

Large fig tree beside house

Significance:

Important for its demonstration of early form and materials and for its demonstration of early building techniques.

The house, with its surrounding garden, trees and outbuildings, contributes aesthetically to the rural landscape.

The surrounding farm buildings demonstrate early building techniques and have the ability to yield information about early farming practices.

Associated Items:**References:****Comments:.**

NOTE: This report has been prepared on the basis of evidence examined by the study team and seeks to identify the most important heritage values of the item. The purpose of this report is to provide an initial evaluation. If any action is planned which might affect the cultural heritage significance of this place, advice should be sought through the Gatton Shire Council Planning Branch.

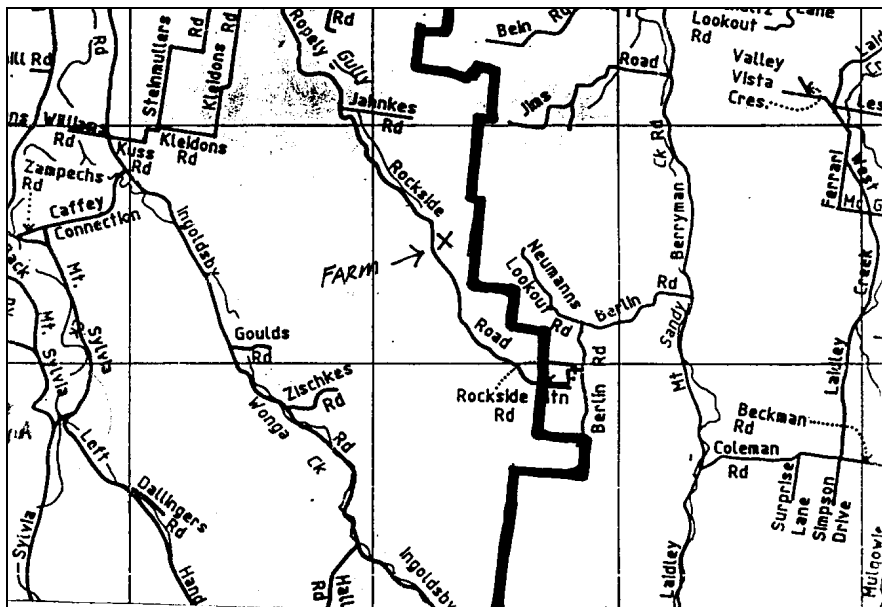

NOTE: This report has been prepared on the basis of evidence examined by the study team and seeks to identify the most important heritage values of the item. The purpose of this report is to provide an initial evaluation. If any action is planned which might affect the cultural heritage significance of this place, advice should be sought through the Gatton Shire Council Planning Branch.

NAME	Ropeley Apostolic Church, Ropeley
CATEGORY	Church
LOCATION	Cnr Steinmuller and Katts Rd
RPD	7RP880414
LISTING BOUNDARY	House site
OTHER LISTINGS	
SIGNIFICANCE LEVEL	local

History:**Description:**

Weatherboard church on concrete stumps, battened underneath
 Casement windows
 small bell tower with acroterions, topped with a weathervane
 front porch
 corrugated galvanised iron roof
 Rear skillion extension
 Grounds contains a bottle tree, pencil pines and Norfolk pine

Significance:

Significant as an example of a simple country church.

It is important in exhibiting a range of aesthetic characteristics valued by the local community, in particular the building's traditional form, scale and materials.

Important for its contribution to the rural landscape.

It has a strong association with the spiritual and social life of the surrounding community.

Associated Items:**References:****Comments:.**

NOTE: This report has been prepared on the basis of evidence examined by the study team and seeks to identify the most important heritage values of the item. The purpose of this report is to provide an initial evaluation. If any action is planned which might affect the cultural heritage significance of this place, advice should be sought through the Gatton Shire Council Planning Branch.

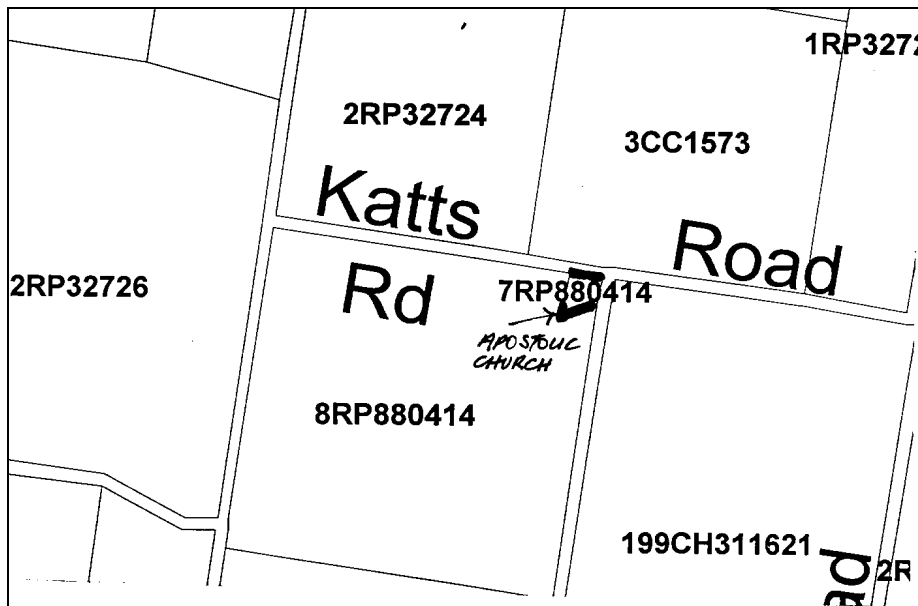

NOTE: This report has been prepared on the basis of evidence examined by the study team and seeks to identify the most important heritage values of the item. The purpose of this report is to provide an initial evaluation. If any action is planned which might affect the cultural heritage significance of this place, advice should be sought through the Gatton Shire Council Planning Branch.

NAME	
CATEGORY	Farm
LOCATION	At intersection of Kleidons, Kuss and Steinmullers Rds
RPD	214CH311758
LISTING BOUNDARY	House site
OTHER LISTINGS	-
SIGNIFICANCE LEVEL	local

History:**Description:**

Substantial modified interwar house
Open front verandah, Battened skirt

Significance:

The house is significant as a good example of the use of materials, form and detailing typical of the interwar period.

Associated Items:**References:****Comments:.**

NOTE: This report has been prepared on the basis of evidence examined by the study team and seeks to identify the most important heritage values of the item. The purpose of this report is to provide an initial evaluation. If any action is planned which might affect the cultural heritage significance of this place, advice should be sought through the Gatton Shire Council Planning Branch.



NOTE: This report has been prepared on the basis of evidence examined by the study team and seeks to identify the most important heritage values of the item. The purpose of this report is to provide an initial evaluation. If any action is planned which might affect the cultural heritage significance of this place, advice should be sought through the Gatton Shire Council Planning Branch.

NAME	Ingoldsby Cemetery
CATEGORY	Cemetery
LOCATION	Ingoldsby Rd (near Goulds Rd)
RPD	RP36786
LISTING BOUNDARY	Whole site
OTHER LISTINGS	
SIGNIFICANCE LEVEL	Local

History:

The cemetery was once a graveyard in the grounds of St Paul's Lutheran Church

Description:

Small country graveyard, graves are at rear of the site.
Remains of a wire and timber fence
Early gate
Dead trunks of two hoop pines on the front alignment

Significance:

Important for its demonstration of the characteristics of a small country cemetery; for its association with the social and spiritual evolution of the surrounding district; and for its ability to yield information on local social history and the family history of local residents.

Associated Items:**References:****Comments:**

NOTE: This report has been prepared on the basis of evidence examined by the study team and seeks to identify the most important heritage values of the item. The purpose of this report is to provide an initial evaluation. If any action is planned which might affect the cultural heritage significance of this place, advice should be sought through the Gatton Shire Council Planning Branch.

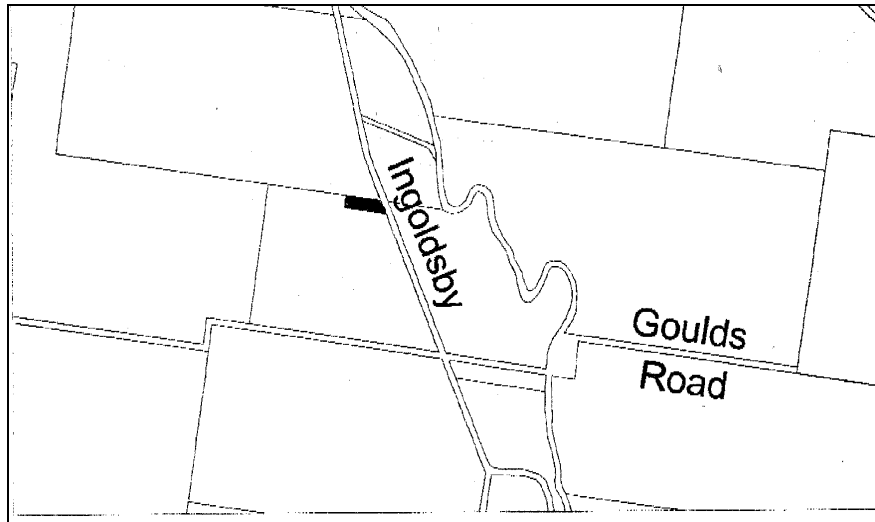

NOTE: This report has been prepared on the basis of evidence examined by the study team and seeks to identify the most important heritage values of the item. The purpose of this report is to provide an initial evaluation. If any action is planned which might affect the cultural heritage significance of this place, advice should be sought through the Gatton Shire Council Planning Branch.

NAME	Old Ingoldsby School House
CATEGORY	House, former school residence
LOCATION	1128 Ingoldsby Rd
RPD	
LISTING BOUNDARY	House site
OTHER LISTINGS	-
SIGNIFICANCE LEVEL	Local

History:

The school opened as Hessenberg Provisional School in June 1894. The name was changed to Ingoldsby during World War, one of a number of names changed due to anti-German feeling.

The school is now closed. The original school building is believed to be part of the existing school residence, now used as a private residence. Part of the residence was used as a post office and evidence of this still exists.

Description:

Gabled, lowset weatherboard school house
 Timber stumps
 Open front and side verandahs
 Corrugated galvanised iron roof
 Window hoods
 Open-sided hip-roof shelter shed and a small building, possibly former toilets, still remain on site

Significance:

Important for its demonstration of aesthetic characteristics and building techniques typical of the late 19th century, now becoming rare.

The house, with its surrounding trees, contributes aesthetically to the rural landscape.

Associated Items:**References:****Comments:**

The school is managed by a local committee and is currently occupied by a caretaker.

NOTE: This report has been prepared on the basis of evidence examined by the study team and seeks to identify the most important heritage values of the item. The purpose of this report is to provide an initial evaluation. If any action is planned which might affect the cultural heritage significance of this place, advice should be sought through the Gatton Shire Council Planning Branch.

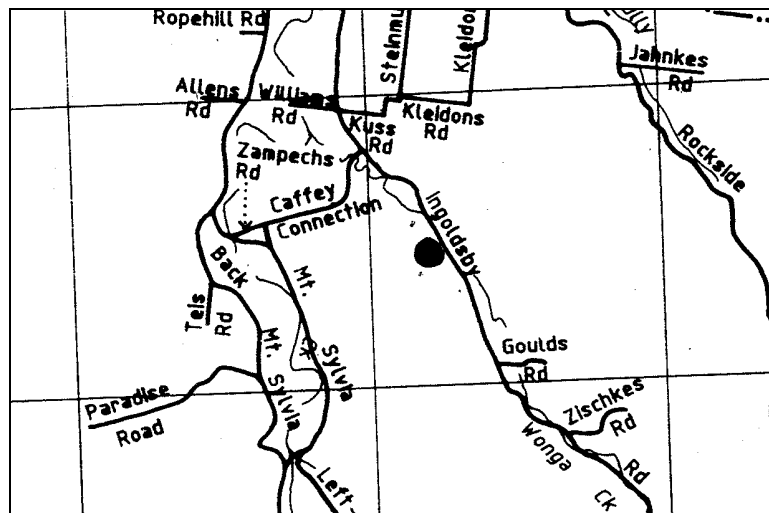

NOTE: This report has been prepared on the basis of evidence examined by the study team and seeks to identify the most important heritage values of the item. The purpose of this report is to provide an initial evaluation. If any action is planned which might affect the cultural heritage significance of this place, advice should be sought through the Gatton Shire Council Planning Branch.

NAME	Caffey Cemetery
CATEGORY	Cemetery
LOCATION	Caffey Connection Road
RPD	227CC466
LISTING BOUNDARY	Whole of site
OTHER LISTINGS	
SIGNIFICANCE LEVEL	Local

History:

The cemetery reserve had been set aside by 1925.

Description:

Small cemetery, some substantial headstones including marble cherub and one large sandstone monument
 Unfenced at front
 Boundary lined with small trees

Significance:

Important for its demonstration of the characteristics of a small country cemetery; for its association with the social and spiritual evolution of the surrounding district; and for its ability to yield information on the history of local families and the general social history of the Shire.

Associated Items:

References: Helen Bennett *Gatton Shire Thematic Historical Overview* Cultural Heritage Branch EPA 1999

Comments:

NOTE: This report has been prepared on the basis of evidence examined by the study team and seeks to identify the most important heritage values of the item. The purpose of this report is to provide an initial evaluation. If any action is planned which might affect the cultural heritage significance of this place, advice should be sought through the Gatton Shire Council Planning Branch.

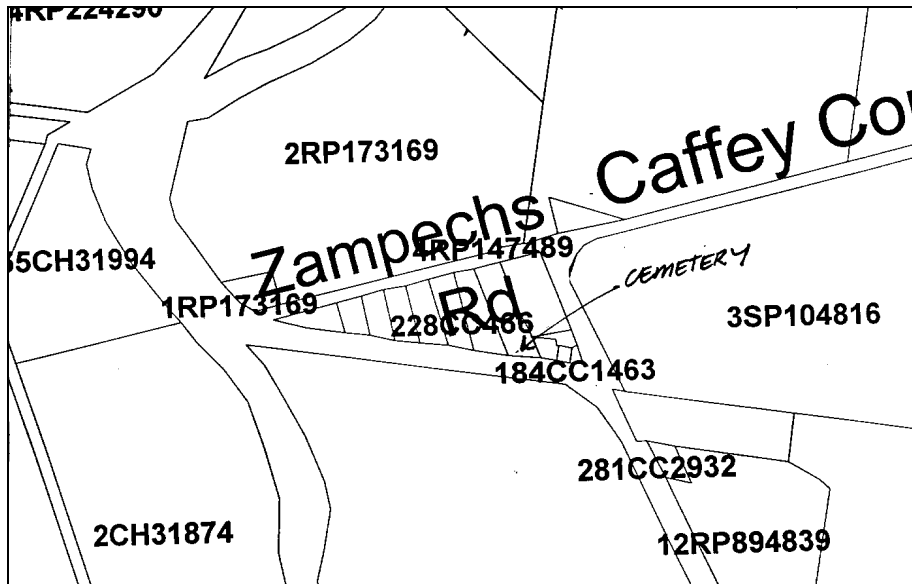

NOTE: This report has been prepared on the basis of evidence examined by the study team and seeks to identify the most important heritage values of the item. The purpose of this report is to provide an initial evaluation. If any action is planned which might affect the cultural heritage significance of this place, advice should be sought through the Gatton Shire Council Planning Branch.

NAME	Cross Lutheran Church, Mt Sylvia
CATEGORY	Church
LOCATION	Left Hand Branch Rd (1.3km from Mt Sylvia School)
RPD	1RP36829
LISTING BOUNDARY	Whole site
OTHER LISTINGS	
SIGNIFICANCE LEVEL	local

History:**Description:**

Small simple church, gable ends, steeply pitched roof,
 Clad in vinyl panelling
 Square windows with round-headed obscure glass
 Positioned at the top of a small knoll, accessed by a set of sandstone steps bordered with pencil pines
 Toilet at rear

Significance:

Significant as a good example of a simple country church.

It is important in exhibiting a range of aesthetic characteristics valued by the local community, in particular the building's traditional form, scale and materials.

With its line of trees, it is important for its contribution to the rural landscape.

It has a strong association with the spiritual and social life of the surrounding community.

Associated places:

House and trees adjacent form an attractive small precinct

References:**Comments:.**

NOTE: This report has been prepared on the basis of evidence examined by the study team and seeks to identify the most important heritage values of the item. The purpose of this report is to provide an initial evaluation. If any action is planned which might affect the cultural heritage significance of this place, advice should be sought through the Gatton Shire Council Planning Branch.

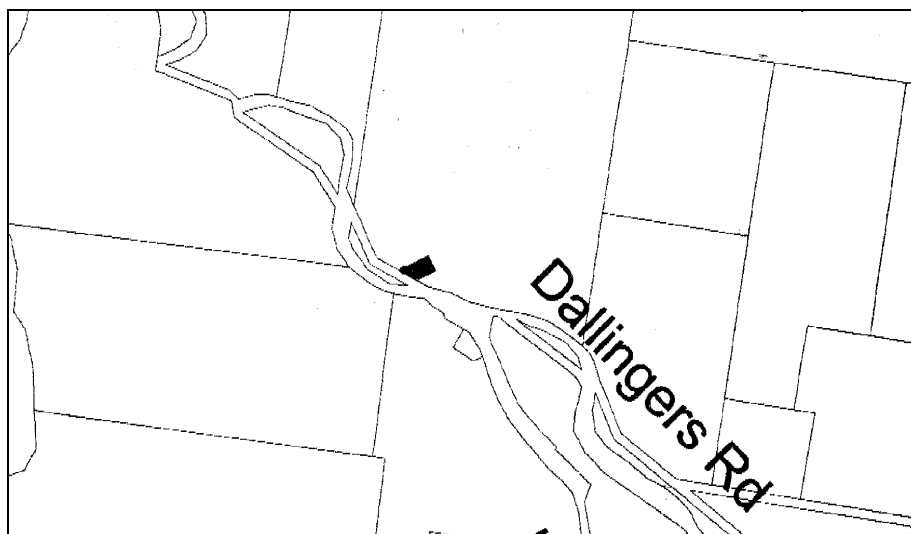

NOTE: This report has been prepared on the basis of evidence examined by the study team and seeks to identify the most important heritage values of the item. The purpose of this report is to provide an initial evaluation. If any action is planned which might affect the cultural heritage significance of this place, advice should be sought through the Gatton Shire Council Planning Branch.

NAME	Church Hill Farm
CATEGORY	Farm
LOCATION	127 Left Hand Branch Rd
RPD	2RP36829
LISTING BOUNDARY	House site
OTHER LISTINGS	-
SIGNIFICANCE LEVEL	Local

History:**Description:**

- Interwar house
- triple gable roof
- jettied rafters
- bargeboard extended to a point
- Entry vestibule with porthole window
- Front verandah enclosed
- Sleepout on right hand side
- Row of very large Moreton Bay figs to left of entry drive and at top of drive.

Significance:

The house is significant as a good example of the use of materials, form and detailing typical of the interwar period.

The house, with its surrounding fig trees and garden, makes an aesthetic contribution to the rural landscape.

Associated places:

Church adjacent

References:**Comments:.**

NOTE: This report has been prepared on the basis of evidence examined by the study team and seeks to identify the most important heritage values of the item. The purpose of this report is to provide an initial evaluation. If any action is planned which might affect the cultural heritage significance of this place, advice should be sought through the Gatton Shire Council Planning Branch.

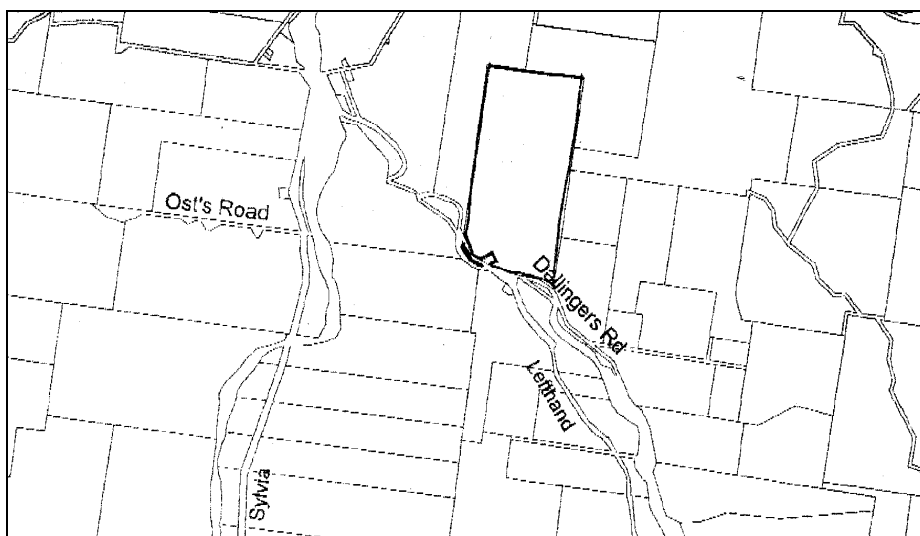

NOTE: This report has been prepared on the basis of evidence examined by the study team and seeks to identify the most important heritage values of the item. The purpose of this report is to provide an initial evaluation. If any action is planned which might affect the cultural heritage significance of this place, advice should be sought through the Gatton Shire Council Planning Branch.

NAME	Mt Sylvia State School
CATEGORY	School
LOCATION	Cnr Mt Sylvia Rd and Lefthand Branch Rd (a T-junction)
RPD	1CC1373
LISTING BOUNDARY	Whole of site
OTHER LISTINGS	-
SIGNIFICANCE LEVEL	Local

History:

Established as a provisional school in 1885. A new school building was completed in April 1894. As population grew, an additional building was constructed in 1913 – this building still remains at the school.

An new school building was constructed in 1971 and the first Early Education centre outside the Brisbane metropolitan area opened at Mt Sylvia in 1976, using the 1913 building.

Another school building was moved onto the site from an unknown location in 1983.

Description:

Modern wings

Boundary lined with large trees including jacaranda, figs and bottle trees

Significance:

Significant as an example of an early country school. It is important for its demonstration of traditional forms and materials and, with its landscaping, it makes an aesthetic contribution to the rural landscape.

Important for its association with the educational and social life of the local community over a long period.

Associated Items:

Post Office diagonally opposite

Old Shed opposite

References: Helen Bennett *Gatton Shire Thematic Historical Overview* Cultural Heritage Branch EPA 1999

Comments:

NOTE: This report has been prepared on the basis of evidence examined by the study team and seeks to identify the most important heritage values of the item. The purpose of this report is to provide an initial evaluation. If any action is planned which might affect the cultural heritage significance of this place, advice should be sought through the Gatton Shire Council Planning Branch.

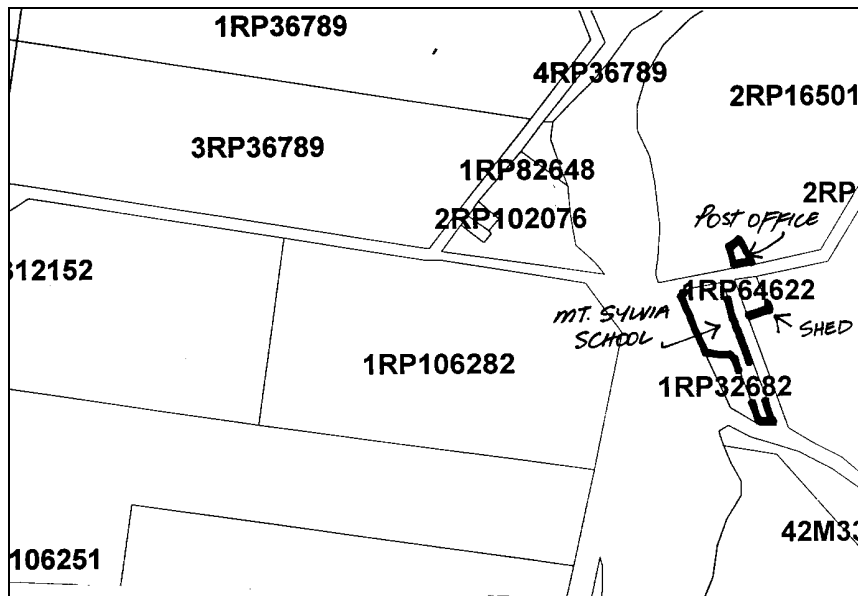
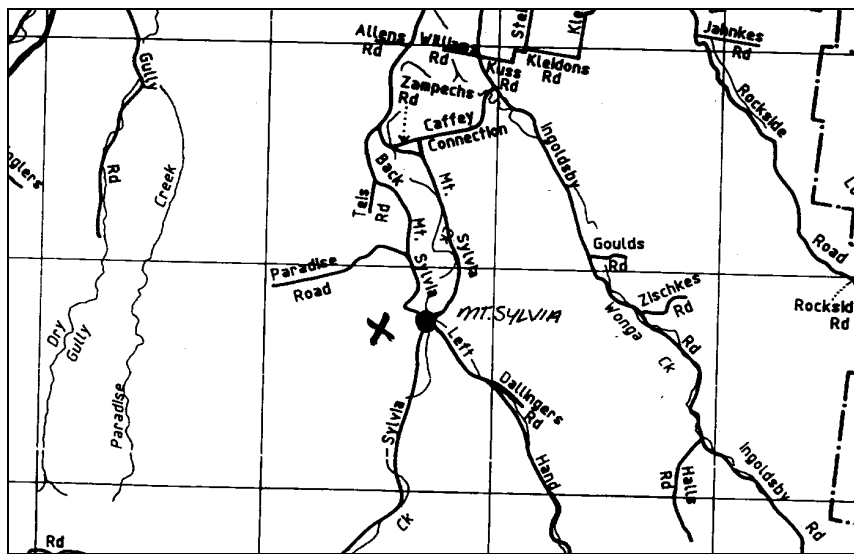

NOTE: This report has been prepared on the basis of evidence examined by the study team and seeks to identify the most important heritage values of the item. The purpose of this report is to provide an initial evaluation. If any action is planned which might affect the cultural heritage significance of this place, advice should be sought through the Gatton Shire Council Planning Branch.

NAME	Former Mt Sylvia Post Office and residence
CATEGORY	Post Office
LOCATION	1304 Mt Sylvia Rd
RPD	1RP165014
LISTING BOUNDARY	House site
OTHER LISTINGS	-
SIGNIFICANCE LEVEL	Local

History:**Description:**Residence

Typical interwar post office residence

Post Office

Small weatherboard building with timber door and one large window
 skillion street awning supported by log posts
 attached at side is a corrugated galvanised iron store with a loading dock and large doors

A large poinciana tree is at the right of the store, mango trees and a palm tree at the left of the residence

Significance:

The residence is significant as a typical example of a post office residence in a small community.
 The post office is significant as a modest building performing an important community function.

Associated Items:

School

Shed

References:**Comments:**

This is an attractive small precinct

There is a view from this precinct across to the Mt Sylvia Uniting Church

NOTE: This report has been prepared on the basis of evidence examined by the study team and seeks to identify the most important heritage values of the item. The purpose of this report is to provide an initial evaluation. If any action is planned which might affect the cultural heritage significance of this place, advice should be sought through the Gatton Shire Council Planning Branch.

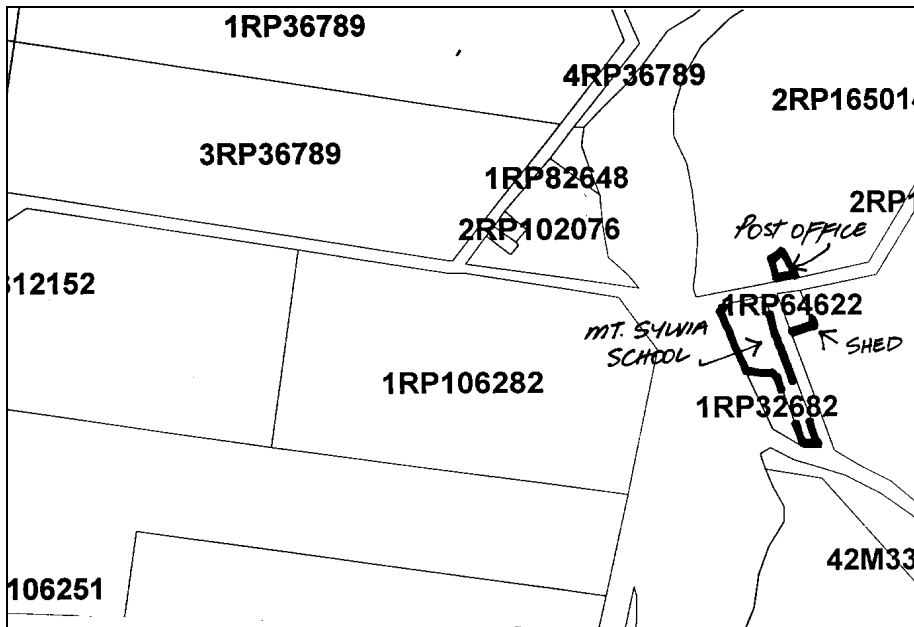

NOTE: This report has been prepared on the basis of evidence examined by the study team and seeks to identify the most important heritage values of the item. The purpose of this report is to provide an initial evaluation. If any action is planned which might affect the cultural heritage significance of this place, advice should be sought through the Gatton Shire Council Planning Branch.

NAME	
CATEGORY	shed
LOCATION	Cnr Left Hand Branch Rd and Mt Sylvia Rd
RPD	1RP64622
LISTING BOUNDARY	House site
OTHER LISTINGS	-
SIGNIFICANCE LEVEL	Recorded

History:**Description:**

- Large corrugated galvanised iron shed
- Left hand side has large doors
- The rear of the building has colonial sash windows
- There is a skillion-roofed rear extension with colonial sash windows

Significance:**Associated Items:**

School
Former Post Office complex

References:**Comments:**

Although an unremarkable building, it contributes to this small precinct

NOTE: This report has been prepared on the basis of evidence examined by the study team and seeks to identify the most important heritage values of the item. The purpose of this report is to provide an initial evaluation. If any action is planned which might affect the cultural heritage significance of this place, advice should be sought through the Gatton Shire Council Planning Branch.

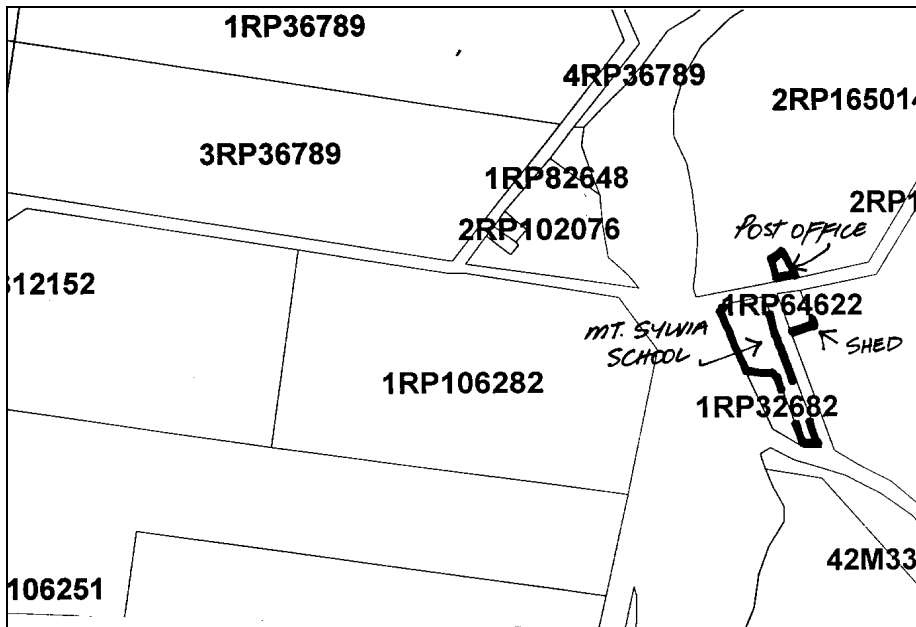

NOTE: This report has been prepared on the basis of evidence examined by the study team and seeks to identify the most important heritage values of the item. The purpose of this report is to provide an initial evaluation. If any action is planned which might affect the cultural heritage significance of this place, advice should be sought through the Gatton Shire Council Planning Branch.

NAME	St Patrick's Catholic Church, Mt Sylvia
CATEGORY	Church
LOCATION	Mt Sylvia Rd
RPD	
LISTING BOUNDARY	Whole of site
OTHER LISTINGS	-
SIGNIFICANCE LEVEL	Local

History:

Land for the church was donated by James McKeen. Tenders were called in 1896 and the church was built by James Madden, a builder well-known for church construction in this region. Timber is said to have come from trees cut in James McKeen's paddock with the help of local parishioners.

The interior was ceiled and lined by Eddie Goltz in 1975. A fire in 1992 damaged the altar rails, altar and pews but the damage has since been repaired.

Description:

Lowset weatherboard church
 small front porch surmounted by a timber cross
 pivoting obscure glass sash windows
 tank on low timber stand at side
 skillion-roof extension at rear

Significance:

Significant as a good example of a simple country church.

It is important in exhibiting a range of aesthetic characteristics valued by the local community, in particular the building's traditional form, scale and materials.

It is important for its aesthetic contribution to the rural landscape.

It has a strong association with the spiritual and social life of the surrounding community.

Associated Items:**References:**

Faith in the Valley – 100 years of the Catholic Church at Mt Sylvia 1896-1996

Comments:

NOTE: This report has been prepared on the basis of evidence examined by the study team and seeks to identify the most important heritage values of the item. The purpose of this report is to provide an initial evaluation. If any action is planned which might affect the cultural heritage significance of this place, advice should be sought through the Gatton Shire Council Planning Branch.

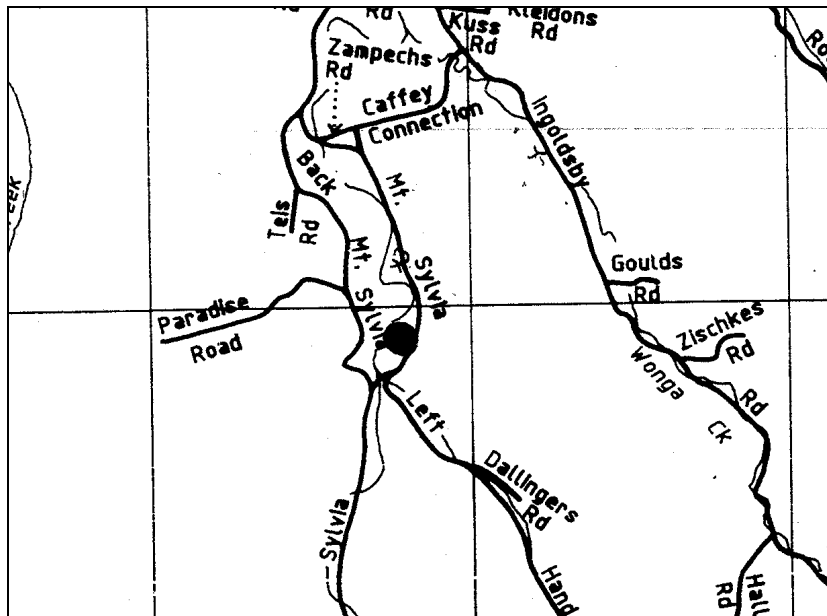

NOTE: This report has been prepared on the basis of evidence examined by the study team and seeks to identify the most important heritage values of the item. The purpose of this report is to provide an initial evaluation. If any action is planned which might affect the cultural heritage significance of this place, advice should be sought through the Gatton Shire Council Planning Branch.

NAME	
CATEGORY	Farm house
LOCATION	1458 Mt Sylvia Rd (near Hahn's Crossing)
RPD	56CC1409
LISTING BOUNDARY	House site
OTHER LISTINGS	-
SIGNIFICANCE LEVEL	Local

History:**Description:**

Interwar Californian bungalow
 Steps at front
 Timber window hoods

Significance:

The house is significant as a good example of the use of materials, form and detailing typical of the interwar period.

The house, with its surrounding garden, makes an aesthetic contribution to the rural landscape.

Associated Items:**References:****Comments:**

Opposite, there is a strip of cultivation and beyond it, a low ridge dotted with houses, most interwar

NOTE: This report has been prepared on the basis of evidence examined by the study team and seeks to identify the most important heritage values of the item. The purpose of this report is to provide an initial evaluation. If any action is planned which might affect the cultural heritage significance of this place, advice should be sought through the Gatton Shire Council Planning Branch.

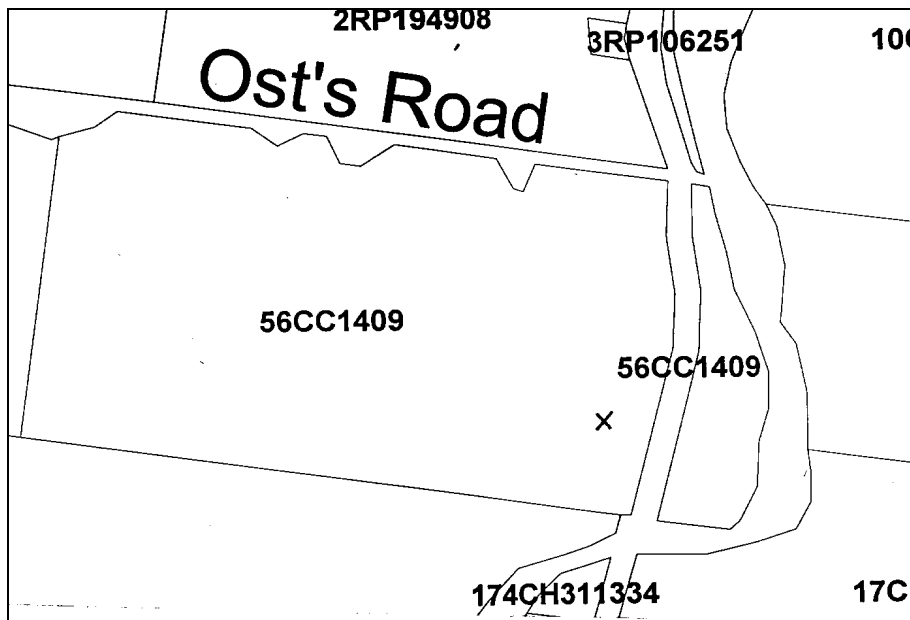

NOTE: This report has been prepared on the basis of evidence examined by the study team and seeks to identify the most important heritage values of the item. The purpose of this report is to provide an initial evaluation. If any action is planned which might affect the cultural heritage significance of this place, advice should be sought through the Gatton Shire Council Planning Branch.

NAME	Junction View Public Hall
CATEGORY	hall
LOCATION	Mt Sylvia Rd (between West Haldon Rd and Lunds Rd)1km from school
RPD	
LISTING BOUNDARY	Whole of site
OTHER LISTINGS	-
SIGNIFICANCE LEVEL	Local

History:**Description:**

Large lowset weatherboard hall on timber stumps
 Jettied gabled porch
 Later weatherboard extension on both sides
 Corrugated galvanised iron roof
 Casement windows

Large fig tree at rear

Significance:

Significant as a good example of a simple community hall.

It has a strong association with the social life of the surrounding community.

Associated Items:**References:****Comments:.**

NOTE: This report has been prepared on the basis of evidence examined by the study team and seeks to identify the most important heritage values of the item. The purpose of this report is to provide an initial evaluation. If any action is planned which might affect the cultural heritage significance of this place, advice should be sought through the Gatton Shire Council Planning Branch.

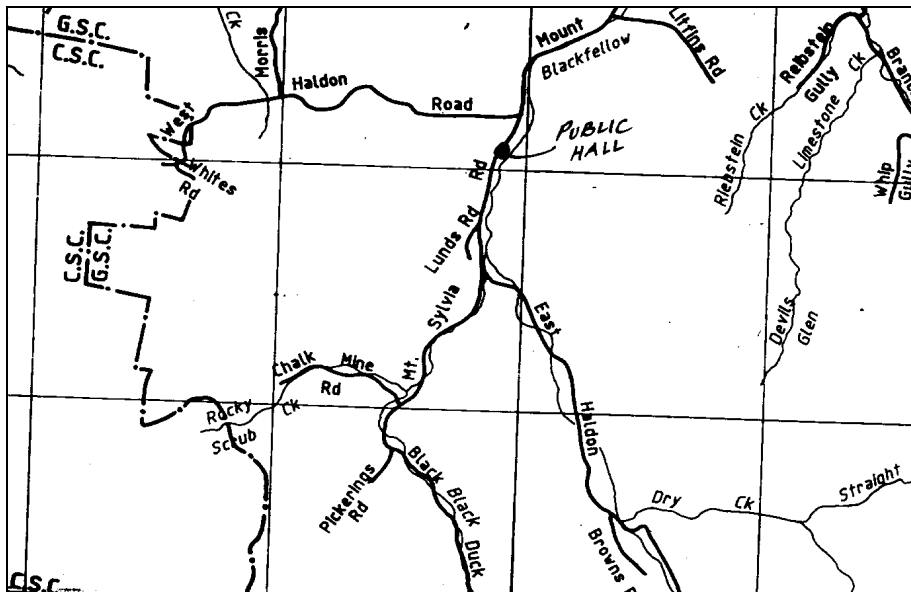

NOTE: This report has been prepared on the basis of evidence examined by the study team and seeks to identify the most important heritage values of the item. The purpose of this report is to provide an initial evaluation. If any action is planned which might affect the cultural heritage significance of this place, advice should be sought through the Gatton Shire Council Planning Branch.

NAME	Junction View State School and residence
CATEGORY	School
LOCATION	Mt Sylvia Rd
RPD	107CC2843
LISTING BOUNDARY	Whole of site
OTHER LISTINGS	-
SIGNIFICANCE LEVEL	Local

History:

The school opened in 1922 to replace Black Duck Ck, Viewland and Woodbine schools.

Description:School

Highset chamferboard and weatherboard school with corrugated galvanised iron roof

In two connected sections

Concrete stumps

Tennis court

Open sided playshed

Residence

Interwar

Significance:

Significant as a good and intact example of an early country school, demonstrating many of the typical features including classrooms, residence, playshed, tennis court and tree plantings.

It is important for its demonstration of traditional forms and materials and, with its landscaping, it makes an aesthetic contribution to the rural landscape.

Important for its association with the educational and social life of the local community over a long period.

Associated Items:**References:**

Comments: An attractive site

NOTE: This report has been prepared on the basis of evidence examined by the study team and seeks to identify the most important heritage values of the item. The purpose of this report is to provide an initial evaluation. If any action is planned which might affect the cultural heritage significance of this place, advice should be sought through the Gatton Shire Council Planning Branch.

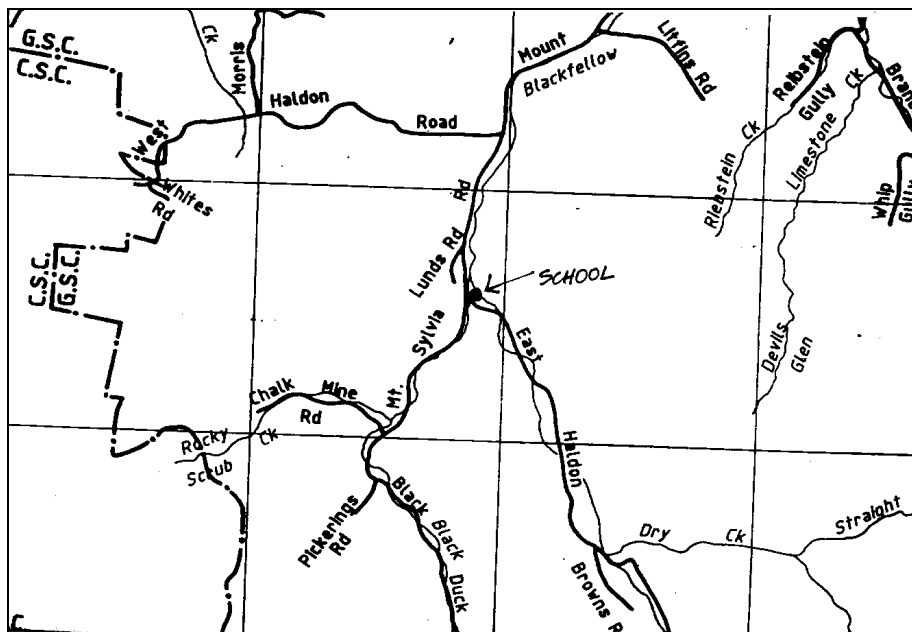

NOTE: This report has been prepared on the basis of evidence examined by the study team and seeks to identify the most important heritage values of the item. The purpose of this report is to provide an initial evaluation. If any action is planned which might affect the cultural heritage significance of this place, advice should be sought through the Gatton Shire Council Planning Branch.

NAME	Glenrock
CATEGORY	Farm/regional park
LOCATION	East Haldon Rd (at end)
RPD	84 on CC935 105 on CH312522 97 on CC836182 10 on CH312292 23 on CH311139 123 on CC390 (see D/G 97873) 96 on CH312503 30 on CH 311898 149 on CC496 9 on CC2304
LISTING BOUNDARY	Whole property
OTHER LISTINGS	-
SIGNIFICANCE LEVEL	recorded

History:

Glenrock is 6300 hectare regional park owned by DNR and administered by Brisbane Forest Park. Daytripper and camping facilities were officially opened on June 4 2000. It is still also run as a cattle property.

The property was originally a grazing property

The house on the site appears to have been built in the 1880s or 1890s. A slab hut nearby is said to have been damaged in a storm in the 1970s. One wall has been repaired with slabs. Another hut dating from c1936 is on the property; this is accessed from Black Duck Creek and was not inspected.

Description:House

Original windows and most of the original doors replaced

Slab building

Battens inside the roof space indicate it originally had a shingle roof

Interior mixture of surfaces ranging from hardboard to slabs.

Timber floor

Crown wood stove in recess

Significance:

Recorded for its historical interest. The older buildings on the property demonstrate the principal characteristics of several different types of rural residence.

Associated Items:**References:****Comments:**

NOTE: This report has been prepared on the basis of evidence examined by the study team and seeks to identify the most important heritage values of the item. The purpose of this report is to provide an initial evaluation. If any action is planned which might affect the cultural heritage significance of this place, advice should be sought through the Gatton Shire Council Planning Branch.



NOTE: This report has been prepared on the basis of evidence examined by the study team and seeks to identify the most important heritage values of the item. The purpose of this report is to provide an initial evaluation. If any action is planned which might affect the cultural heritage significance of this place, advice should be sought through the Gatton Shire Council Planning Branch.

NAME	Graves of William and Sarah Philp
CATEGORY	Cemetery
LOCATION	396 East Haldon Road
RPD	The graves are on a 10-acre block RP 58209
LISTING BOUNDARY	Area defined by pipe fence
OTHER LISTINGS	-
SIGNIFICANCE LEVEL	local

History:

The property was originally owned by the Philps whose farmhouse was on the flat land below.

William Haig Philp apparently expressed a wish to be buried on the hill above the house. His wife Sarah is also buried here.

The graves were originally defined by a timber fence but this deteriorated. The current pipe fence was erected as a Bicentenary community project and the current land owner brought a sandstone boulder from the creek as a grave marker. The boulder bears a metal cross and a plaque recording the family details.

Description:

Simple pipe fence set in concrete pads defining a grave site which is on a hillside well above, and set well back from, the road.

The grave is marked by a large sandstone boulder bearing a metal cross and a plaque.

Significance:**Associated Items:**

References: Information from owner of the land

Comments:

NOTE: This report has been prepared on the basis of evidence examined by the study team and seeks to identify the most important heritage values of the item. The purpose of this report is to provide an initial evaluation. If any action is planned which might affect the cultural heritage significance of this place, advice should be sought through the Gatton Shire Council Planning Branch.



NOTE: This report has been prepared on the basis of evidence examined by the study team and seeks to identify the most important heritage values of the item. The purpose of this report is to provide an initial evaluation. If any action is planned which might affect the cultural heritage significance of this place, advice should be sought through the Gatton Shire Council Planning Branch.

NAME	Uniting Church, Lockyer Parish, Mt Sylvia
CATEGORY	church
LOCATION	Back Mt Sylvia Rd
RPD	1RP36790
LISTING BOUNDARY	Whole of site
OTHER LISTINGS	-
SIGNIFICANCE LEVEL	Local

History:**Description:**

Small weatherboard church, steeply pitched corrugated galvanised iron roof, small front porch

Picnic shelter shed, log supports, corrugated galvanised iron roof and corrugated galvanised iron infill in gable

Significance:

Significant as an example of a simple country church, including a shelter shed now relatively uncommon.

It is important in exhibiting a range of aesthetic characteristics valued by the local community, in particular the building's traditional form, scale and materials.

Important for its contribution to the rural landscape.

It has a strong association with the spiritual and social life of the surrounding community.

Associated Items:**References:****Comments:.**

Next to an intrusive Energex substation

NOTE: This report has been prepared on the basis of evidence examined by the study team and seeks to identify the most important heritage values of the item. The purpose of this report is to provide an initial evaluation. If any action is planned which might affect the cultural heritage significance of this place, advice should be sought through the Gatton Shire Council Planning Branch.

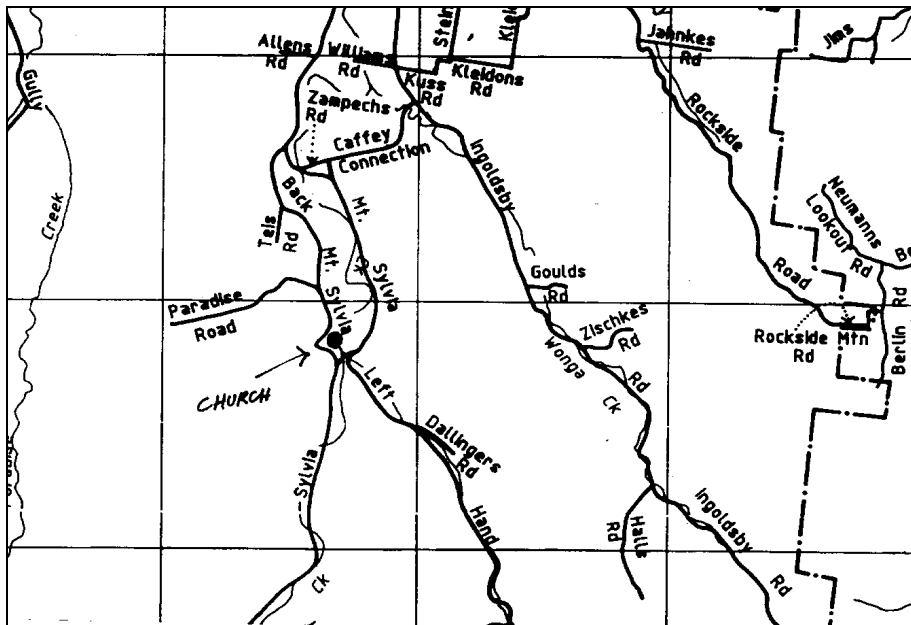

NOTE: This report has been prepared on the basis of evidence examined by the study team and seeks to identify the most important heritage values of the item. The purpose of this report is to provide an initial evaluation. If any action is planned which might affect the cultural heritage significance of this place, advice should be sought through the Gatton Shire Council Planning Branch.

NAME	Tent Hill Cricket Club Pavilion
CATEGORY	
LOCATION	Ropehill Rd, beside Bert and Lil Peach Memorial Oval No 2
RPD	On 3RP119038
LISTING BOUNDARY	House site
OTHER LISTINGS	
SIGNIFICANCE LEVEL	Local

History:

Appears to be a former school

Description:

Lowset timber building

Rear wall has casement windows with window hood

Front verandah with batted balustrade, side verandah now enclosed to form a bar with roller shutters

Internally one room, TGVJ lined

Tank at side

Significance:

It is important in exhibiting a range of aesthetic characteristics valued by the local community, in particular the building's traditional form, scale and materials.

Although relocated to this site, it fits well into the setting and makes a contribution to the rural landscape.

It has a strong association with the sporting and social life of the surrounding community.

Associated Items:

Timber sight screen

References:**Comments:.**

NOTE: This report has been prepared on the basis of evidence examined by the study team and seeks to identify the most important heritage values of the item. The purpose of this report is to provide an initial evaluation. If any action is planned which might affect the cultural heritage significance of this place, advice should be sought through the Gatton Shire Council Planning Branch.

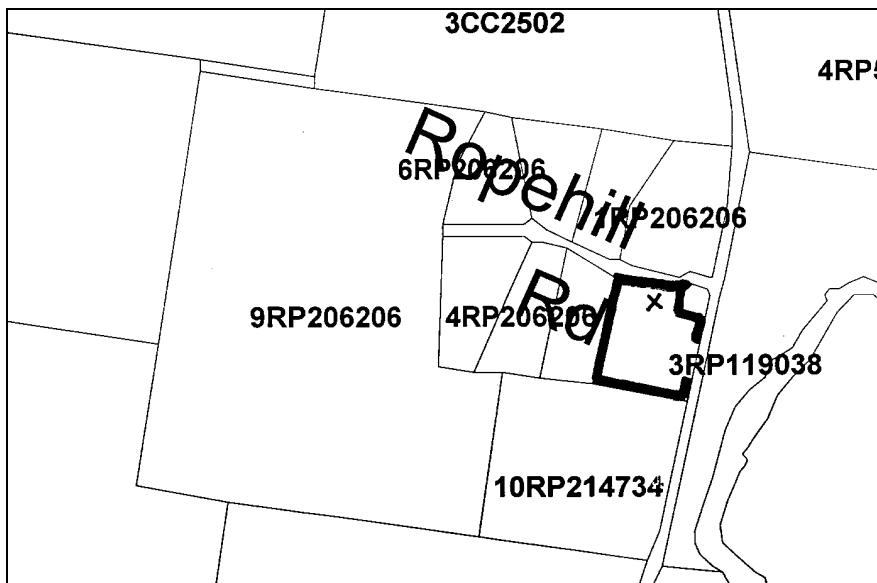

NOTE: This report has been prepared on the basis of evidence examined by the study team and seeks to identify the most important heritage values of the item. The purpose of this report is to provide an initial evaluation. If any action is planned which might affect the cultural heritage significance of this place, advice should be sought through the Gatton Shire Council Planning Branch.

NAME	Upper Tent Hill School and residence
CATEGORY	School
LOCATION	Upper Tent Hill School Lane
RPD	285CC3073
LISTING BOUNDARY	Whole of site
OTHER LISTINGS	-
SIGNIFICANCE LEVEL	Local

History:

A school opened here in 1877.

Description:School

Highset weatherboard school, corrugated galvanised iron roof, gable end has a window hood

Side verandah

concrete stumps

Original wing has a lowset rear extension

Original open sided play shed

There are various other modern extensions and covered ways

Modern steel storage shed

Playground has large fig trees

Residence

Typical interwar

Significance:

Significant as a good and intact example of an early country school, demonstrating many of the typical features including classrooms, residence, playshed and tree plantings.

It is important for its demonstration of traditional forms and materials and, with its landscaping including large fig trees, it makes an aesthetic contribution to the rural landscape.

Important for its association with the educational and social life of the local community over a long period.

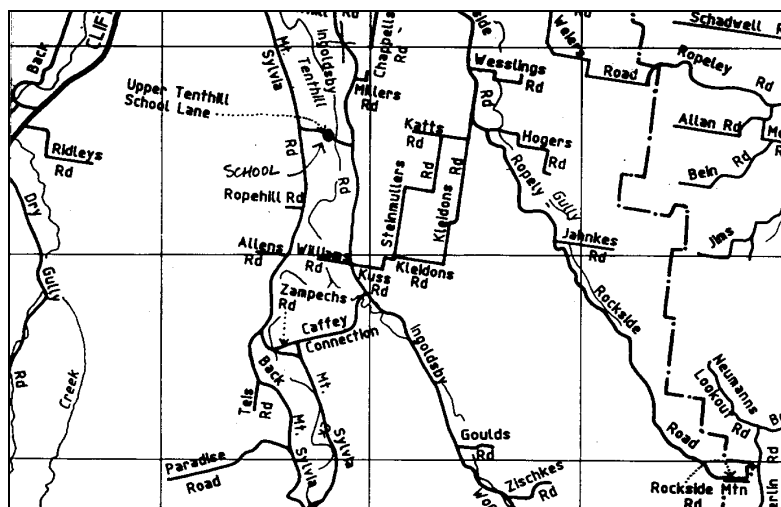
Associated Items:**References:****Comments:**

NOTE: This report has been prepared on the basis of evidence examined by the study team and seeks to identify the most important heritage values of the item. The purpose of this report is to provide an initial evaluation. If any action is planned which might affect the cultural heritage significance of this place, advice should be sought through the Gatton Shire Council Planning Branch.

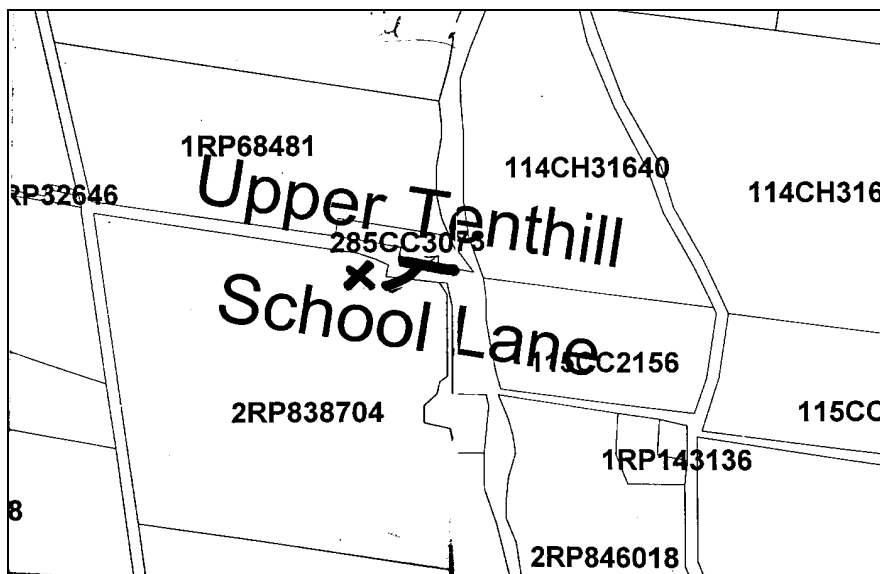

NOTE: This report has been prepared on the basis of evidence examined by the study team and seeks to identify the most important heritage values of the item. The purpose of this report is to provide an initial evaluation. If any action is planned which might affect the cultural heritage significance of this place, advice should be sought through the Gatton Shire Council Planning Branch.

NAME	Lower Tenthill State School
CATEGORY	School
LOCATION	Lower Tent Hill Rd
RPD	2RP101233
LISTING BOUNDARY	Whole of site
OTHER LISTINGS	-
SIGNIFICANCE LEVEL	Local

History:

The school opened in 1873.

A playshed was erected in 1911 and a new school building was officially opened in January 1920. A World War I honour board was unveiled at the school at the same time.

A new school building was erected in 1971, at which time the 1920 building became the library. The Honour Board remains in this building.

The teacher's residence (erected 1872 with early 1900 extensions) was sold in 1994-5 and moved to Vege-Fresh Tent Hill where it was renovated as an office.

Description:

Highset weatherboard timber school
 Gable ended, casement windows, window hoods, concrete stumps
 Front verandah enclosed, hopper windows
 Symmetrically-placed timber stairs

Original opens-sided playshed plus a new colorbond one
 New covered way linking to newer classroom wing at side
 Colorbond shed
 Two elevated rainwater tanks

Very large bottle trees in grounds

Significance:

Significant as a good and intact example of an early country school, demonstrating many of the typical features including classrooms, playshed and tree plantings.

It is important for its demonstration of traditional forms and materials and, with its landscaping including extremely large bottle trees, it makes an aesthetic contribution to the rural landscape.

Important for its association with the educational and social life of the local community over a long period.

The Honour board (not inspected) is significant as evidence of the impact of World War I on local communities.

Associated Items:**References:****Comments:**

NOTE: This report has been prepared on the basis of evidence examined by the study team and seeks to identify the most important heritage values of the item. The purpose of this report is to provide an initial evaluation. If any action is planned which might affect the cultural heritage significance of this place, advice should be sought through the Gatton Shire Council Planning Branch.

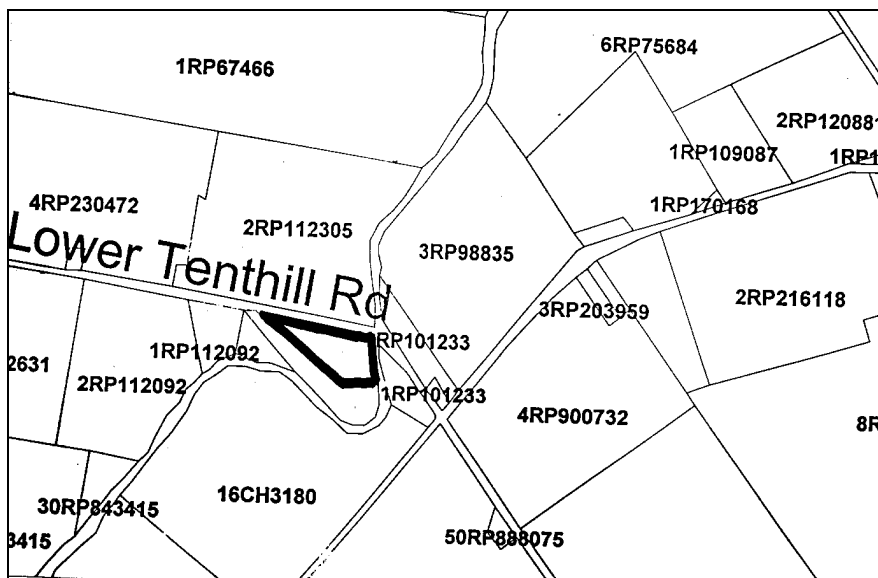

NOTE: This report has been prepared on the basis of evidence examined by the study team and seeks to identify the most important heritage values of the item. The purpose of this report is to provide an initial evaluation. If any action is planned which might affect the cultural heritage significance of this place, advice should be sought through the Gatton Shire Council Planning Branch.

NAME	
CATEGORY	house
LOCATION	Mt Sylvia Rd (near Tenthill Ck Rd)
RPD	1RP132497
LISTING BOUNDARY	House site
OTHER LISTINGS	-
SIGNIFICANCE LEVEL	local

History:

Probably c1915

Description:

Highset weatherboard cottage , hip roof
 Open front verandah, left hand verandah enclosed
 Broomstick balustrade, decorative brackets
 Window hoods
 Colonial sash windows
 Separate gabled timber garage

Significance:

Important for its demonstration of aesthetic characteristics and building techniques typical of the late 19th/early 20th century, now becoming rare.

The house, with its surrounding trees, is in a prominent position and contributes aesthetically to the rural landscape.

Associated Items:**References:****Comments:.**

NOTE: This report has been prepared on the basis of evidence examined by the study team and seeks to identify the most important heritage values of the item. The purpose of this report is to provide an initial evaluation. If any action is planned which might affect the cultural heritage significance of this place, advice should be sought through the Gatton Shire Council Planning Branch.

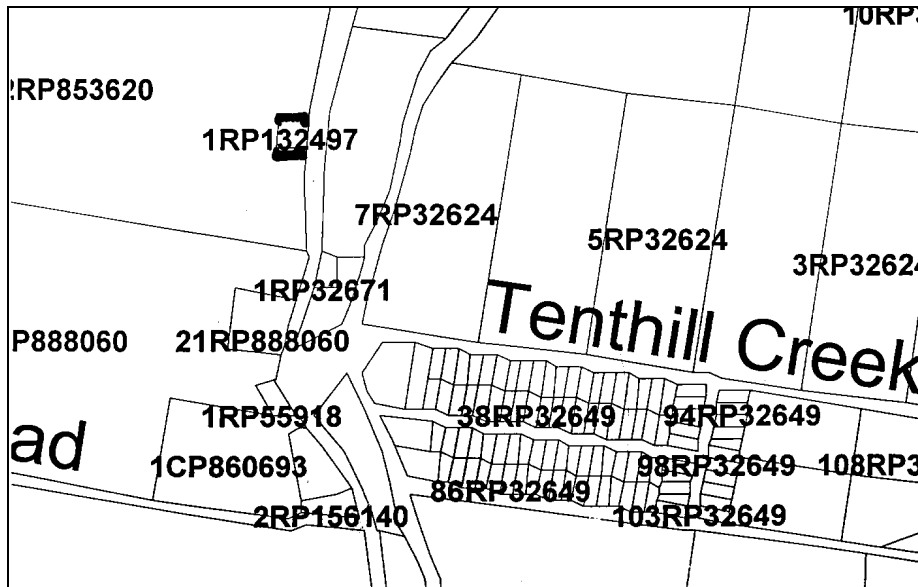

NOTE: This report has been prepared on the basis of evidence examined by the study team and seeks to identify the most important heritage values of the item. The purpose of this report is to provide an initial evaluation. If any action is planned which might affect the cultural heritage significance of this place, advice should be sought through the Gatton Shire Council Planning Branch.

NAME	Tenthill Hotel
CATEGORY	Hotel
LOCATION	Mt Sylvia Rd, Tent Hill
RPD	1CP860693
LISTING BOUNDARY	Whole site
OTHER LISTINGS	-
SIGNIFICANCE LEVEL	Recorded

History:

A hotel known as the Hessendorf Hotel opened at Tent Hill in 1884, with Ludwig Berghofer as its first licensee. The name was changed to Tent Hill Hotel in 1896.

Description:**Significance:**

Recorded for its historical significance

Associated Items:**References:**

Norris, Merle 1996 *Queensland Hotels and Publicans Index 1843-1900* Qld Family History Society

Comments:

NOTE: This report has been prepared on the basis of evidence examined by the study team and seeks to identify the most important heritage values of the item. The purpose of this report is to provide an initial evaluation. If any action is planned which might affect the cultural heritage significance of this place, advice should be sought through the Gatton Shire Council Planning Branch.

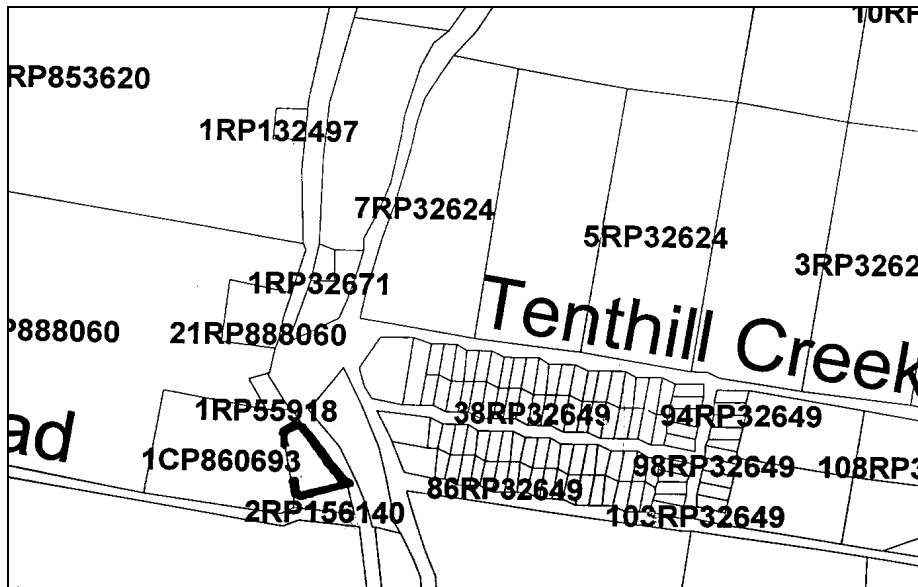

NOTE: This report has been prepared on the basis of evidence examined by the study team and seeks to identify the most important heritage values of the item. The purpose of this report is to provide an initial evaluation. If any action is planned which might affect the cultural heritage significance of this place, advice should be sought through the Gatton Shire Council Planning Branch.

NAME	
CATEGORY	house
LOCATION	400 Mt Sylvia Rd between Tenthill Ck Rd and Upper Tenthill School Lane
RPD	1RP32647
LISTING BOUNDARY	House site
OTHER LISTINGS	-
SIGNIFICANCE LEVEL	local

History:

Probably 19th century

Description:

Detached kitchen

Verandah balustrade now horizontal boards.

Setting of large trees beside cultivation, well back from road

Significance:

Important for its demonstration of aesthetic characteristics and building techniques typical of the late 19th/early 20th century, now becoming rare.

The house, with its surrounding trees/garden/farm buildings, contributes aesthetically to the streetscape/rural landscape.

Associated Items:

House of similar age on next property

References:**Comments:.**

NOTE: This report has been prepared on the basis of evidence examined by the study team and seeks to identify the most important heritage values of the item. The purpose of this report is to provide an initial evaluation. If any action is planned which might affect the cultural heritage significance of this place, advice should be sought through the Gatton Shire Council Planning Branch.

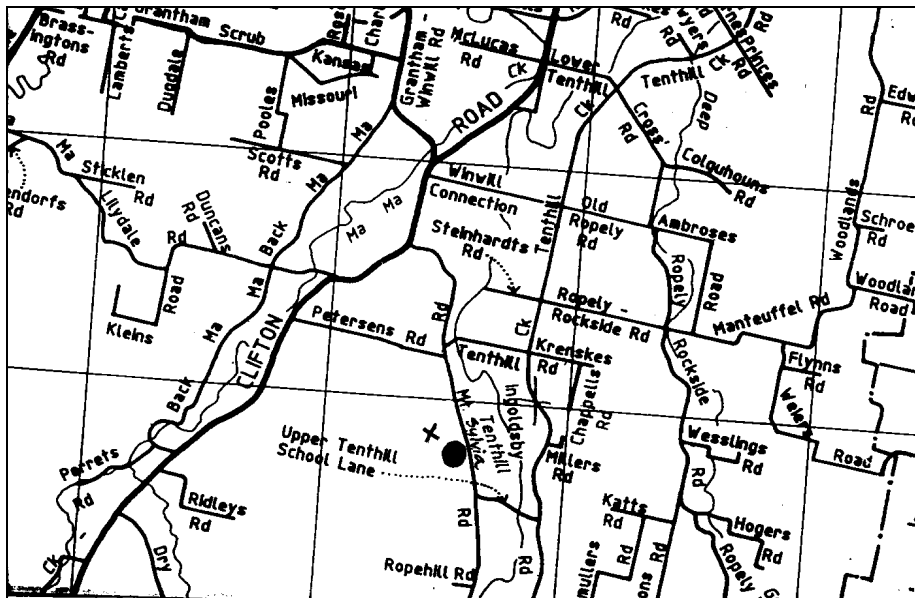

NOTE: This report has been prepared on the basis of evidence examined by the study team and seeks to identify the most important heritage values of the item. The purpose of this report is to provide an initial evaluation. If any action is planned which might affect the cultural heritage significance of this place, advice should be sought through the Gatton Shire Council Planning Branch.

NAME	
CATEGORY	Farmhouse
LOCATION	348 Mt Sylvia Rd between Tenthill Ck Rd and Upper Tenthill School Lane
RPD	3RP156653
LISTING BOUNDARY	House site
OTHER LISTINGS	-
SIGNIFICANCE LEVEL	Local

History:

Probably 19th century

Description:

Detached kitchen has steep gabled roof, possibly the original house
 Corrugated galvanised iron roof
 Fibro-clad enclosed verandah
 Corrugated galvanised iron outbuildings

Setting of mature trees, next to cultivation

Significance:

The house with its detached rear wing is important for its demonstration of aesthetic characteristics and building techniques typical of the late 19th/early 20th century, now becoming rare.

The house, with its surrounding trees/garden/farm buildings, contributes aesthetically to the rural landscape.

Associated Items:

House of similar age on next property

References:**Comments:.**

NOTE: This report has been prepared on the basis of evidence examined by the study team and seeks to identify the most important heritage values of the item. The purpose of this report is to provide an initial evaluation. If any action is planned which might affect the cultural heritage significance of this place, advice should be sought through the Gatton Shire Council Planning Branch.



NOTE: This report has been prepared on the basis of evidence examined by the study team and seeks to identify the most important heritage values of the item. The purpose of this report is to provide an initial evaluation. If any action is planned which might affect the cultural heritage significance of this place, advice should be sought through the Gatton Shire Council Planning Branch.

NAME	Pepperina Place
CATEGORY	House
LOCATION	Mt Sylvia
RPD	132CH312362
LISTING BOUNDARY	House environs
OTHER LISTINGS	-
SIGNIFICANCE LEVEL	local

History: Built in 1894 by the Murrhly family on a block of 80 acres. Now restored and furnished as a tourist site.

Description:

- **Lowset weatherboard cottage**
- **Front verandah with skillion roof and broomstick balustrade**
- **Simple front steps leading up to verandah**
- **Four-paned colonial sash windows**
- **Exposed stud exterior walls**
- **Timber stumps**

Significance:

Important for its demonstration of aesthetic characteristics and building techniques typical of the late 19th/early 20th century.

Associated Items:

References: Information from current owners

Comments:

NOTE: This report has been prepared on the basis of evidence examined by the study team and seeks to identify the most important heritage values of the item. The purpose of this report is to provide an initial evaluation. If any action is planned which might affect the cultural heritage significance of this place, advice should be sought through the Gatton Shire Council Planning Branch.



NOTE: This report has been prepared on the basis of evidence examined by the study team and seeks to identify the most important heritage values of the item. The purpose of this report is to provide an initial evaluation. If any action is planned which might affect the cultural heritage significance of this place, advice should be sought through the Gatton Shire Council Planning Branch.

SPECIAL SITES

University of Queensland Gatton Campus, Lawes	872
J.H. Wagner & Sons Helidon Quarry, 447 Seventeen Mile Rd Helidon	880
Comerford Sandstone, Airforce Road, Helidon	884
Australian Sandstone Industries	888

NOTE: This report has been prepared on the basis of evidence examined by the study team and seeks to identify the most important heritage values of the item. The purpose of this report is to provide an initial evaluation. If any action is planned which might affect the cultural heritage significance of this place, advice should be sought through the Gatton Shire Council Planning Branch.

NAME	Gatton College (University of Queensland Gatton Campus)
CATEGORY	Educational
LOCATION	Lawes
RPD	Heritage boundary to be determined
LISTING BOUNDARY	Whole of site at present – heritage boundary to be determined
OTHER LISTINGS	Currently nominated to Register of National Estate as an Indicative Place - Database Number: 101924 File Number: 4/01/085/0010
SIGNIFICANCE LEVEL	Precinct of State Significance Possibly of National Significance (subject to further evaluation)

History:

The Queensland Department of Agriculture was formed in 1887. In September 1889, Edward Shelton, formerly professor of agriculture at Kansas State Agricultural College, USA, was appointed as agricultural instructor and took up his position six months later. Also in 1889, two dairy demonstration units were set up by the Department, travelling through Queensland by railway in charge of John Mahon, the chief instructor in dairying.

The idea of founding an agricultural school had first been raised in parliament in 1874 and again in 1886. Southern colonies had already established such colleges and demonstrated their value. After Shelton's appointment, the subject was raised again and Shelton visited agricultural colleges in Victoria. It was considered that the proposed college should be set up in southern Queensland where the concentration of farmers was greatest. Although the project received general support in parliament, the financial depression of the early 1890s delayed its implementation for some time.

A portion of the old "Rosewood" property near Gatton was eventually selected as a possible site for an experimental and training farm and when Thynne was appointed Minister for Agriculture, he confirmed the purchase. It is worth noting that Thynne was already familiar with the concept of an agricultural college, having sent his own son to Hawkesbury Agricultural College in New South Wales.

Prof Shelton was appointed as the first principal. The college officially opened with 23 students on 9th July, 1897. The course included both theory and practical work, with students working alternately in field and classroom. Much of the early development of the college farm was done with student labour.

In 1923, a reorganisation brought Gatton College under the control of the Department of Education. It became an agricultural high school and college, still with a research element. In 1927, a Faculty of Agriculture was set up at the University of Queensland and a year at Gatton College became a compulsory part of the degree course.

The high school section closed in 1962 and a wide diversification of courses was initiated in 1966, eventually including rural-related subjects such as food technology, hospitality, tourism, valuation and wildlife services. In 1971, control passed to a College Council and in 1990, the college consolidated with the University of Queensland to become "The University of Queensland Gatton College". It is now referred to as the University of Queensland Gatton Campus.

The general community has usually referred to the institution as "Gatton College" in spite of its varying official names.

A feature of the College's history has been its responsiveness to the changing needs of the wider agricultural community. The first major activities at the College, even before it opened officially, was a demonstration of silage making for district farmers and a conference for farmers. Since then, it has provided short courses on specific topics such as cheese making, bee keeping and sugar

NOTE: This report has been prepared on the basis of evidence examined by the study team and seeks to identify the most important heritage values of the item. The purpose of this report is to provide an initial evaluation. If any action is planned which might affect the cultural heritage significance of this place, advice should be sought through the Gatton Shire Council Planning Branch.

farming. Training courses were provided for returned soldiers after World War I and World War II, while special courses were started during the 1930s depression for unemployed young people.

The College has maintained high quality herds and has kept pace with industry advances. It set up a brahmin stud in 1961, foreseeing the increasing importance of tropical breeds, and in 1984, it started a deer unit for research into this new Queensland industry.

Research has been carried out by College staff while College land or facilities have been made available for research to the Department of Agriculture and Stock (later the Primary Industries Department), the CSIR (later the CSIRO) and the University of Queensland.

During World War II, 85 acres of the College site and the majority of its buildings were transferred to the Army for a hospital. For much of this time, it was a United States Army Hospital and after September 1944, an Australian Army Reserve Hospital. Other wartime work included testing alternative fuels and growing crops of opium, urgently needed during the war for production of medical morphine.

Description:

A full assessment of all the significant buildings, structures and monuments of this large and important site is beyond the scope of this report. Some of the major buildings and structures identified include the following:

The Foundation Building was constructed in 1897 as the first college building.

"The Homestead" is adjacent and was constructed as a residence for College principals.

The Palm Avenue is an important landscape feature

"Farm Square" and the surrounding area contains some of the older farm buildings including a shearing shed (1941) and an early concrete silo.

Morrison Hall (formerly known as "Shelton Hall") was built in 1936 as a residential block for students.

Sir Leslie Wilson Hall (former gymnasium built 1899)

Grandstand on oval

Possible World War II buildings

Various monuments, memorials and a flagpole

Significance:

The precinct is significant:

For its association with the establishment of one of the earliest tertiary institutions in Queensland and for demonstrating the commitment of the government of Queensland to scientific agricultural training at that time.

For its continuing association with agricultural research including its links with the University of Queensland, CSIR (later CSIRO) and the Qld Dept of Agriculture.

For its association with Professor E.M. Shelton, founding Principal of Gatton College and with the many other notable principals, students and staff members who followed

For its association with the war time use of the college as a military hospital and for its role in training returned soldiers after both World War I and II.

NOTE: This report has been prepared on the basis of evidence examined by the study team and seeks to identify the most important heritage values of the item. The purpose of this report is to provide an initial evaluation. If any action is planned which might affect the cultural heritage significance of this place, advice should be sought through the Gatton Shire Council Planning Branch.

For the aesthetic significance of many of its buildings.

Associated Items: Former College View School on opposite side of highway

References: Annual reports, annual magazines and other reports held in the College Library.

Comments:

A full conservation plan should be carried out for this important site



Site Plan, University of Qld Gatton Campus

NOTE: This report has been prepared on the basis of evidence examined by the study team and seeks to identify the most important heritage values of the item. The purpose of this report is to provide an initial evaluation. If any action is planned which might affect the cultural heritage significance of this place, advice should be sought through the Gatton Shire Council Planning Branch.



The Foundation Building



Palm avenue near the Foundation Building



The Homestead (former residence for College Principals)

NOTE: This report has been prepared on the basis of evidence examined by the study team and seeks to identify the most important heritage values of the item. The purpose of this report is to provide an initial evaluation. If any action is planned which might affect the cultural heritage significance of this place, advice should be sought through the Gatton Shire Council Planning Branch.



Above and below - Morrison Hall (Old Shelton Hall)



Shearing Shed

NOTE: This report has been prepared on the basis of evidence examined by the study team and seeks to identify the most important heritage values of the item. The purpose of this report is to provide an initial evaluation. If any action is planned which might affect the cultural heritage significance of this place, advice should be sought through the Gatton Shire Council Planning Branch.



Farm Square



Farm Square



Building possibly dating from World War II

NOTE: This report has been prepared on the basis of evidence examined by the study team and seeks to identify the most important heritage values of the item. The purpose of this report is to provide an initial evaluation. If any action is planned which might affect the cultural heritage significance of this place, advice should be sought through the Gatton Shire Council Planning Branch.



Former Crowley Vale School building



NOTE: This report has been prepared on the basis of evidence examined by the study team and seeks to identify the most important heritage values of the item. The purpose of this report is to provide an initial evaluation. If any action is planned which might affect the cultural heritage significance of this place, advice should be sought through the Gatton Shire Council Planning Branch.

NOTE: This report has been prepared on the basis of evidence examined by the study team and seeks to identify the most important heritage values of the item. The purpose of this report is to provide an initial evaluation. If any action is planned which might affect the cultural heritage significance of this place, advice should be sought through the Gatton Shire Council Planning Branch.

NAME	J.H. Wagner & Sons Helidon Quarry
CATEGORY	quarry
LOCATION	447 Seventeen Mile Rd Helidon
RPD	Heritage boundary to be determined (Quarry is on 150CA311286 and 151 CA311336)
LISTING BOUNDARY	Heritage boundary to be determined <ul style="list-style-type: none"> • excluding current operational areas • including quarry activities and old steam cranes on adjacent forestry land State Forest 616.
OTHER LISTINGS	-
SIGNIFICANCE LEVEL	Local

History: Tom Wright began quarrying here c1889. The business was later continued by his son Perc. In 1965, the quarry was sold to J.H. Wagner and Sons who had been one of the major customers.

Wagners were established in 1896 in Toowoomba by John Henry Wagner; the company still has its head office in this city.

Stone from this quarry has been used in many major buildings including extensions to Old Government House; Executive Building; St John's Cathedral; Ipswich Post Office.

Stone for the Brisbane City Hall was obtained from a small quarrying area adjacent to this site, then owned by contractor D.D. Carrick.

Description:

- Large operational quarry site. A rockface near the office/shed shows signs of a succession of quarrying methods, from handwork to modern trenching machinery.
- Two steam cranes are still situated in the adjacent State Forest 616.
- The buildings on site include a large mainly open-sided timber shed, now in rather deteriorated condition, containing the remains of former cutting machinery.

Significance:

This is an important example of a freestone quarry.

The place demonstrates the progression of technology associated with stone quarrying over the past 110 years and still retains examples of early equipment including steam cranes on an adjacent forestry site formerly leased to the quarry. It has the potential to yield information that will contribute to an understanding of quarrying methods.

As one of a group of quarries in this area, it was important to the local economy and is associated with the growth and development of townships in Gatton Shire.

The place is associated with construction of many important Queensland buildings and hence with the development and aesthetics of Queensland cities.

Associated Items:

References:

K.W. Wolfe Queensland Building and Monumental Stones
Regional Forest Assessment Unit *Non-Indigenous Cultural Heritage Places in the Forests of South-East Qld: Database of sites* 1999

NOTE: This report has been prepared on the basis of evidence examined by the study team and seeks to identify the most important heritage values of the item. The purpose of this report is to provide an initial evaluation. If any action is planned which might affect the cultural heritage significance of this place, advice should be sought through the Gatton Shire Council Planning Branch.

Comments:

This is an operational industrial site. It is recommended that Gatton Shire Council hold discussions with this quarry and with other local quarries to see if they can mutually agree areas which can be conserved. A heritage boundary should be established within the overall site.



NOTE: This report has been prepared on the basis of evidence examined by the study team and seeks to identify the most important heritage values of the item. The purpose of this report is to provide an initial evaluation. If any action is planned which might affect the cultural heritage significance of this place, advice should be sought through the Gatton Shire Council Planning Branch.



Site which provided stone for Jupiter's Casino 2000



Same site 1985

NOTE: This report has been prepared on the basis of evidence examined by the study team and seeks to identify the most important heritage values of the item. The purpose of this report is to provide an initial evaluation. If any action is planned which might affect the cultural heritage significance of this place, advice should be sought through the Gatton Shire Council Planning Branch.

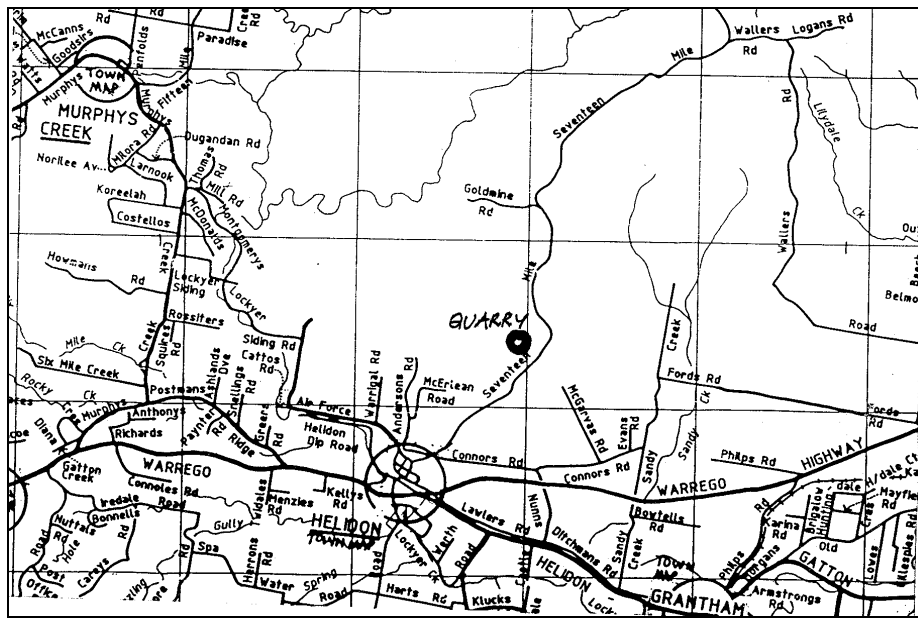

NOTE: This report has been prepared on the basis of evidence examined by the study team and seeks to identify the most important heritage values of the item. The purpose of this report is to provide an initial evaluation. If any action is planned which might affect the cultural heritage significance of this place, advice should be sought through the Gatton Shire Council Planning Branch.

NAME	Comerford Sandstone
CATEGORY	Industry - sandstone quarries
LOCATION	Airforce Road, Helidon
RPD	Heritage boundary to be determined
LISTING BOUNDARY	Heritage boundary to be determined Working sections excluded
OTHER LISTINGS	-
SIGNIFICANCE LEVEL	Local

History:

The State Government purchased the former Millers Quarry in 1923 to obtain white stone for the completion of the Treasury Building. Over the next few years, buildings which used stone from this source included: General Hospital No 2 Block; Anzac Square Memorial; Bank of Australasia; Bank of New South Wales; Commonwealth banks in Queen and George Streets; St Mary's Church Ipswich

In 1931, the quarry and plant were sold to J.T. Neville and Sons but were repossessed in 1933 owing to Neville's failure to complete his contract and a caretaker was installed. In 1939, the quarry and plant were taken over by P.J. Lowther and Sons who had secured the contract to supply stone for the University of Queensland.

The workings known as Jude's Quarry remain virtually unchanged near the existing office building. A very white freestone is obtained from this site and it was used to provide stone for the second wing of the Treasury Building, facing George St and the eastern part of Elizabeth St.

Description: Large sandstone quarry, still in use. A smaller area known as Jude's Quarry is no longer used and still shows signs of handworking.

The buildings and structures on site include:
 an office and show room
 modern sheds
 an older shed which was once a blacksmiths'
 a former factory building - an open-sided timber framed building removed from a nearby site
 a disused crane

Significance:

This is an important example of a freestone quarry.

The place demonstrates the progression of technology associated with stone quarrying over the past 100 years and still retains examples of early equipment including a steam crane. It has the potential to yield information which will contribute to an understanding of quarrying methods.

As one of a group of quarries in this area, it was important to the local economy and is associated with the growth and development of townships in Gatton Shire.

The place is associated with construction of many important Queensland buildings and hence with the development and aesthetics of Queensland cities.

Associated Items:

Other quarries in this locality

NOTE: This report has been prepared on the basis of evidence examined by the study team and seeks to identify the most important heritage values of the item. The purpose of this report is to provide an initial evaluation. If any action is planned which might affect the cultural heritage significance of this place, advice should be sought through the Gatton Shire Council Planning Branch.

References:

QSA Bundle E154 letters dated 1.12.1934, 21.10.1933 and 16.5.1939

K.W. Wolfe Queensland Building and Monumental Stones

Information from Mrs Libbie Comerford

Comments:

This is an operational industrial site. It is recommended that Gatton Shire Council hold discussions with this quarry and with other local quarries to see if they can mutually agree areas which can be conserved. A heritage boundary should be established within the overall site.



NOTE: This report has been prepared on the basis of evidence examined by the study team and seeks to identify the most important heritage values of the item. The purpose of this report is to provide an initial evaluation. If any action is planned which might affect the cultural heritage significance of this place, advice should be sought through the Gatton Shire Council Planning Branch.



Jude's Quarry

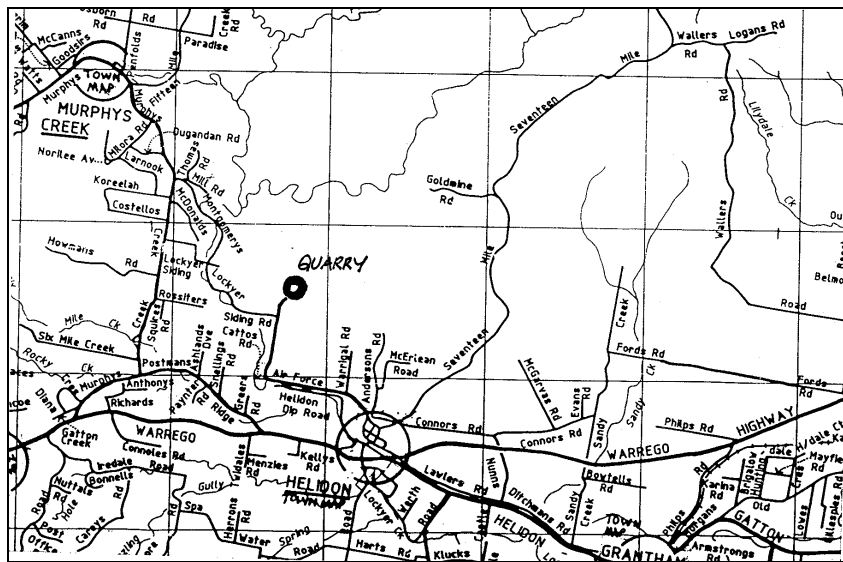

NOTE: This report has been prepared on the basis of evidence examined by the study team and seeks to identify the most important heritage values of the item. The purpose of this report is to provide an initial evaluation. If any action is planned which might affect the cultural heritage significance of this place, advice should be sought through the Gatton Shire Council Planning Branch.



Transporting sandstone by bullock team (photos courtesy Comerford's Quarry)



NOTE: This report has been prepared on the basis of evidence examined by the study team and seeks to identify the most important heritage values of the item. The purpose of this report is to provide an initial evaluation. If any action is planned which might affect the cultural heritage significance of this place, advice should be sought through the Gatton Shire Council Planning Branch.

NAME	Australian Sandstone Industries
CATEGORY	Industry - sandstone quarries
LOCATION	Helidon
RPD	Heritage boundary to be determined
LISTING BOUNDARY	Heritage boundary to be determined Working sections excluded
OTHER LISTINGS	-
SIGNIFICANCE LEVEL	Local

History: Robert Montgomery and his wife Jane opened a quarry near Murphy's Creek in 1864. By 1888, they were associated with McLachlan and Sheddon in a new quarry in "Harley's Paddock" about 1½ miles from Murphy's Creek. The quarry supplied stone for the first stage of the Treasury Building. By 1920, Montgomery was concentrating on a monumental masonry business at Murphy's Creek but some stone was still supplied.

In 1991, the quarry was purchased by Australian Sandstone Industries.

Description: Sandstone quarry with a recent office building. Early equipment remains on site and there is one area no longer used which shows evidence of handworking.

Significance:

The place demonstrates the progression of technology associated with stone quarrying over the past 100 years. It has the potential to yield information which will contribute to an understanding of quarrying methods.

As one of a group of quarries in this area, it was important to the local economy and is associated with the growth and development of townships in Gatton Shire.

The place is associated with construction of many important Queensland buildings and hence with the development and aesthetics of Queensland cities.

Associated Items:

References:

K.W. Wolfe *Queensland Building and Monumental Stones*

Helen Bennett *Gatton Shire Thematic Historical Overview* Cultural Heritage Branch EPA 1999

Comments:

This is an operational industrial site. It is recommended that Gatton Shire Council hold discussions with this quarry and with other local quarries to see if they can mutually agree areas which can be conserved. A heritage boundary should be established within the overall site.

NOTE: This report has been prepared on the basis of evidence examined by the study team and seeks to identify the most important heritage values of the item. The purpose of this report is to provide an initial evaluation. If any action is planned which might affect the cultural heritage significance of this place, advice should be sought through the Gatton Shire Council Planning Branch.



NOTE: This report has been prepared on the basis of evidence examined by the study team and seeks to identify the most important heritage values of the item. The purpose of this report is to provide an initial evaluation. If any action is planned which might affect the cultural heritage significance of this place, advice should be sought through the Gatton Shire Council Planning Branch.